



# INSTALLATION INSTRUCTIONS

Accessory  
**REMOTE ENGINE  
START SYSTEM**  
P/N 72147-T6Z-A11

Application  
**2017 RIDGELINE RT**

Publications No.  
**VERSION 1**  
Issue Date  
**JULY 2016**

**NOTE:** For additional technical information, refer to the vehicle service manual.

## PARTS LIST

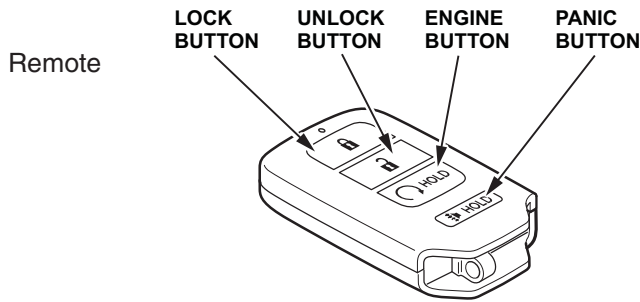

## TOOLS AND SUPPLIES REQUIRED

i-HDS/DTS-I

## INSTALLATION

### ENGINE REMOTE START SYSTEM REGISTRATION

NOTE: The PCM code will be required for this procedure.

1. Connect the i-HDS to the data link connector.
2. From the **System Selection Menu**, select **ONE-PUSH START**, then go to **Registration**.

**NOTICE:** Do not enter the **2-WAY KEYLESS SETUP menu**. Performing this operation will damage the Keyless Access Control Unit.

3. Select **KEYLESS ACCESS Remotes**, then **Add a KEYLESS ACCESS Remote** and follow the i-HDS prompts.
4. Repeat step 3 for any additional Remote Starter remote.
5. After registration, verify all remote-related systems work normally with all remotes.

### REMOTE ENGINE START

1. Press LOCK, then press and hold ENGINE. The amber LED blinks, and the green LED stays solid for one second when the engine starts. You can repeat this once at any time within 10 minutes of the initial remote start for a 10-minute extension.
2. While remote engine start is on:
  - The climate control system can warm or cool the interior, depending on the ambient temperature.
  - The security system remains on.
  - Exterior lights and accessories remain off.
3. To start driving after you enter the vehicle, depress the brake pedal and press ENGINE/START/STOP.

### STOPPING THE ENGINE

Press and hold ENGINE. The red LED stays solid for one second.

NOTE: The engine will stop if it has been running for more than 10 minutes or any door is opened without using the remote or keyless access.

For additional technical information, refer to the vehicle owner's manual.