



# INSTALLATION INSTRUCTIONS

Accessory  
**REMOTE CONTROL ENGINE STARTER**

Application  
**2017 HR-V**  
(EX and EXL Only)

Publications No.  
**VERSION 1**  
Issue Date  
**SEP 2016**

## PARTS LIST

Remote Engine Starter Unit Kit  
P/N 08E91-T2A-100

Transmitter



Control unit



Antenna



ID label



## Remote Control Engine Starter Attachment Kit P/N 08E92-T7S-100A

Engine starter harness

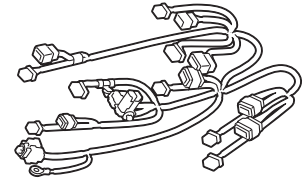

Control unit bracket



3 Relays



22 Wire ties



3 Long wire ties



Ground bolt



Aluminum tape

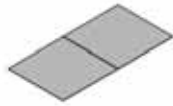

9 Urethane tapes



Caution label

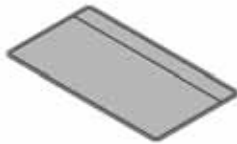

Fuse label



Clip



Accessory User's Information Manual



Quick Start Guide



## TOOLS AND SUPPLIES REQUIRED

Phillips screwdriver

Flat-tip screwdriver

Diagonal cutters

Ratchet

10 mm Socket

10 mm Open end wrench

Isopropyl alcohol

Scissors

Shop towel

Ruler

HDS/MVCI

Masking tape

Tape

*The following tools are available through the Honda Tool and Equipment Program. On the iN, click on: Service > Service Bay > Tool and Equipment Program, then enter the number under "Search". Or, call 888-424-6857.*

- Trim Tool Set (T/N SOJATP2014)
- Plastic Trim Tool (T/N SILTRIMTL10)

### **Illustration of the Remote Control Engine Starter Installed in the Vehicle**

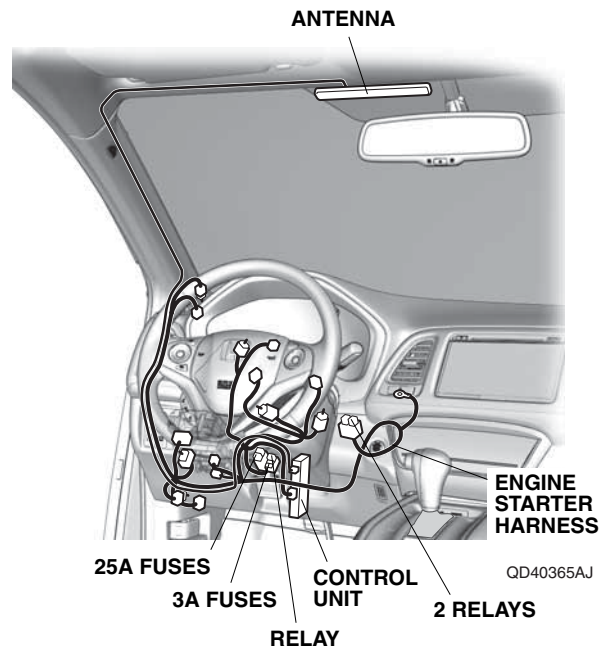

## INSTALLATION

**Customer Information:** The information in this installation instruction is intended for use only by skilled technicians who have the proper tools, equipment, and training to correctly and safely add equipment to your vehicle. These procedures should not be attempted by “do-it-yourselfers.”

**NOTE:** The antenna should only be installed if the ambient air temperature is 15°C (60°F) or above.

1. Disconnect the negative cable from the battery.
2. Attach the ID label.
  - Using isopropyl alcohol on a shop towel, clean the transmitter where the ID label will attach.
  - Attach the ID label to the transmitter in the area shown.

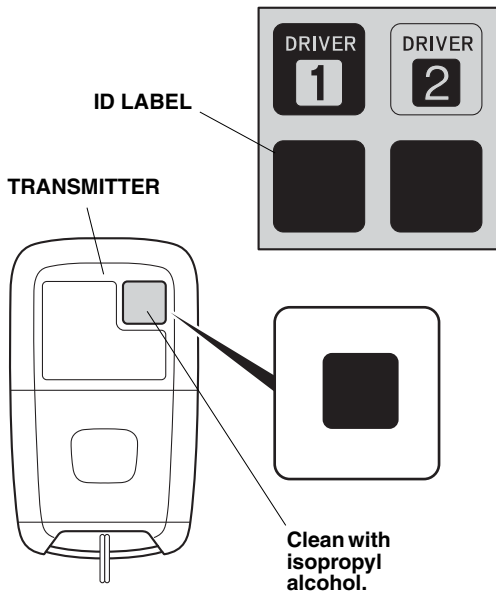

QBD0601AE

3. Remove the driver's sunvisor and unplug the vehicle connector:
  - Pivot the driver's sunvisor downward.
  - Wrap tape around the tip of flat-tip screwdriver.
  - Locate the slot in the base cover, and insert the flat-tip screwdriver into the slot. Push in and hold the retaining tab.
  - While holding the retaining tab, push up on the sunvisor and rotate it toward the door.

**NOTE:** If the retaining tab does not stay pushed in, return the sunvisor to its original position and repeat this step.

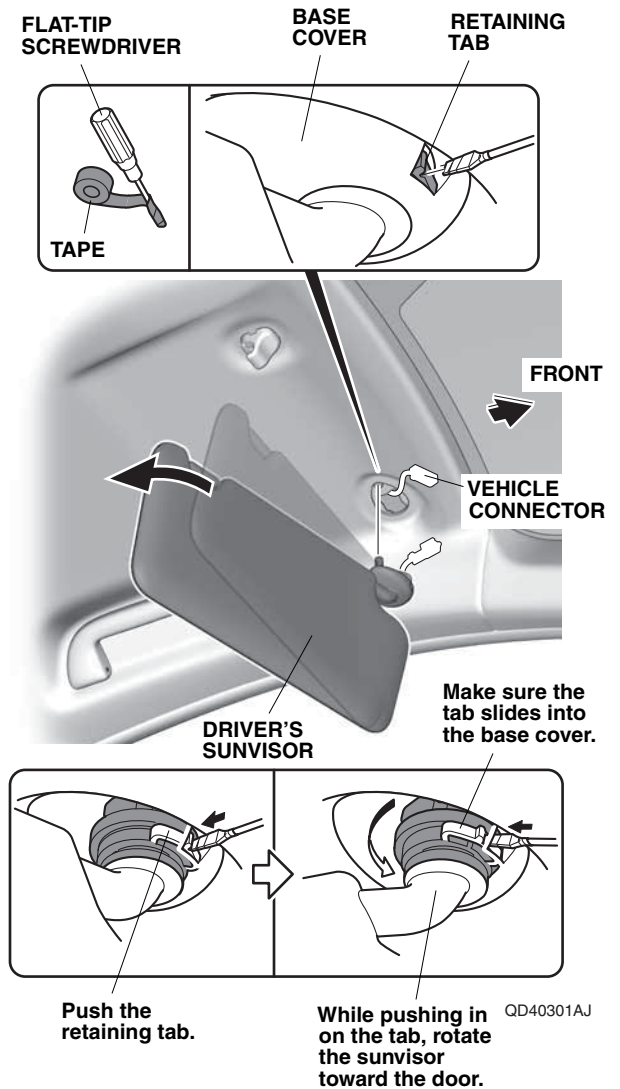

4. Remove the driver's sunvisor holder:
  - Wrap tape around the tip of flat-tip screwdriver.
  - Release three retaining tabs on the driver's sunvisor holder.

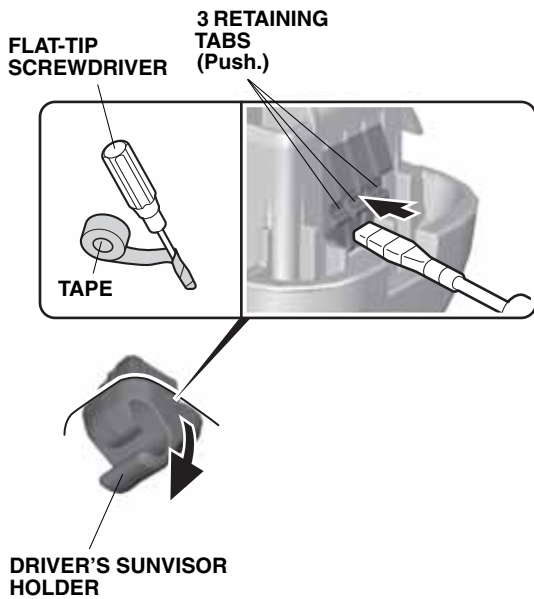

QC22003BJ

- While pulling down on the driver's sunvisor holder as shown, use a flat-tip screwdriver wrapped with a tape to remove the driver's sunvisor holder.

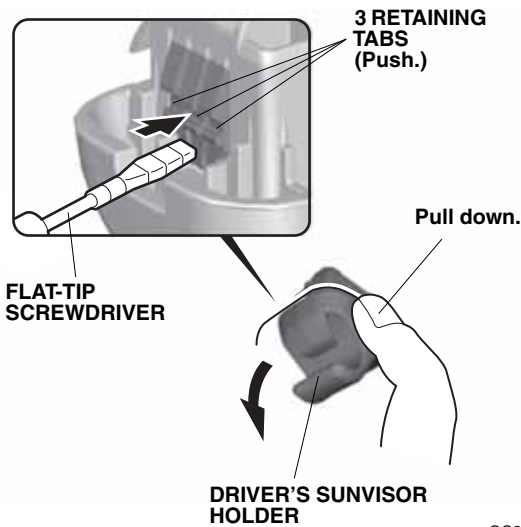

QC22004AJ

5. Remove the driver's A-pillar trim.
  - Pull away the door opening seal from the driver's A-pillar trim.
  - Pull out on the driver's A-pillar trim to release the three clips.

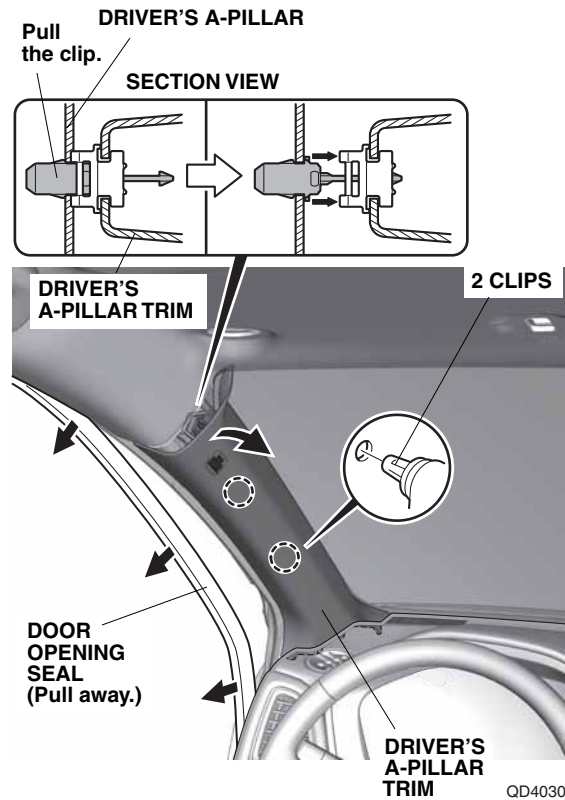

QD40302BJ

- To prevent clips from falling into the body panel area, carefully insert a shop towel between the driver's A-pillar and the driver's A-pillar trim.

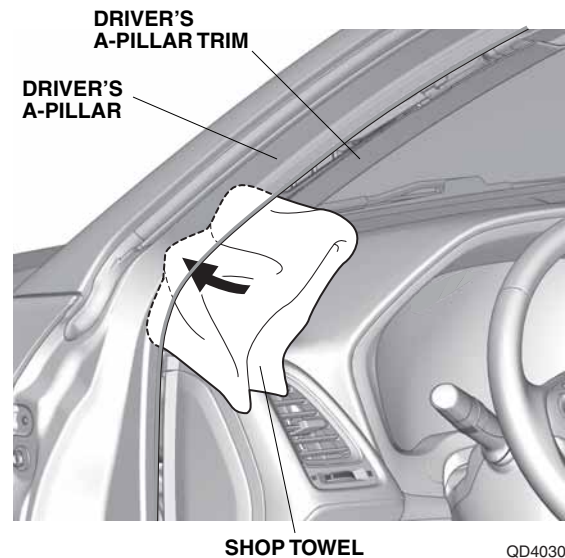

QD40303BJ

- Slide the driver's A-pillar trim upward, and remove the driver's A-pillar trim.
- Remove the shop towel and any clips.

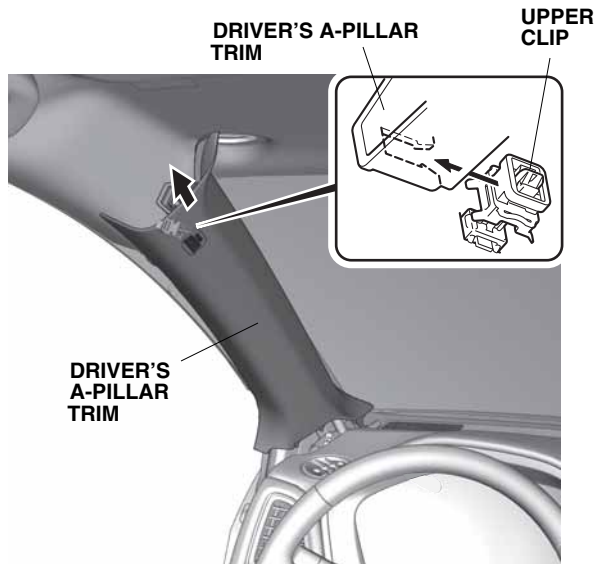

QD40304BJ

6. Remove the remaining upper clip from the driver's A-pillar.

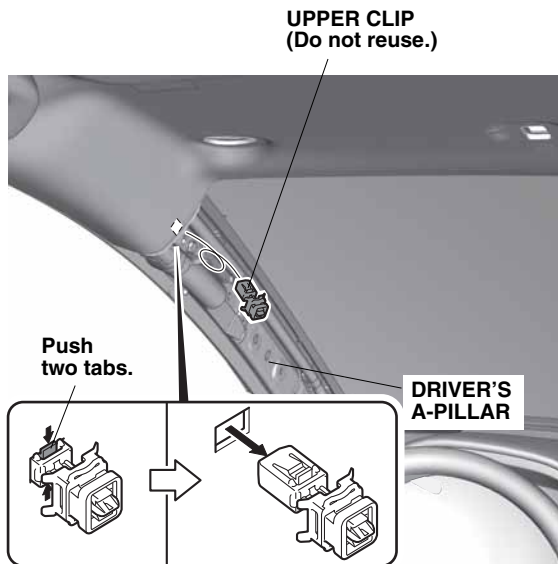

QD40305BJ

7. Install the new clip (supplied) to the driver's A-pillar trim.

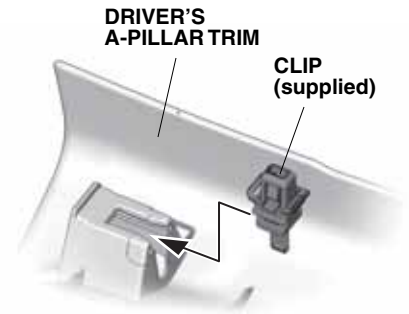

QC72508AJ

8. Lower the steering wheel. Attach tape to the upper column cover, dashboard, combination light switch, and wiper switch as shown.

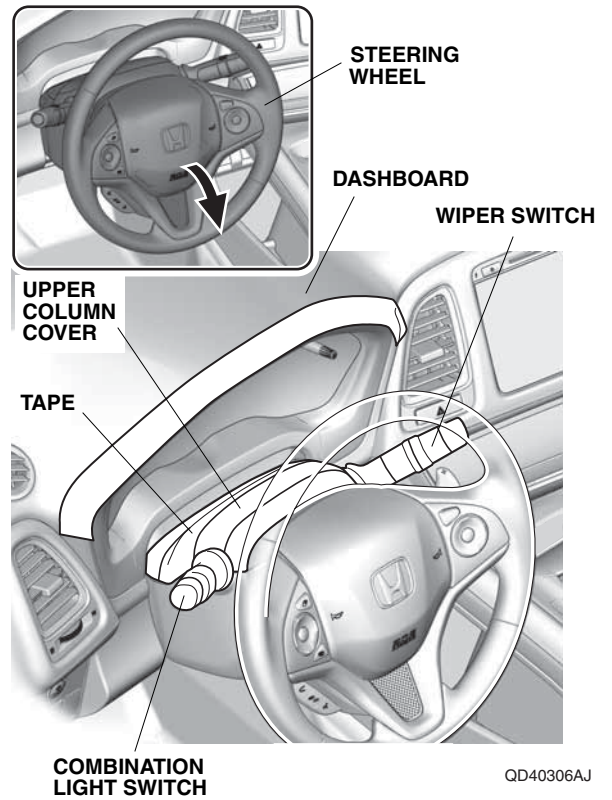

QD40306AJ

9. Remove the meter visor.

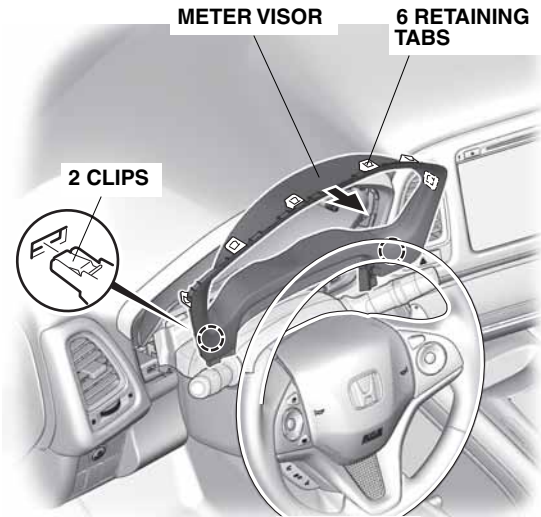

QD40307AJ

10. Remove the select/reset knob, and pull out the meter.

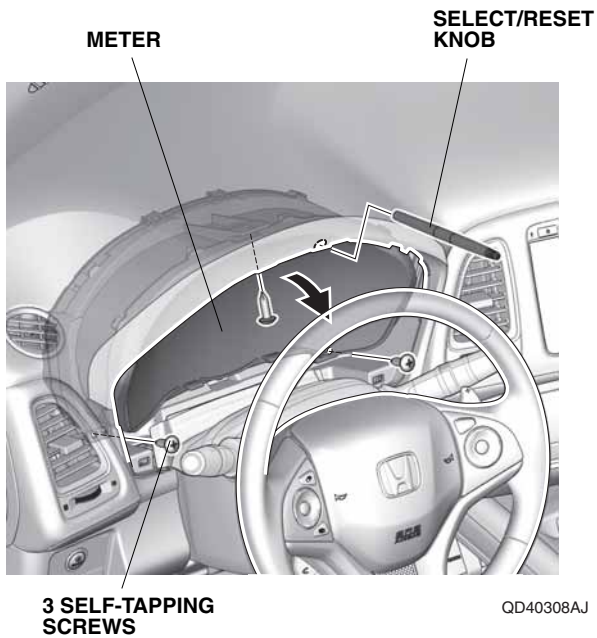

QD40308AJ

11. Remove the meter and unplug the vehicle connector. NOTE: Do not leave the meter with the dial window down.

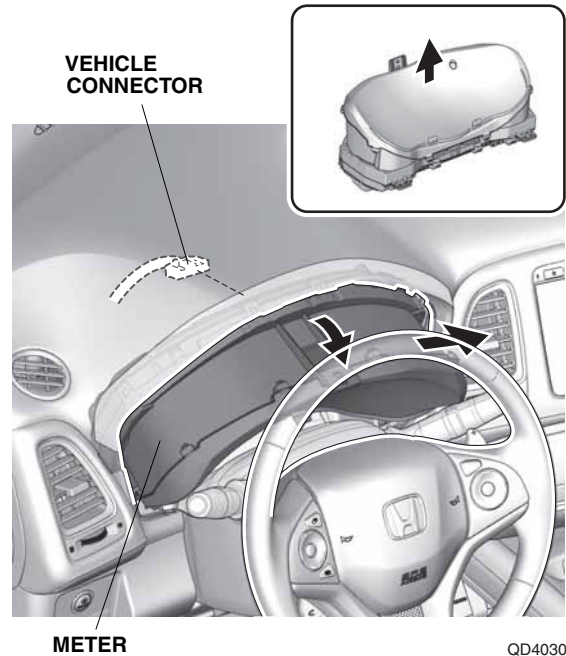

QD40309AJ

12. Turn the steering wheel 90° clockwise. Using a plastic trim tool, release the retaining tab.

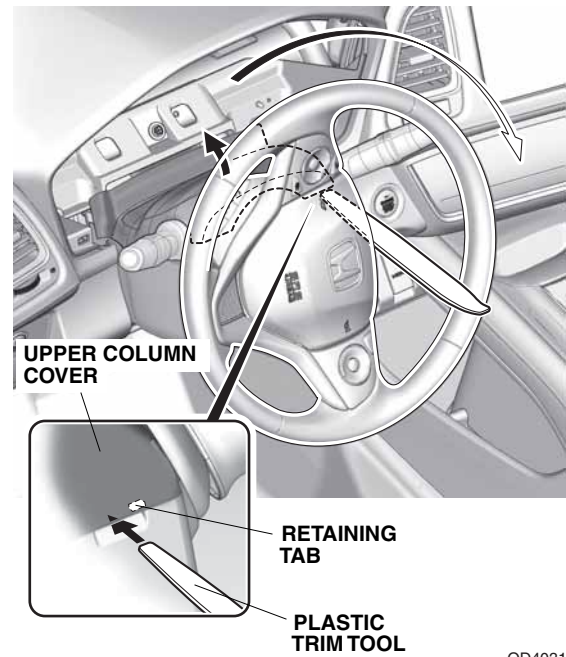

QD40310AJ

- Turn the steering wheel 180° counterclockwise. Using a plastic trim tool, release the retaining tab.

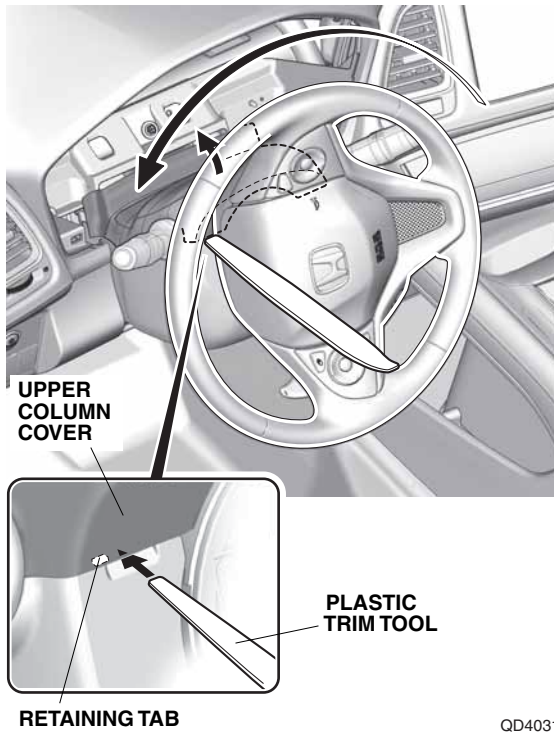

- Remove the upper column cover.

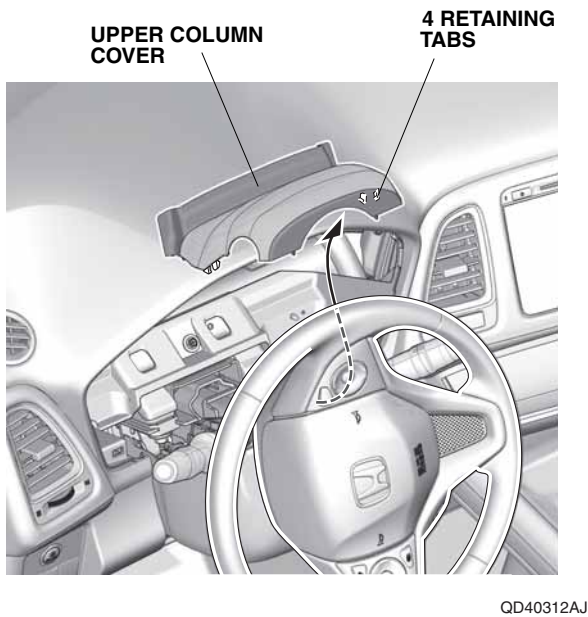

- Remove the one self-tapping screw from the lower column cover.



- Turn the steering wheel 180° clockwise, and remove the one self-tapping screw from the lower column cover.

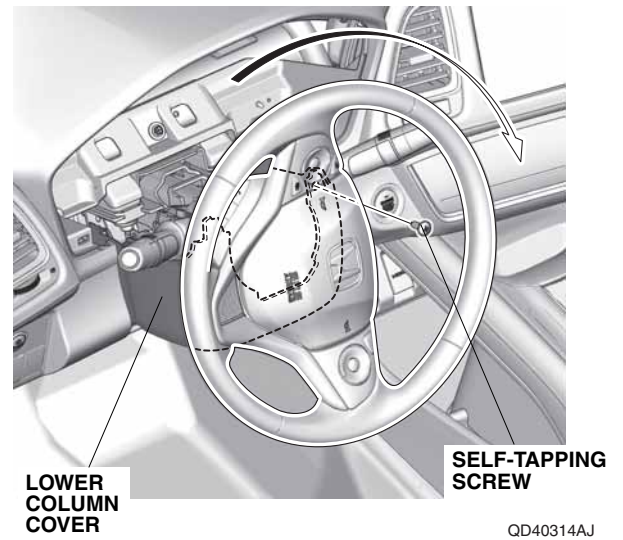

17. Pull away the door opening seal, and remove the driver's dashboard side lid.

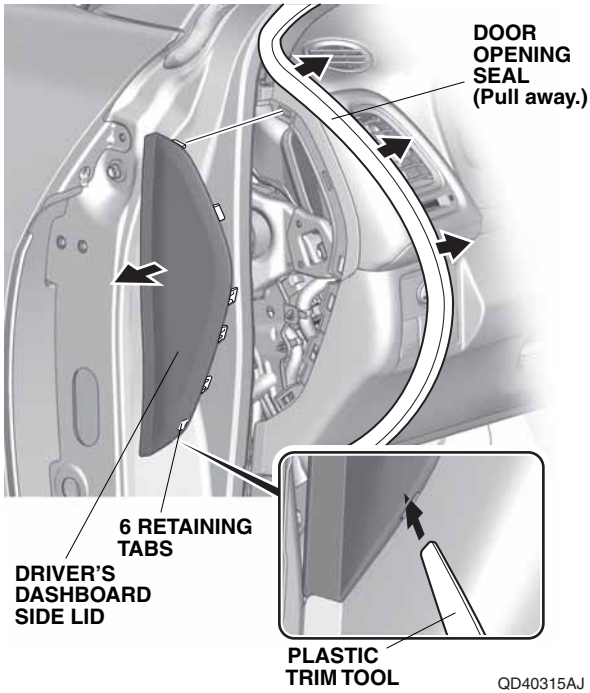

18. Attach tape to the lower column cover.

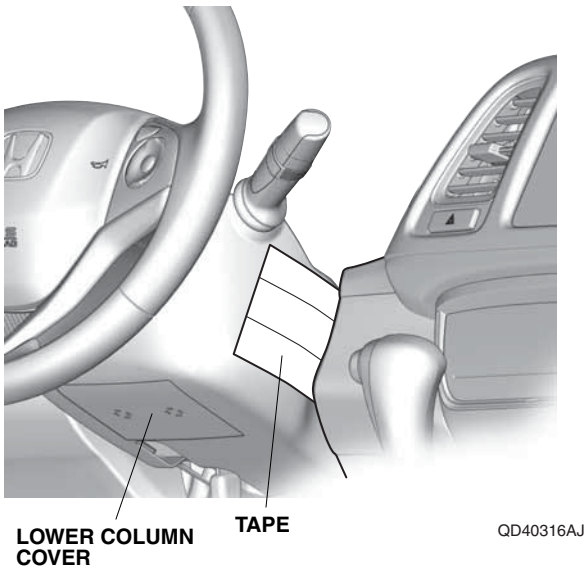

19. Pull away the door opening seal, and remove the driver's dashboard lower cover and unplug the vehicle connectors.

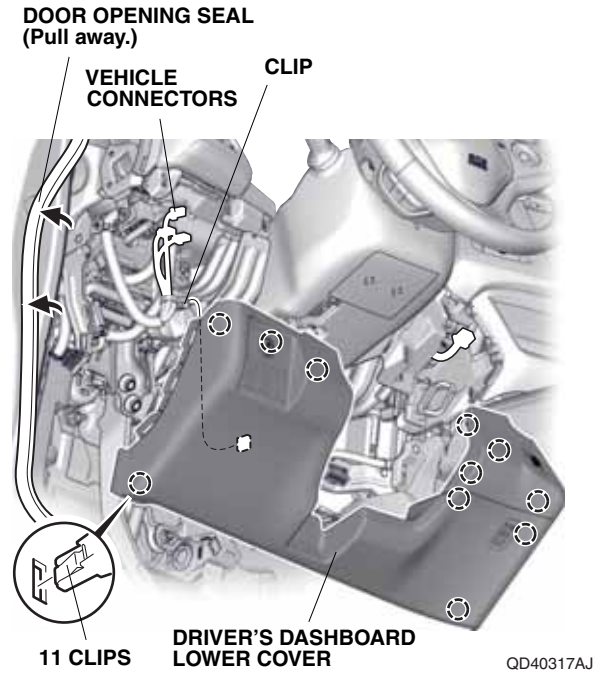

20. Remove the lower column cover.

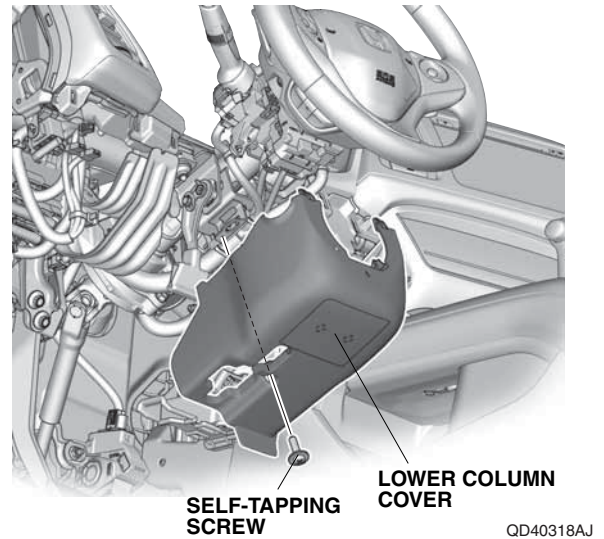



- Pull away the door opening seal, and remove the driver's front door sill trim.

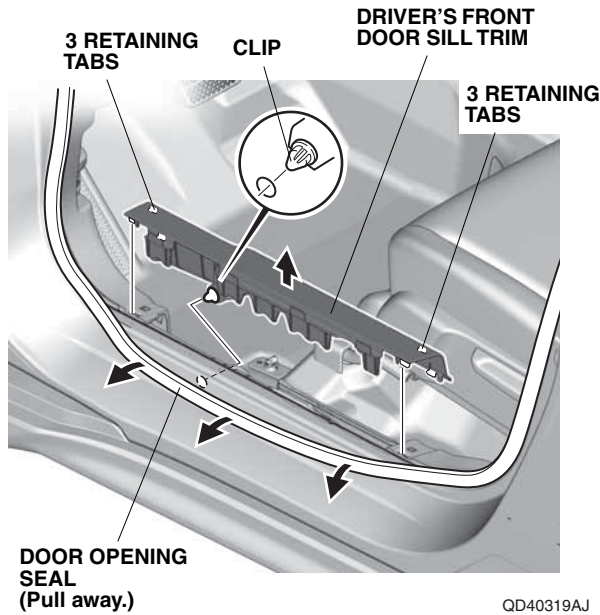

- Pull away the door opening seal, and remove the driver's kick panel.

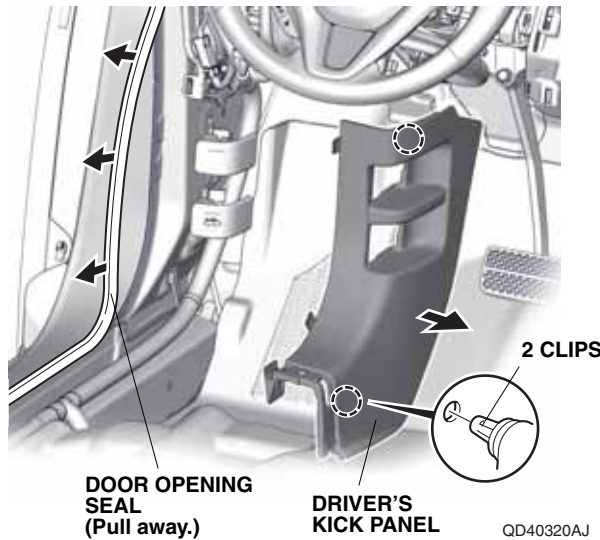

## Installing the Antenna

- Using scissors, cut one urethane tape in half. Wrap the two halves of urethane tape around the antenna cable as shown.  
NOTE: Do not fold the antenna cable.

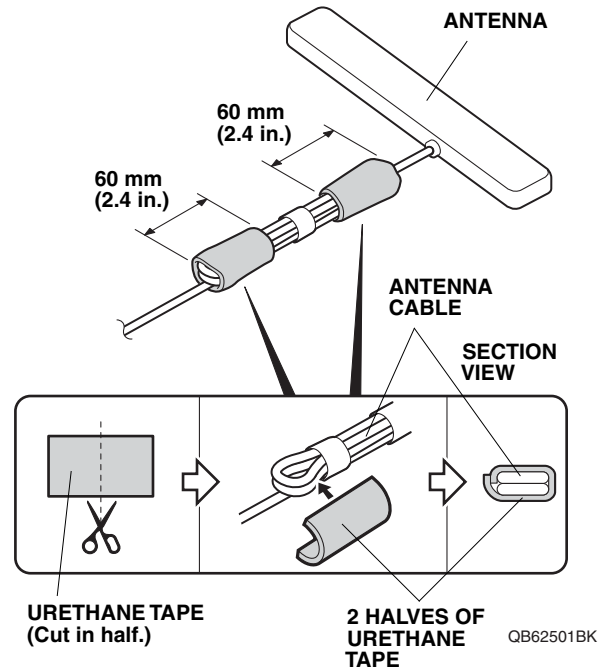

- Using scissors, cut one urethane tape in half. Wrap the two halves of urethane tape around the antenna cable at the measurement shown.

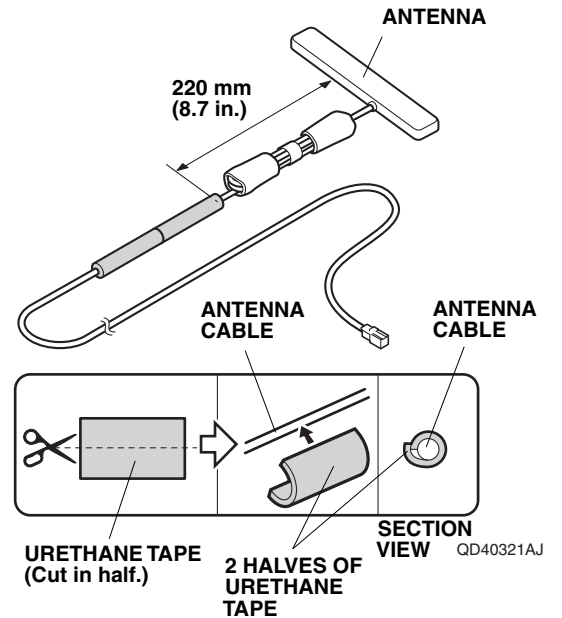

25. Attach the antenna.

- Attach masking tape to the windshield at the measurement shown.

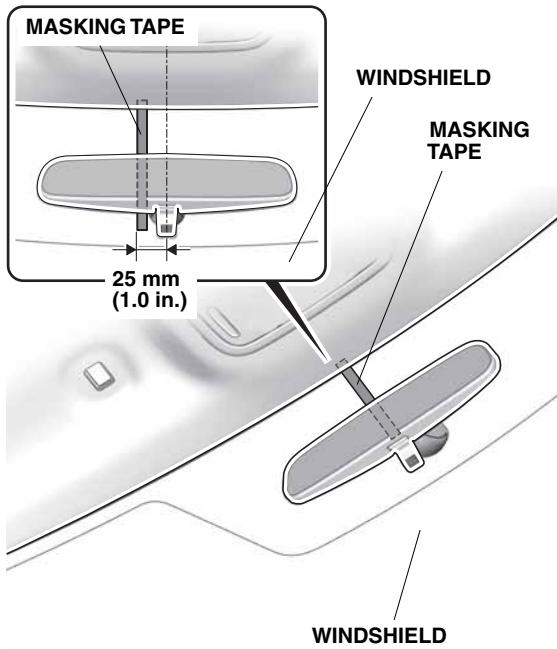

QD40322AJ

- Fold the adhesive backing of the antenna as shown.

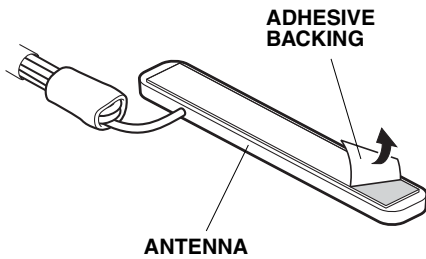

QB51401CH

- Using isopropyl alcohol on a shop towel, clean the windshield where the antenna will attach.
- Attach the antenna with masking tape. Adjust the position of the antenna so there is equal spacing on both sides.

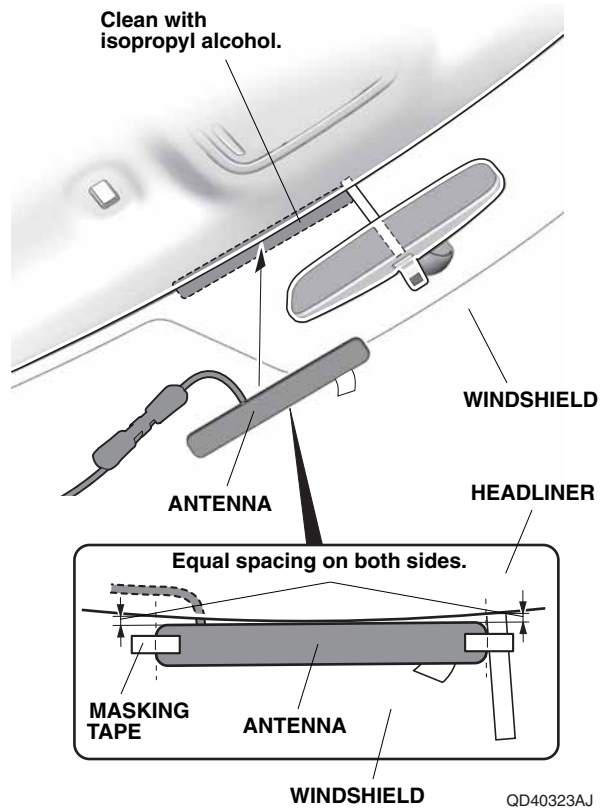

QD40323AJ

- Carefully remove the adhesive backing from the antenna, and attach the antenna to the windshield. Press and hold the antenna firmly in place for 30 seconds.
- Remove the masking tape.

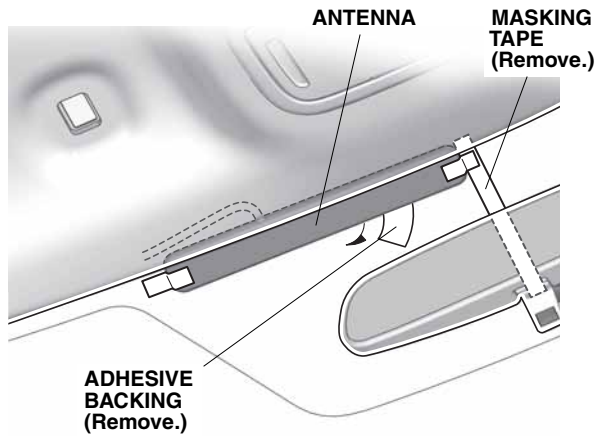

QD40324AJ

26. Gently pull down the headliner, and tuck the antenna cable behind the headliner. Be careful not to crease the headliner.

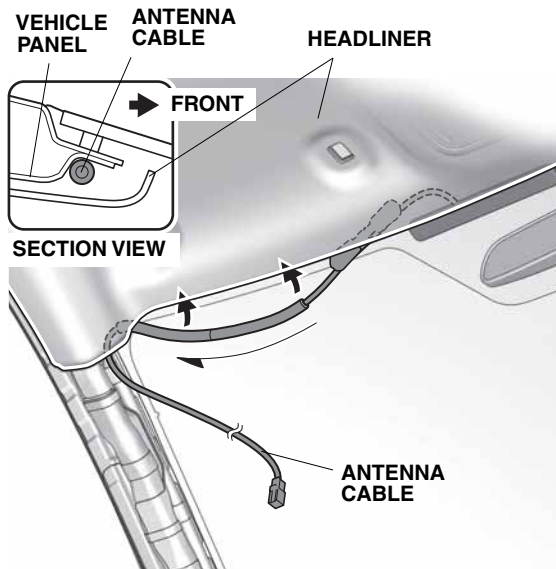

QD40325BJ

27. Route the antenna cable down the A-pillar as shown. Secure the antenna cable to the vehicle harness with three wire ties.

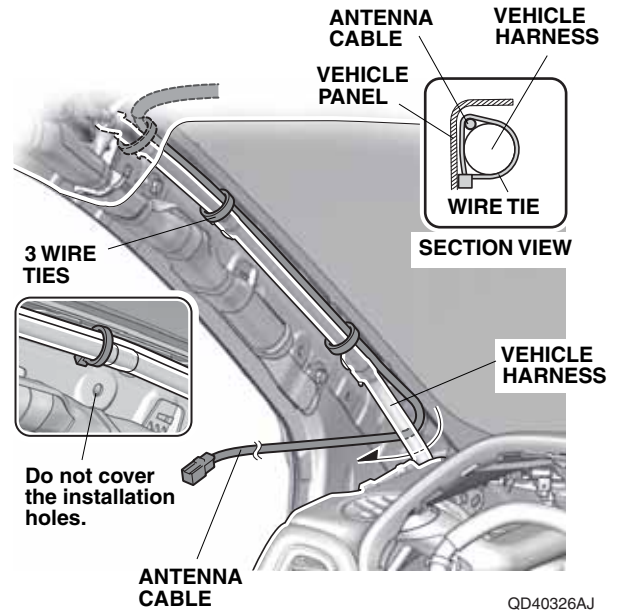

QD40326AJ

### Routing the Engine Starter Harness

28. Using isopropyl alcohol on a shop towel, clean the engine starter harness fuse block where the fuse labels will attach.

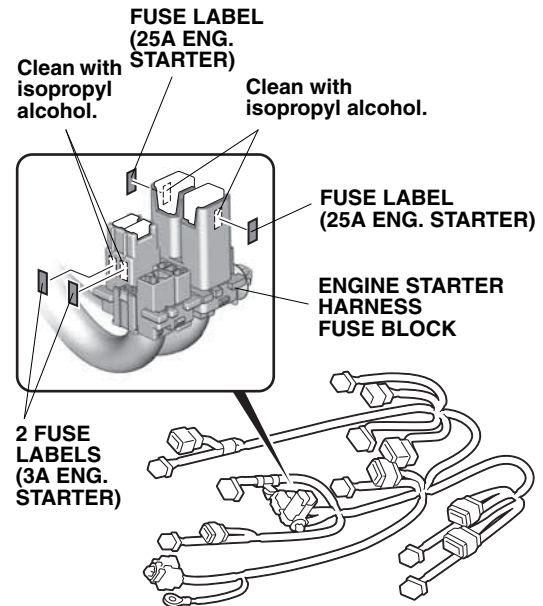

QD40327AJ

29. Attach the four fuse labels to the engine starter harness fuse block.

30. Install three relays to the engine starter harness relay block.

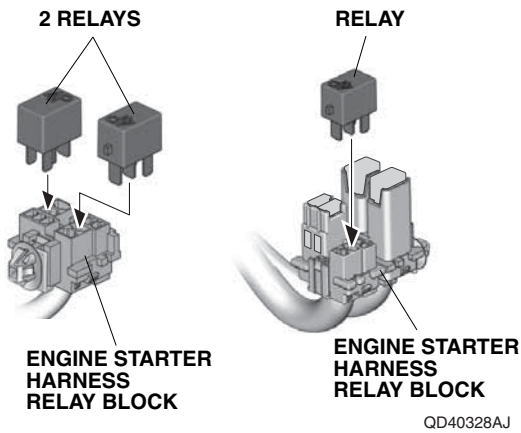

31. Using isopropyl alcohol on a shop towel, clean the driver's A-pillar where the urethane tape will attach.

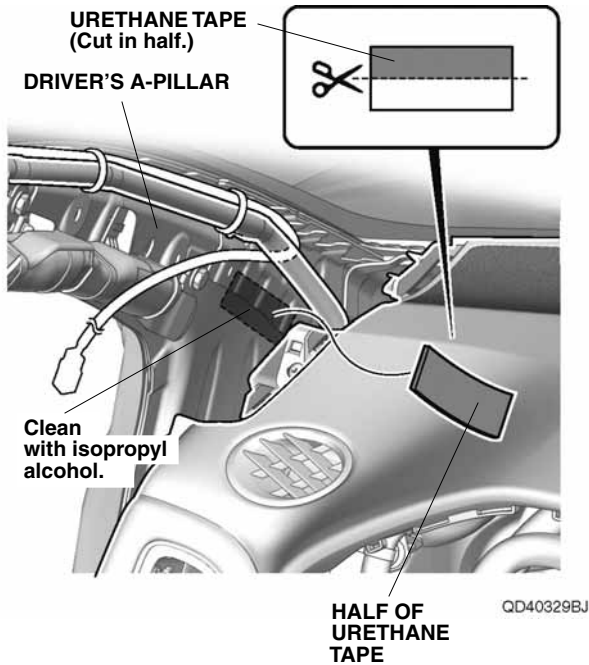

32. Using scissors, cut one urethane tape in half. Attach one half of urethane tape to the driver's A-pillar as shown.

33. Unplug the vehicle 25-pin connector, and plug it into the engine starter harness 25-pin connector. Plug the remaining engine starter harness 25-pin connector into the vehicle 25-pin connector.

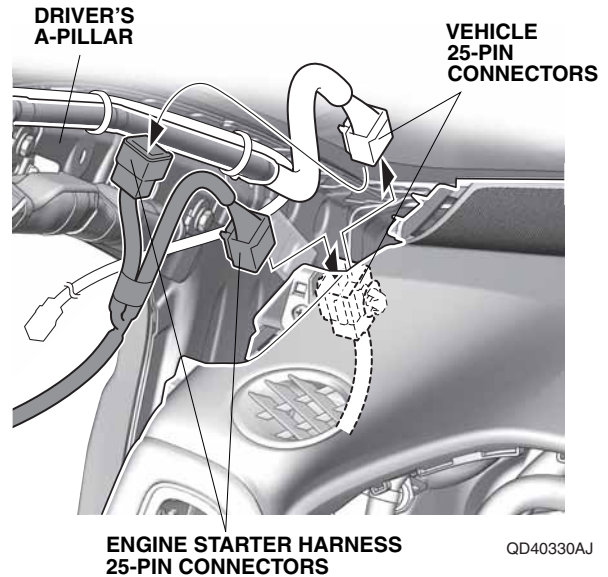

34. Secure the antenna cable, engine starter harness, and 25-pin connectors to the vehicle harness with one wire tie.

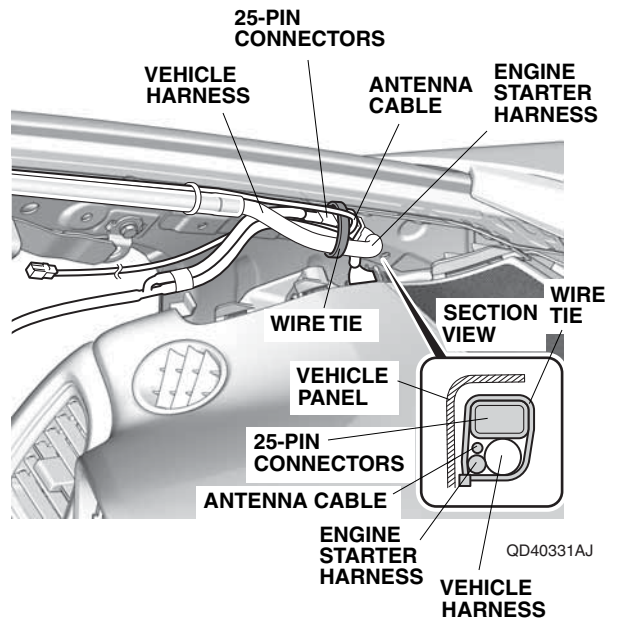

35. Wrap the remaining urethane tape from step 32 and one urethane tape around the antenna cable as shown.

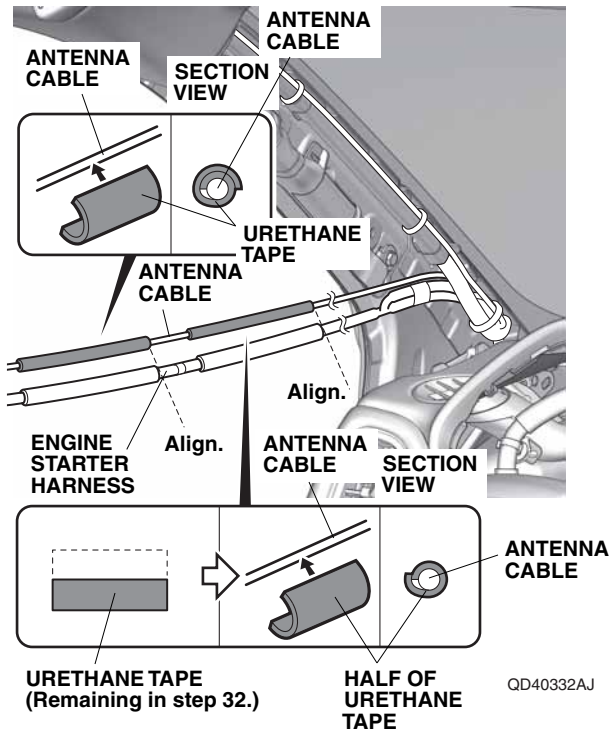

36. Pull away the door opening seal. Route the antenna cable and engine starter harness down next to the dashboard, and tuck the antenna cable and engine starter harness between the driver's A-pillar and the dashboard.

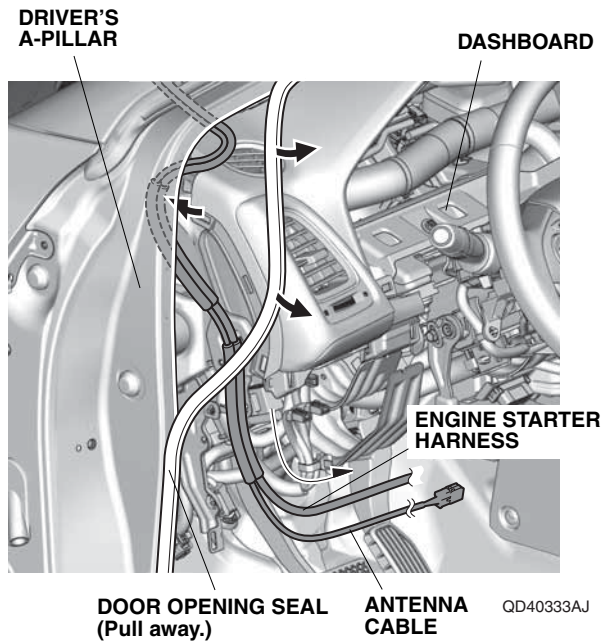

37. Align the white tape on the engine starter harness with the hole in the steering hanger beam, and secure the antenna cable and engine starter harness to the steering hanger beam and vehicle harness with two wire ties.

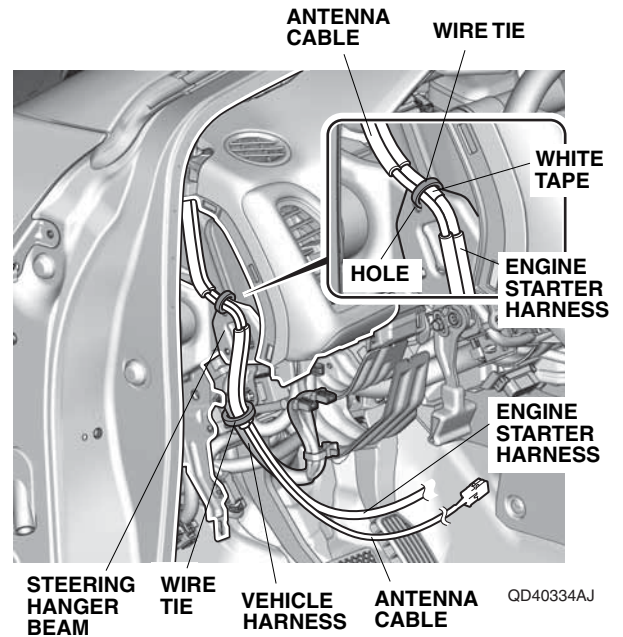

38. Using isopropyl alcohol on a shop towel, clean the driver's A-pillar where the aluminum tape will attach.

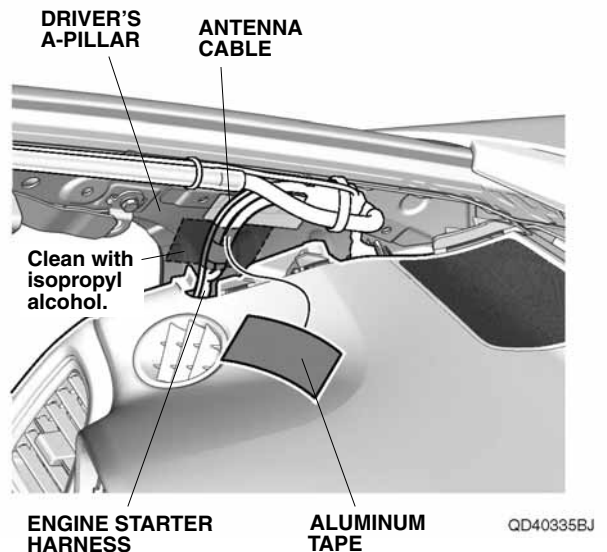

39. Attach the antenna cable and engine starter harness to the driver's A-pillar with one aluminum tape.

40. Using isopropyl alcohol on a shop towel, clean the knee bolster where the urethane tape will attach.

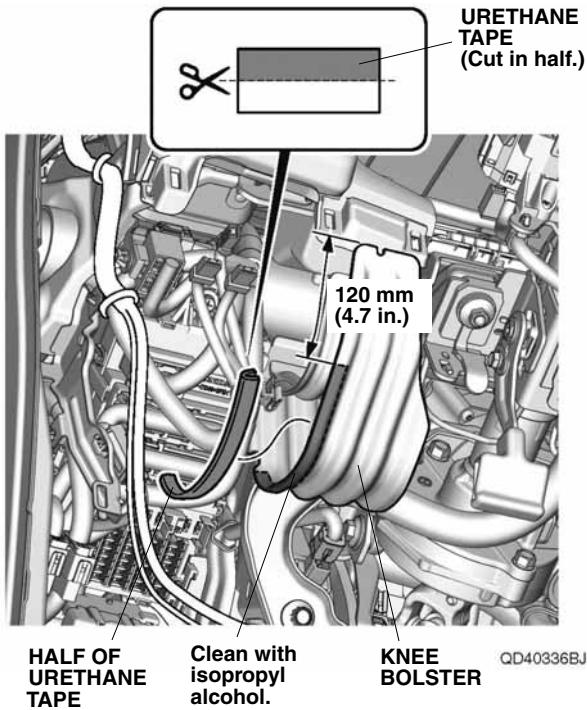

41. Using scissors, cut one urethane tape in half. Attach one half of urethane tape to the knee bolster at the measurement shown.
42. Using scissors, cut one urethane tape to the measurements shown. Wrap the cut urethane tape around the engine starter harness 5-pin connector.

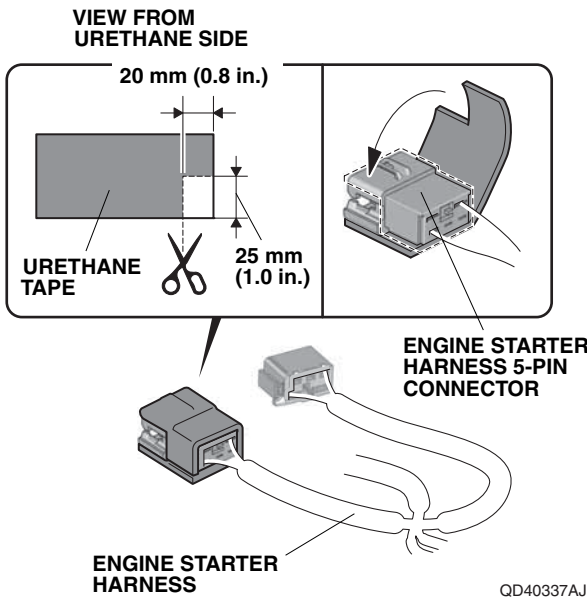

43. Unplug the vehicle 5-pin connector from the fuse box, and plug it into the engine starter harness 5-pin connector. Plug the remaining engine starter harness 5-pin connector into the fuse box.

**NOTICE:** Make sure the engine starter harness 5-pin connector is securely connected to the fuse box 5-pin connector. A loose connection can cause the engine to stall during driving.

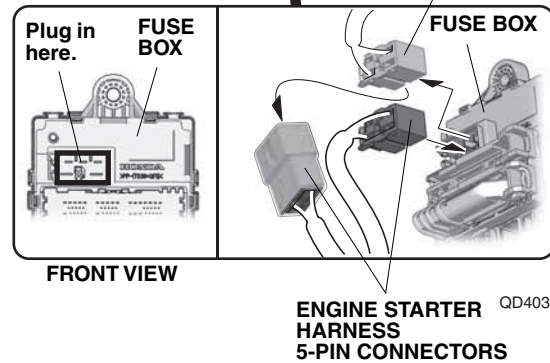
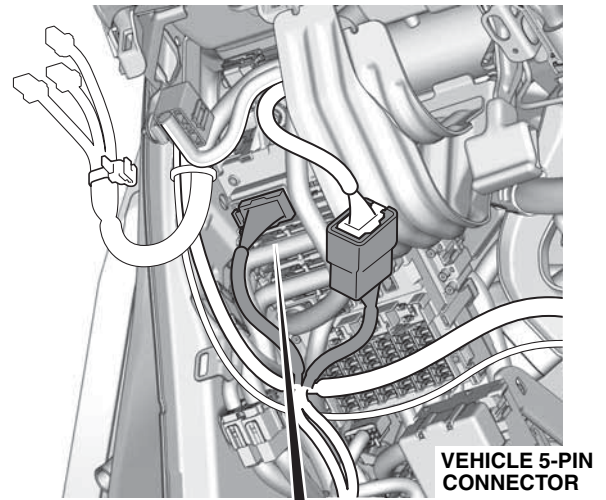
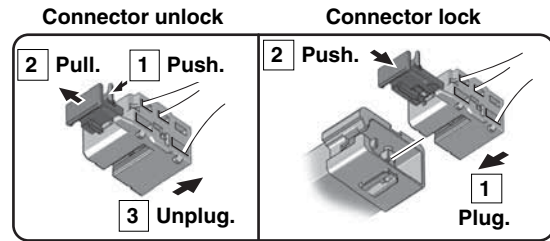

44. Secure the 5-pin connectors, antenna cable, and engine starter harness to the vehicle harness with one wire tie and one long wire tie.

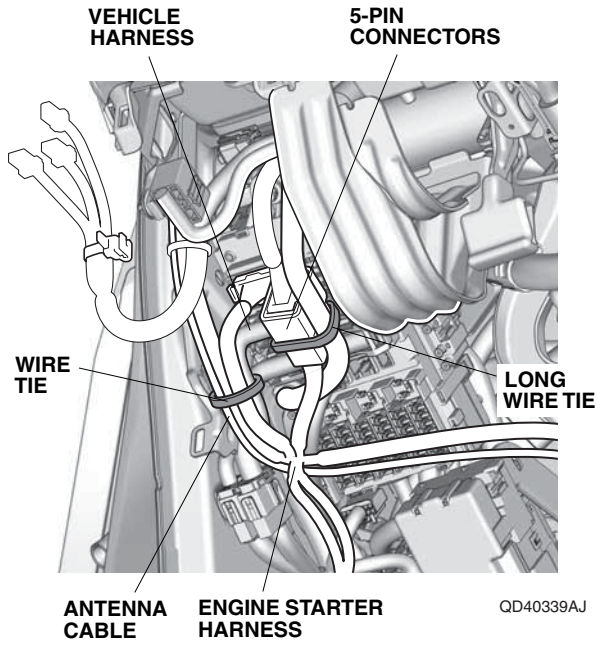

45. Release the subfuse box from the subfuse box bracket.

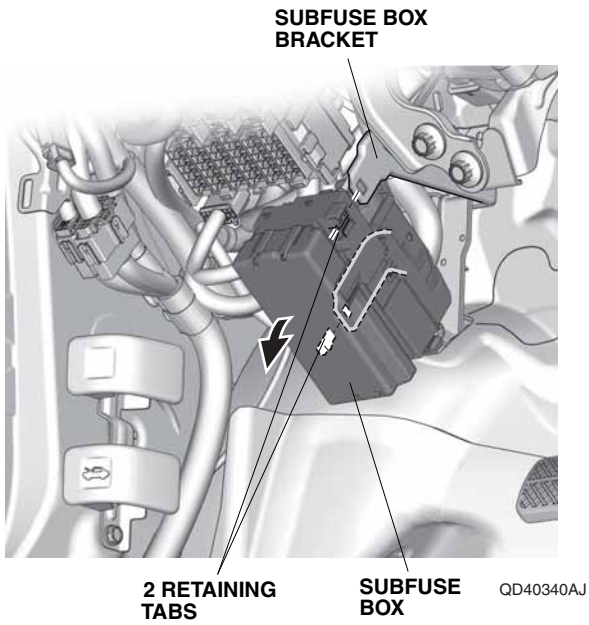

46. Remove the subfuse box bracket.

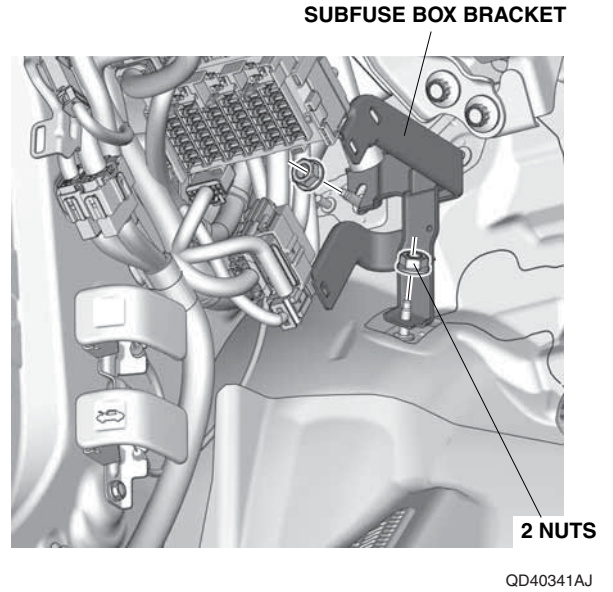

47. Route the engine starter harness as shown. Unplug the vehicle 2-pin connector from the subrelay box, and plug it into the engine starter harness 2-pin connector. Plug the remaining engine starter harness 2-pin connector into the subrelay box.

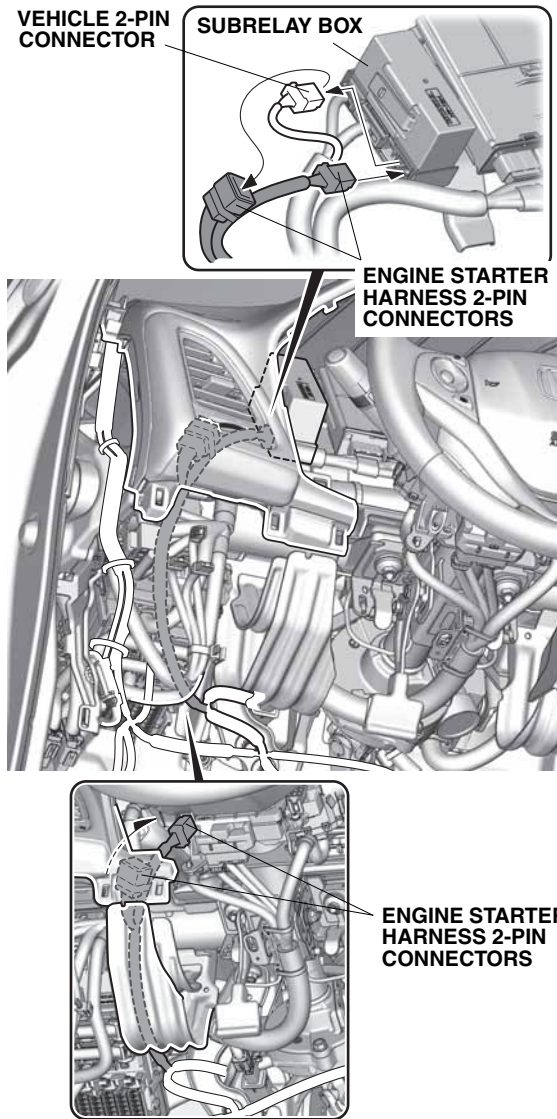

QD40342AJ

48. Secure the 2-pin connectors to the vehicle harness with one wire tie.

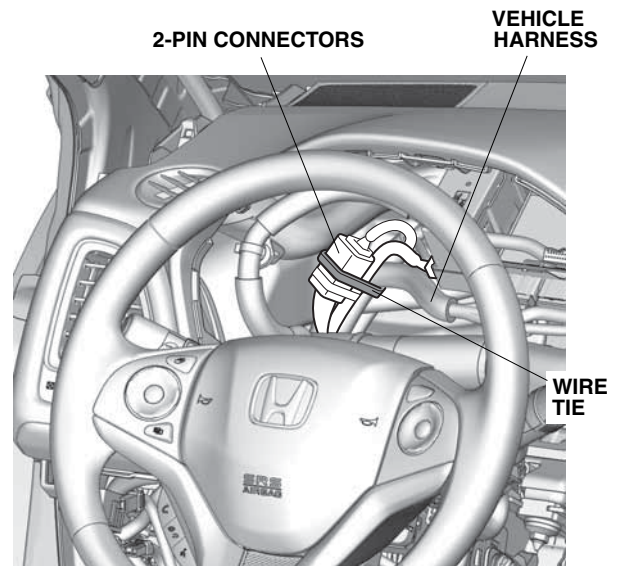

QD40343AJ

49. Secure the engine starter harness to the vehicle harness with one wire tie.

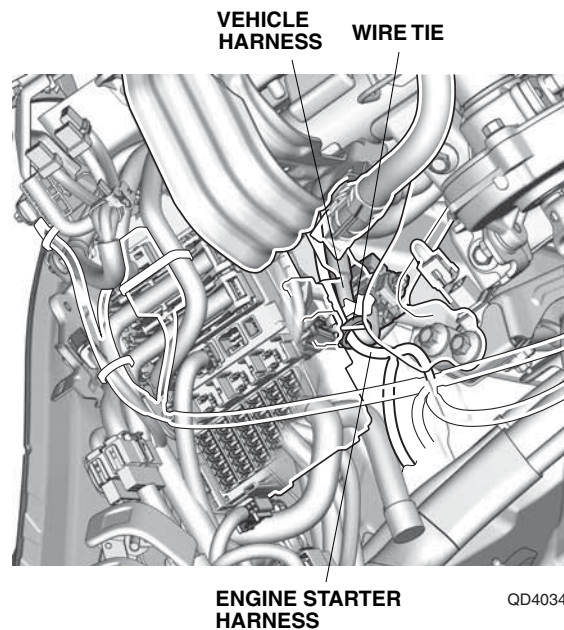

QD40344AJ



50. Plug the antenna cable connector and engine starter harness 28-pin connector into the control unit.

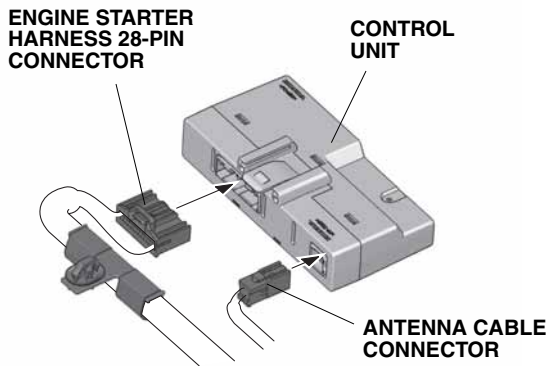

QD22202AJ

51. Using isopropyl alcohol on a shop towel, clean the control unit bracket where the urethane tape will attach.

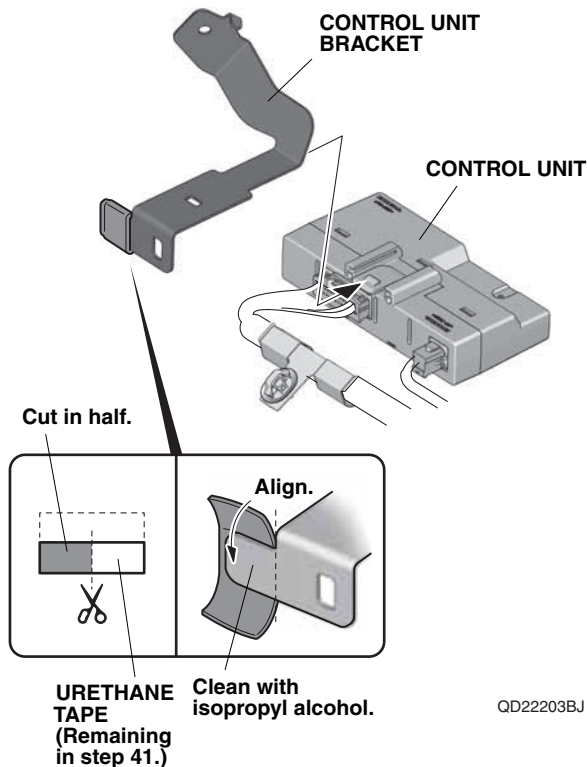

QD22203BJ

52. Using scissors, cut the remaining urethane tape from step 41 in half. Wrap the cut urethane tape around the control unit bracket as shown.
53. Install the control unit bracket to the control unit.

54. Attach the engine starter harness clip to the control unit bracket.

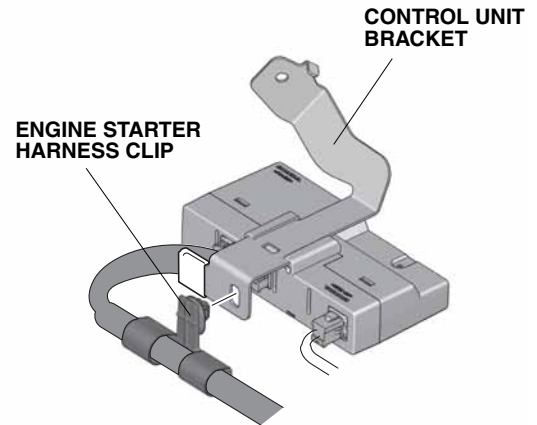

QD22204AJ

55. Secure the subfuse box bracket (removed in step 46) and control unit bracket to the studs with two nuts in the order shown.

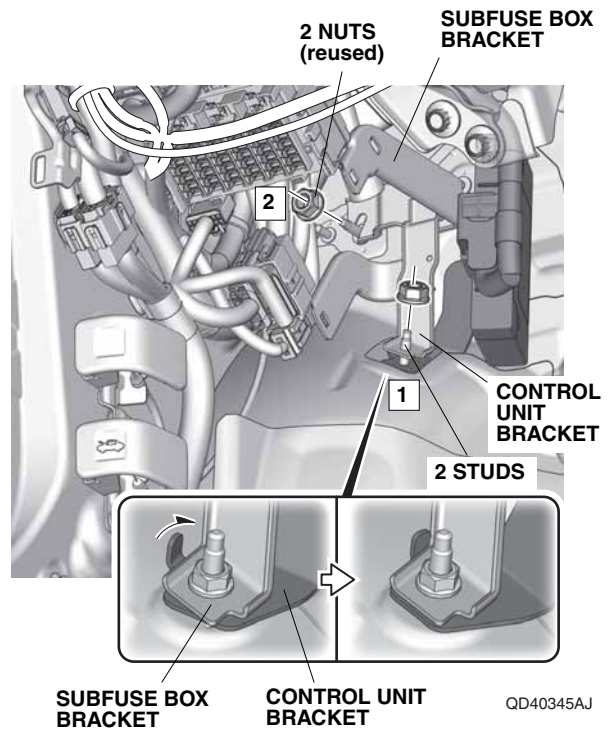

QD40345AJ

56. Install the subfuse box released in step 45.

57. Secure the engine starter harness fuse block to the hole in the subfuse box bracket.

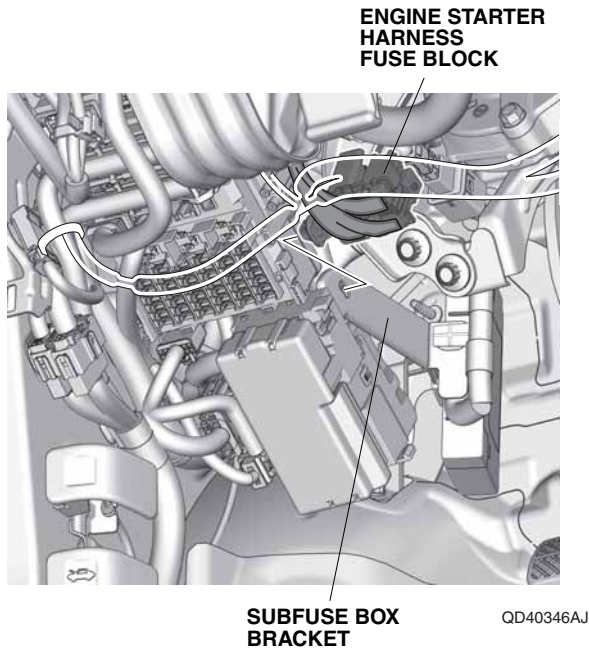

**Without Other Accessory Harness 4-pin Connector Plugged Into The Fuse Box.**

58. Plug the engine starter harness 4-pin connector into the fuse box. Go to step 60.

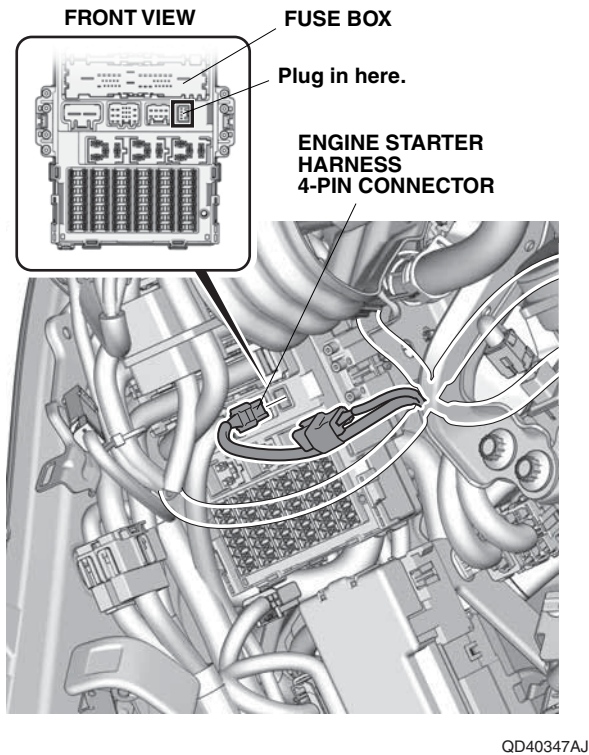

**With Other Accessory Harness 4-pin Connector Plugged Into The Fuse Box.**

59. If other accessory harness 4-pin connector is plugged into the fuse box, unplug the other accessory harness 4-pin connector from the fuse box, then plug the engine starter harness 4-pin connector into the fuse box. Plug other accessory harness 4-pin connector into the engine starter harness 4-pin connector.

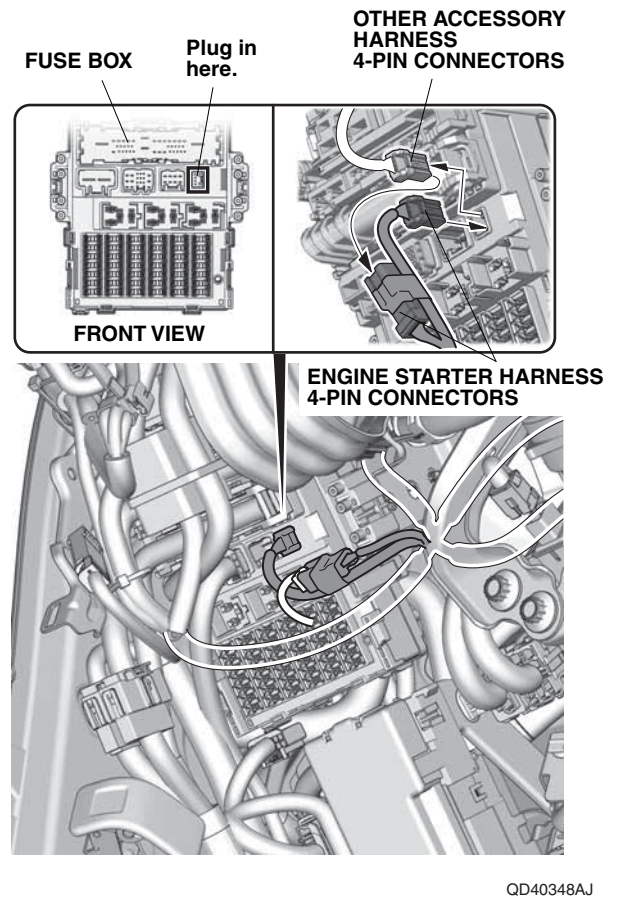

60. Unplug the vehicle 22-pin connector, and plug it into the engine starter harness 22-pin connector. Plug the remaining engine starter harness 22-pin connector into the vehicle 22-pin connector.

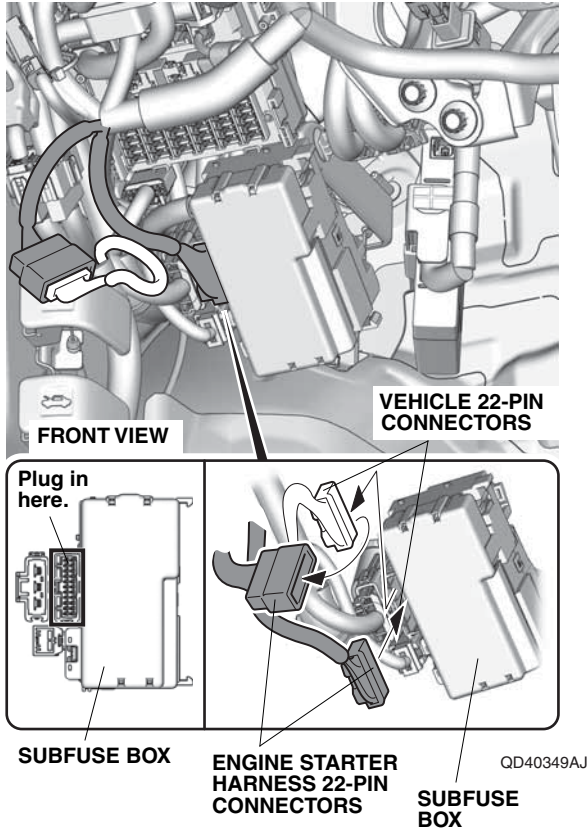

61. Secure the 22-pin connectors and engine starter harness to the vehicle harness with one wire tie and one long wire tie.

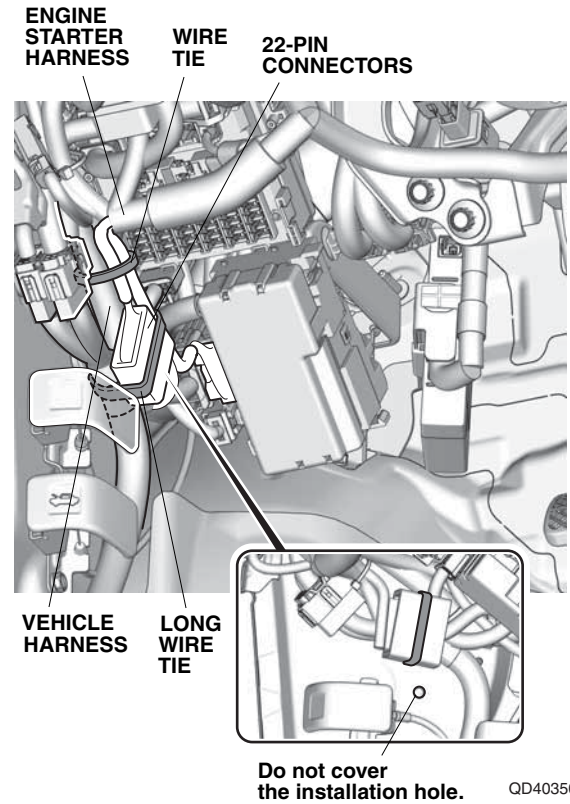

62. Route the engine starter harness as shown. Install the engine starter harness ground terminal with one ground bolt.

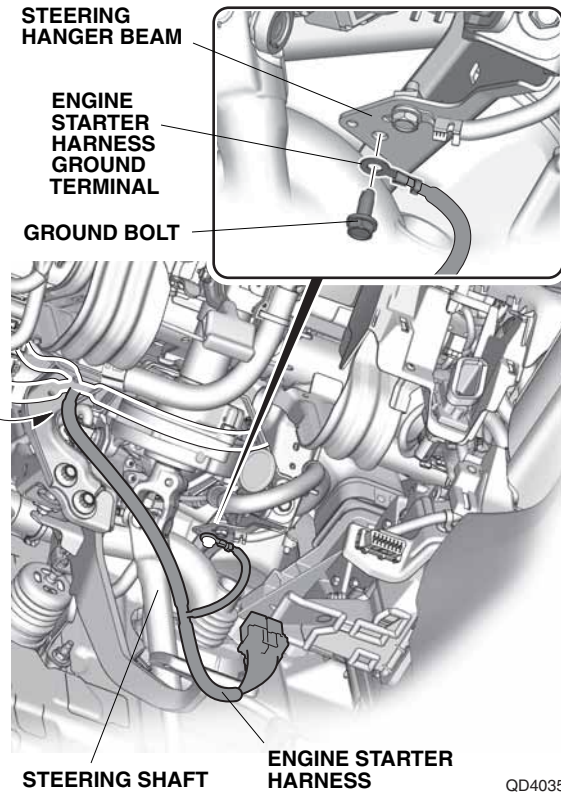

63. Secure the engine starter harness relay block to the hole in the vehicle panel. If another relay block is already secured to the hole in the vehicle panel, secure the engine starter harness relay block to the other relay block.

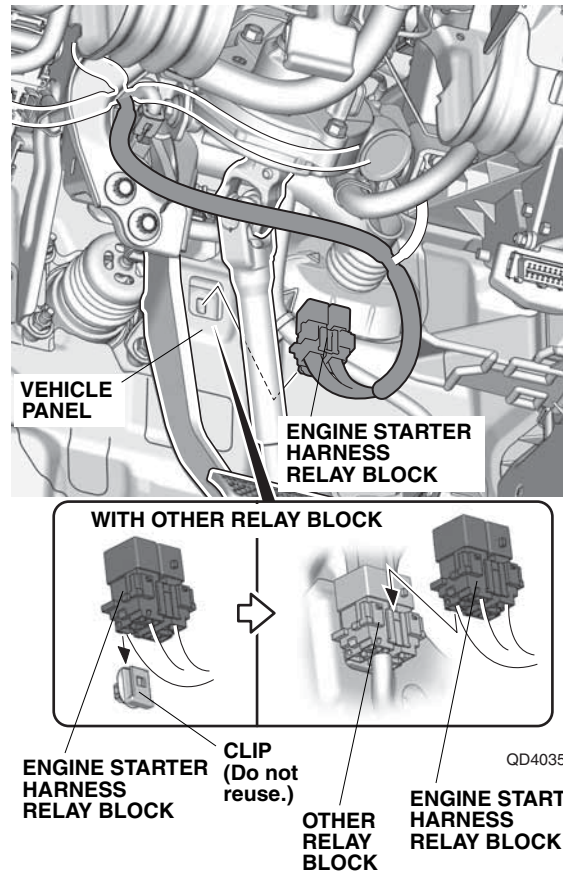

64. Align the white tape on the engine starter harness with the vehicle clip, and secure the engine starter harness to the vehicle harness with four wire ties.

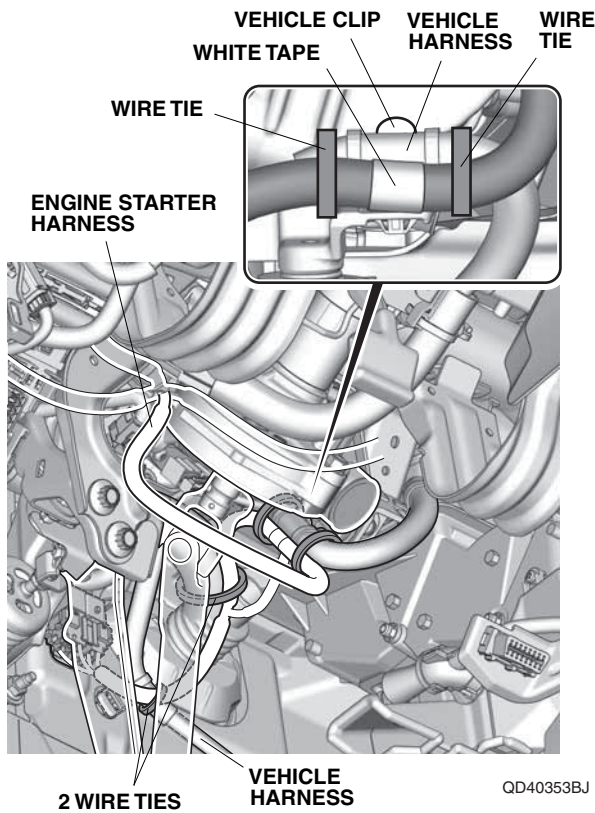

65. Secure the engine starter harness to the steering hanger beam with one wire tie.

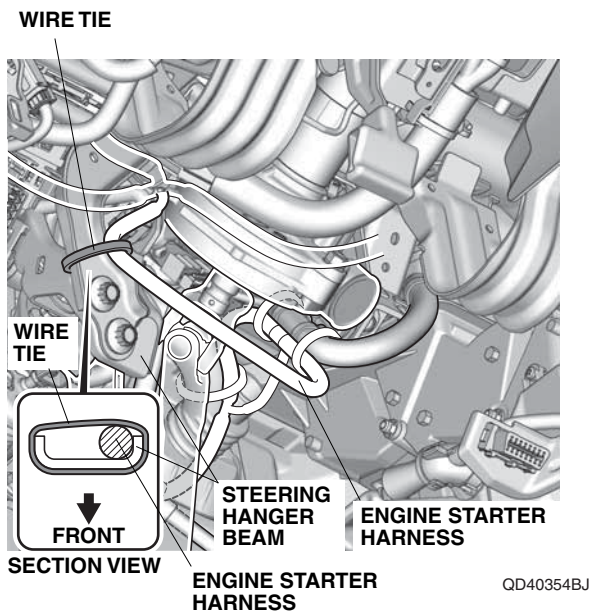

66. Route the engine starter harness along the vehicle harness. Align the white tape on the engine starter harness with the end of the vehicle harness protector, and secure the engine starter harness to the vehicle harness with one wire tie.

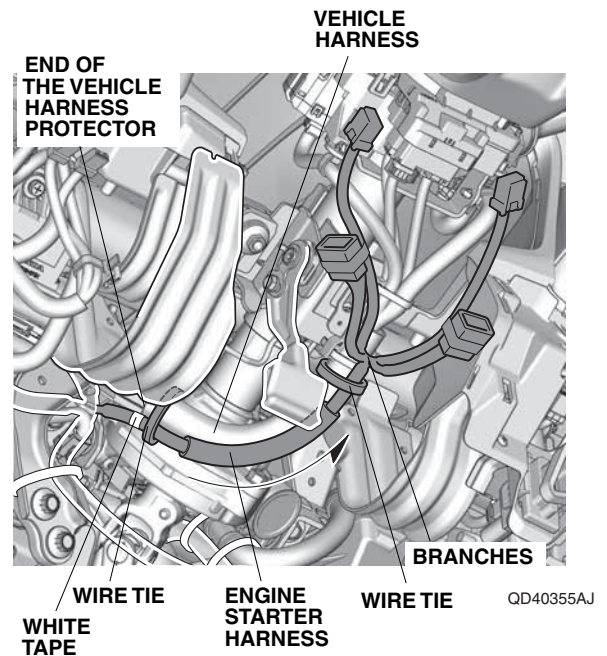

67. Align the branches of the engine starter harness and vehicle harness, and secure the engine starter harness to the vehicle harness with one wire tie.

68. Unplug the vehicle 10-pin connector from the wiper switch, and plug it into the engine starter harness 10-pin connector. Plug the remaining engine starter harness 10-pin connector into the wiper switch.

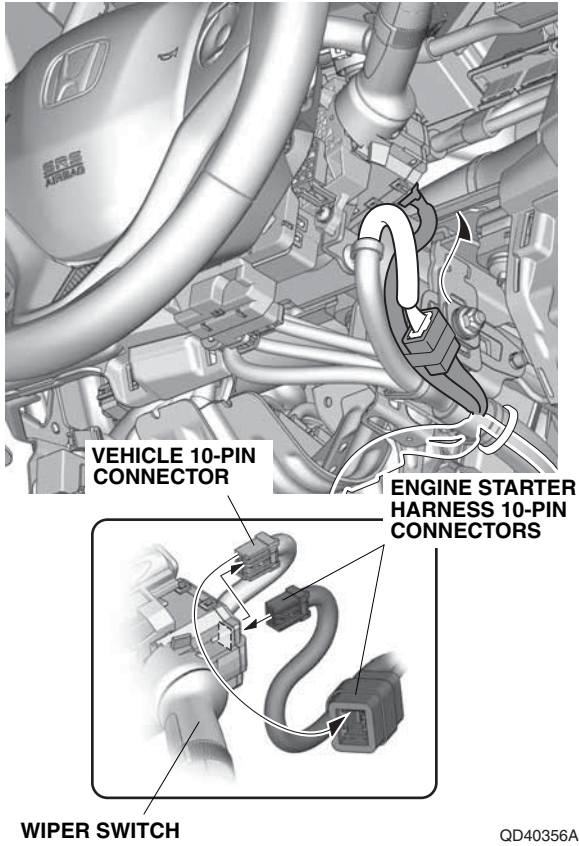

69. Align the white tape on the engine starter harness with the vehicle clip, and secure the engine starter harness to the vehicle harness with one wire tie.

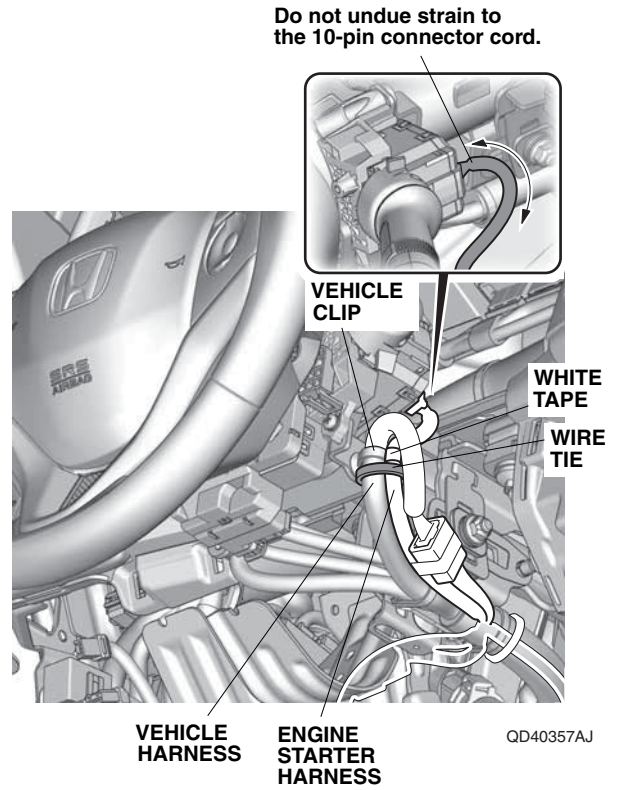

70. Unplug the vehicle 12-pin connector from the combination light switch, and plug it into the engine starter harness 12-pin connector. Plug the remaining engine starter harness 12-pin connector into the combination light switch.

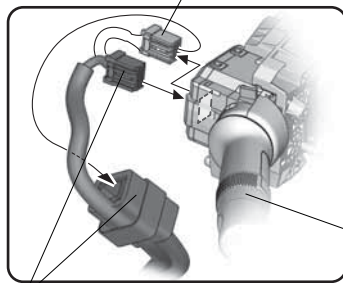
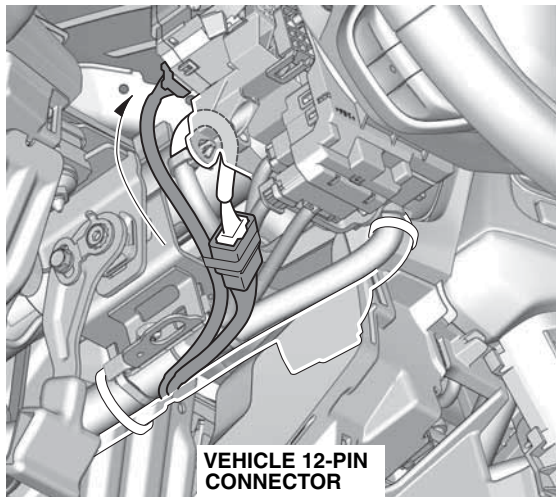

**ENGINE STARTER HARNESS 12-PIN CONNECTORS**

QD40358AJ

71. Align the white tape on the engine starter harness with the vehicle clip, and secure the engine starter harness to the vehicle harness with one wire tie.

Do not undue strain to the 12-pin connector cord.

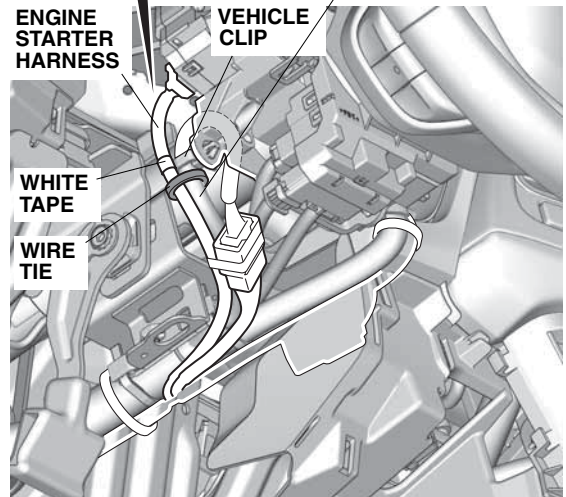
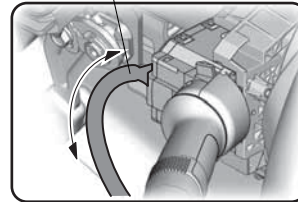

QD40359AJ

72. Secure the engine starter harness to the vehicle harness with one wire tie.  
NOTE: Make sure that the connectors and harness are not pinched or interfered with the steering wheel when moved for adjustment.

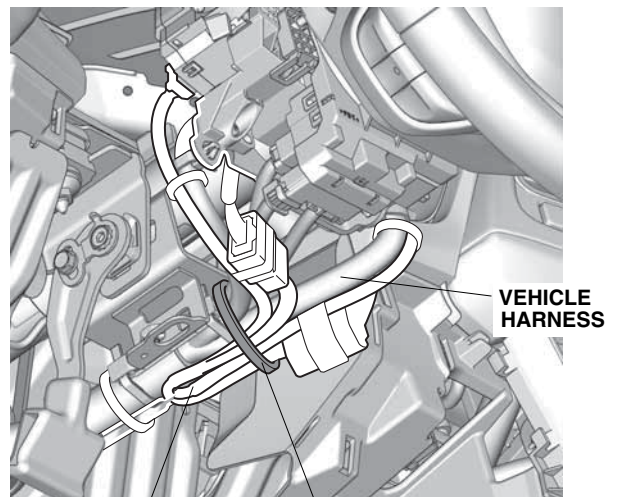

QD40360AJ

73. Secure the engine starter harness and antenna cable to the knee bolster with one long wire tie.

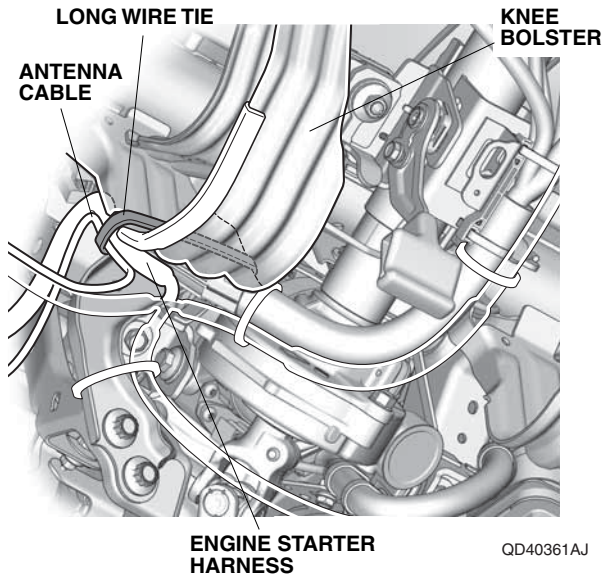

74. Align the white tape on the engine starter harness with the holes in the steering hanger beam, and secure the antenna cable and engine starter harness to the steering hanger beam with one wire tie.

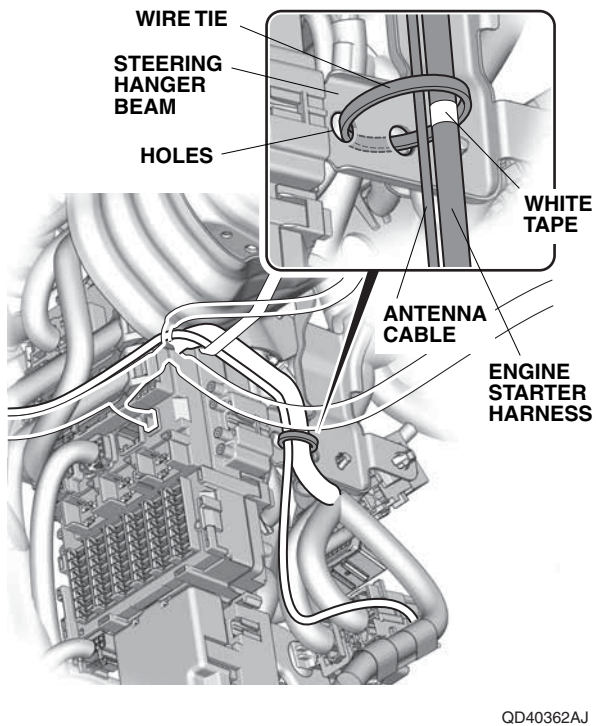

75. Bundle up the excess antenna cable as shown, and wrap one urethane tape around the antenna cable. Secure the antenna cable to the engine starter harness with one wire tie.  
NOTE: Do not fold the antenna cable.

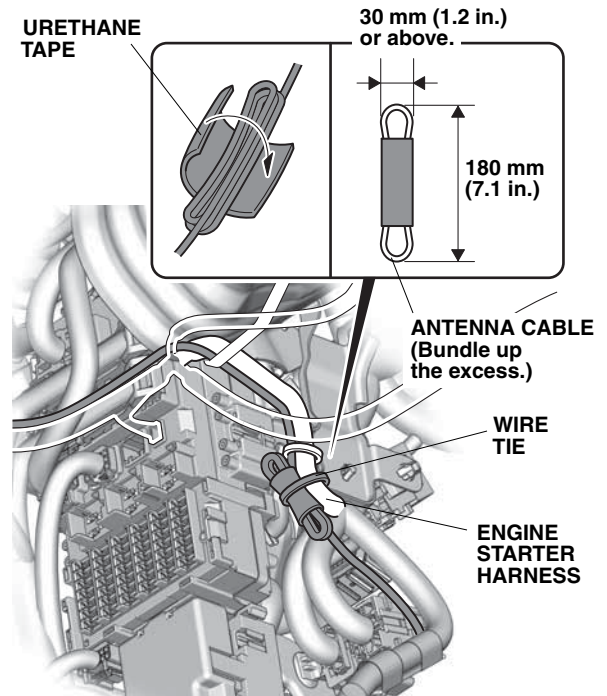

76. Using isopropyl alcohol on a shop towel, clean the lower column cover where the urethane tape will attach.

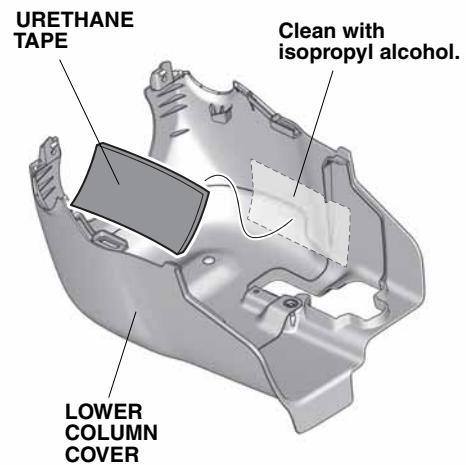

77. Attach the urethane tape to the lower column cover as shown.



78. Using isopropyl alcohol on a shop towel, clean the lower column cover where the urethane tape will attach.

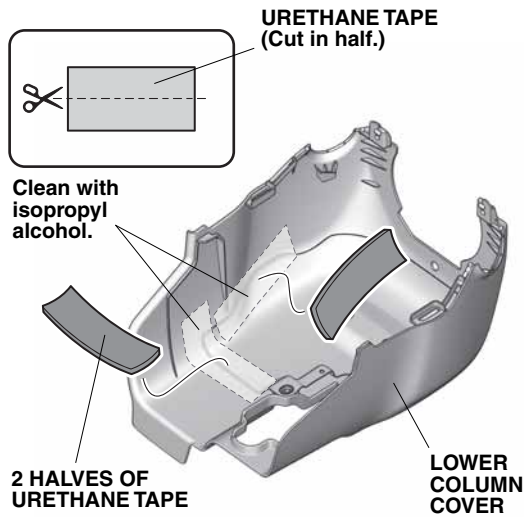

QC71809AJ

79. Using scissors, cut one urethane tape in half. Attach two halves of urethane tape to the lower column cover as shown.

80. Using isopropyl alcohol on a shop towel, clean the hood where the caution label will attach.

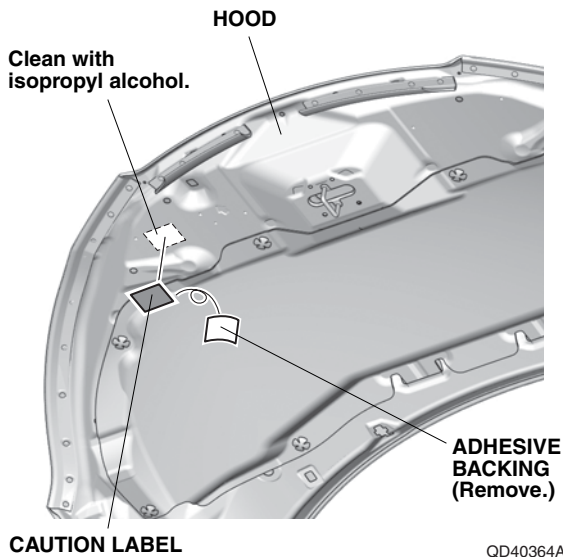

QD40364AJ

81. Remove the adhesive backing from the caution label, and attach the caution label to the hood as shown.

82. Check that all wire harnesses are routed properly and all connectors are plugged in.
83. Check the overlap between the headliner and the driver's A-pillar trim. Refer to the Service Manual. If necessary, adjust the overlap.
84. Install all removed parts.
85. Connect the negative cable to the battery.
86. Press and hold the audio unit power button for two seconds to restore the audio and navi (if equipped) system functions.
87. Set the clock on vehicles without navigation.
88. If necessary restore the systems back to normal operation as described in the service information.
89. Perform the "REMOTE ENGINE STARTER REGISTRATION" and the "CHECK THE OPERATION OF THE REMOTE CONTROL ENGINE STARTER."

## REMOTE ENGINE STARTER REGISTRATION

NOTE: Register after making sure the HDS has been upgraded to the latest version as described in the Service News.

1. Acquire the PCM Code from the Interactive Network.

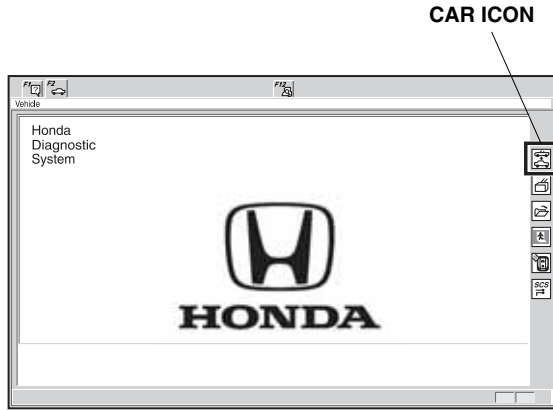

QC31909AC

2. Connect the HDS/MVCI tester to the OBD II data link connector, then press the engine switch to ON.
3. Start the HDS, and click the car icon.
4. Input the VIN and other required information into the HDS, then click the check button.

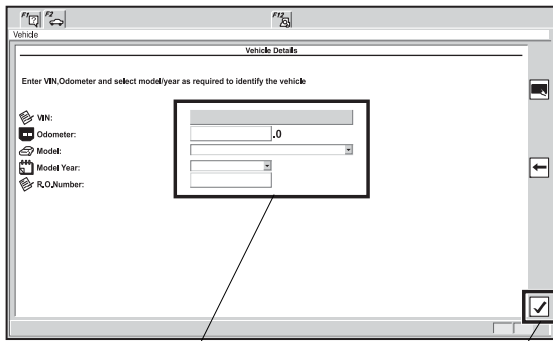

Input the VIN and other required information.

CHECK BUTTON

QB32102BH

5. Select **Honda Systems**, then click the check button.

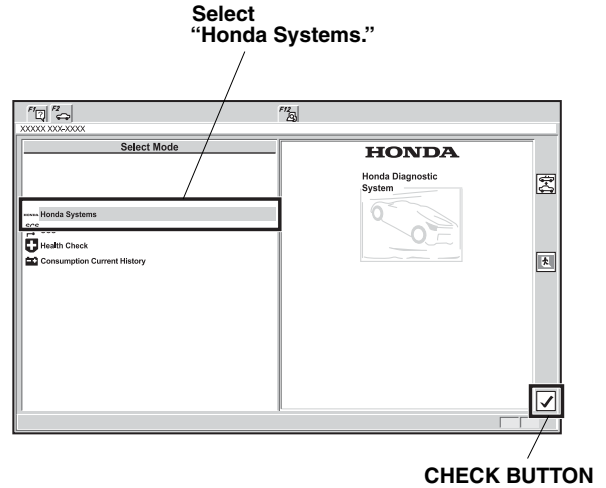

QB32103AH

6. Select **R/C ENG STARTER** and click the check button.

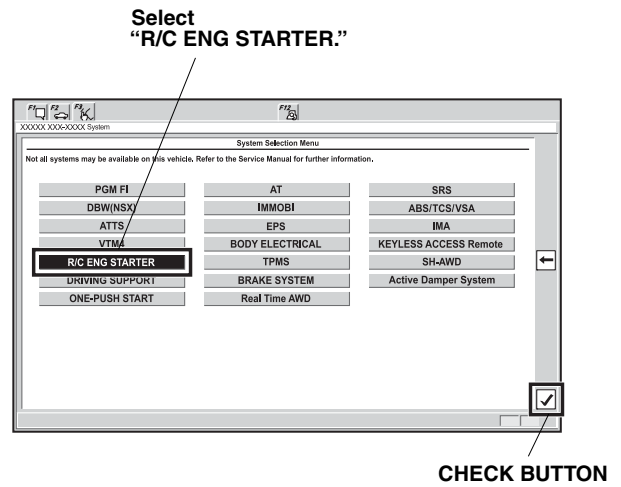

QB32104AH

- Select **REGISTER REMOTE CONTROL ENGINE STARTER UNIT**, then click the check button.

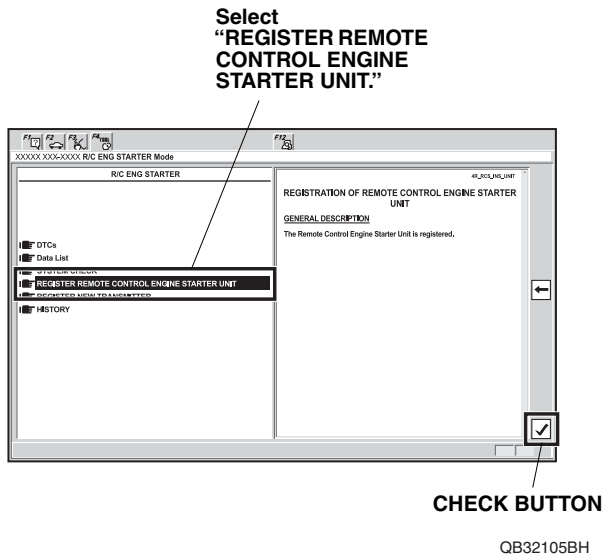

- The following message will display: **Obtain PCM-code (IMMOBILIZER PCM CODE) from iN. This vehicle's VIN will be required to obtain the password. (USA)** Click the check button.

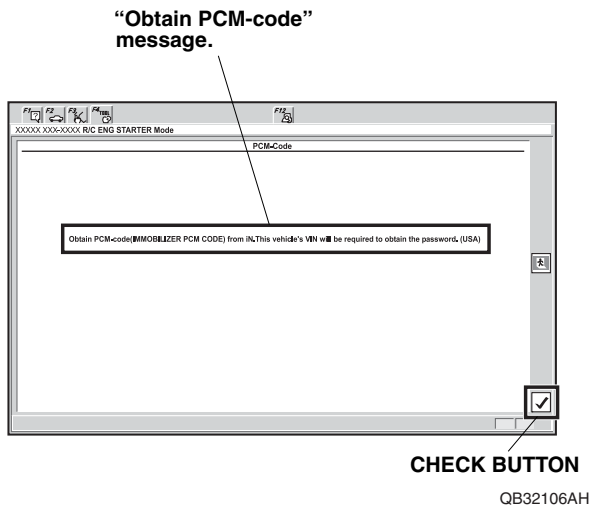

- Input the PCM-code, then click the check button.  
NOTE: To ensure security, the PCM-code (password) is changed everyday, so it is impossible to register the remote control engine starter if the dates of the PCM-code acquisition and registration are different. The date of the HDS/MVCI tester should also be the same.

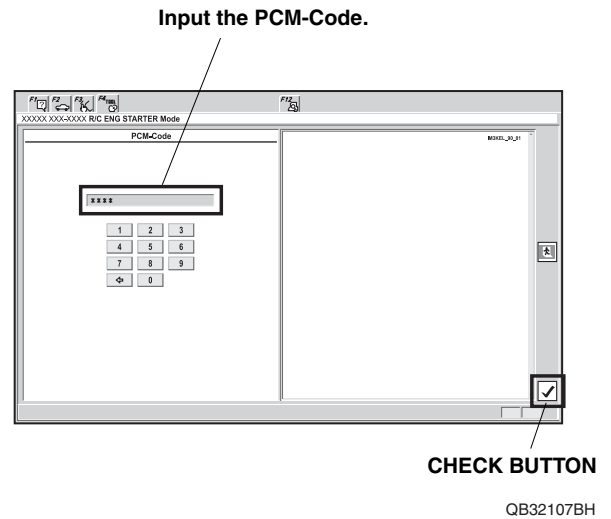

- The following message will display: **The registration of the Remote Control Engine Starter Unit has been completed.** Press the engine switch to OFF.

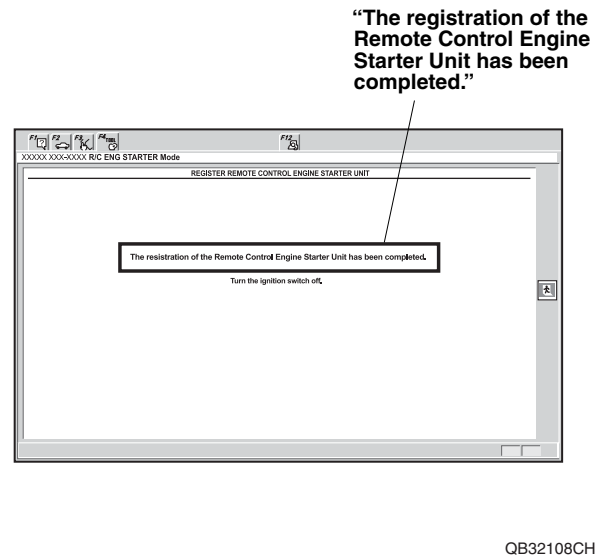

11. The following message will display: **Check that engine can be started by the Transmitter.** Click the check button.

**“Check that engine can be started by the Transmitter.”**

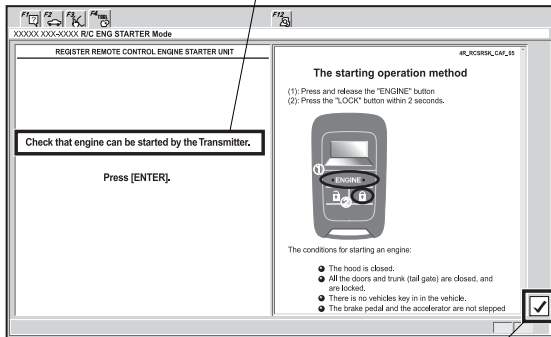

**CHECK BUTTON** QB32109CH

12. Perform the CHECK THE OPERATION OF THE REMOTE CONTROL ENGINE STARTER on page 29. Clear the DTCs, then disconnect the HDS/MVCI.

## CHECK THE OPERATION OF THE REMOTE CONTROL ENGINE STARTER

### Operating Conditions

- The hood is closed.
- The shift lever is in park.
- Press the engine switch to OFF and the key is outside the vehicle.
- All doors and tailgate are closed and locked.

### Inspection

1. Press the engine/command button on the transmitter and release, within 2 seconds, press the lock/start button on the transmitter.

The engine should start if all operating conditions are met.

Does the engine start?

Yes - Operation is normal.
No: <ul style="list-style-type: none"> <li>• Make sure all "Operating Conditions" are met.</li> <li>• Check the engine starter harness connections.</li> <li>• Connect the HDS/MVCI and check for an indicated failure. (Refer to the appropriate Service Manual for details.)</li> </ul>

2. Press the engine/command button on the transmitter and release, within 2 seconds, press the unlock/stop button. The engine should stop.

Does the engine stop?

Yes - Operation is normal.
No - Check the engine starter harness connections.

3. After the engine has stopped, start the engine again, and check that the engine stops after each of the following conditions:

NOTE: After each test the ignition key must be cycled, or the driver's door must be opened and closed.

- Move the shift lever out of the P position.
- Unlock or open the doors or the tailgate.
- Open the hood.
- Press the engine switch.
- Press on the brake pedal.

Does the engine stop after each of these tests?

Yes - Operation is normal.
No - Check the engine starter harness connections.

4. Check that the power windows and the moonroof do not function, and the shift lever does not move to any position when the engine is started with the transmitter.
5. Check that the engine does not start under "Operating Conditions" with the key left inside the vehicle.
6. Start the engine again, press the engine/command button on the transmitter two times, and check the vehicle condition on the display.
7. Check the operation of the transmitter when the vehicle is 120 m (400 ft.) away and in direct sight.

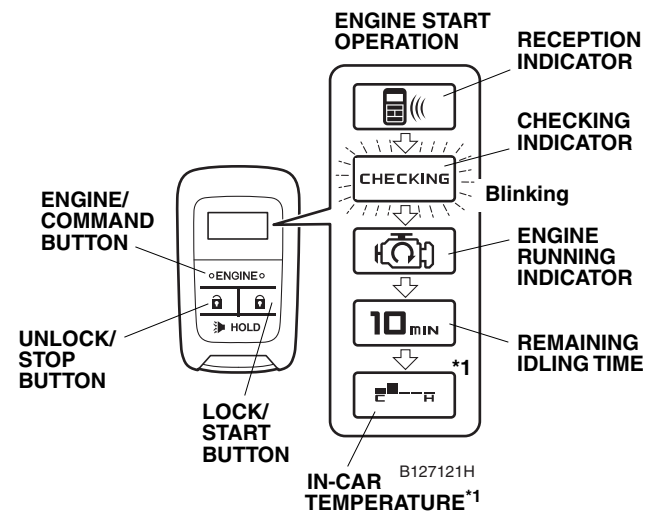

\*1 Only on vehicles equipped with the automatic climate control. This indicator is displayed for some vehicles among them.

8. Press the unlock/stop button on the transmitter and verify that the doors unlock. Press the lock/start button, and verify that the doors lock.