



INSTALLATION INSTRUCTIONS

Accessory
CARPET FLOOR MATS
P/N 08P15-TM8-120

Application
2014 INSIGHT

Publications No.
All 50647
Issue Date
OCT 2013

Put this information in the glove box with the vehicle owner's manual.

PARTS LIST

Driver's side floor mat

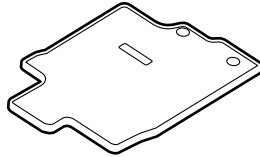

Passenger's side floor mat

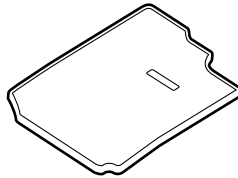

Rear floor mat

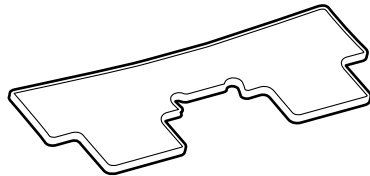

2 Anchors

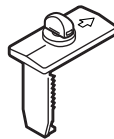

TOOL AND SUPPLIES REQUIRED

Flat-tip screwdriver
Utility Knife
Scale

Illustration of the Floor Mats in the Vehicle

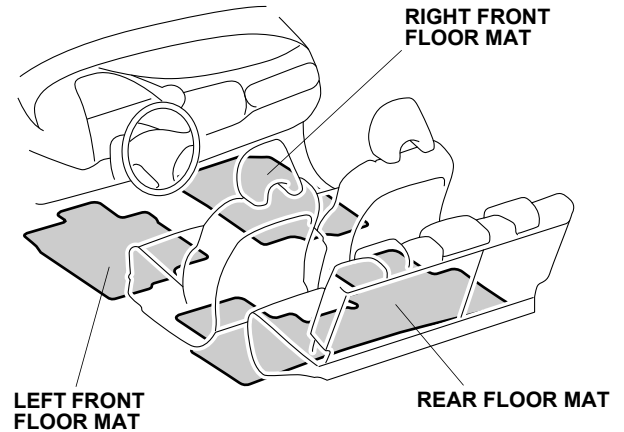

INSTALLATION

Customer Information: The information in this installation instruction is intended for use only by skilled technicians who have the proper tools, equipment, and training to correctly and safely add equipment to your vehicle. These procedures should not be attempted by "do-it-yourselfers."

NOTE:

- Before installing the floor mats, identify their installation positions.
- Anchors are required for the driver's side of the vehicle; they prevent the floor mat from sliding forward and interfering with the pedals.
- If you remove the driver's floor mat, make sure you reanchor it when you put it back in the vehicle.
- If you replace the floor mat, use factory mats designed to be used with the anchors.

1. Install the driver's side floor mat over the anchors as shown.

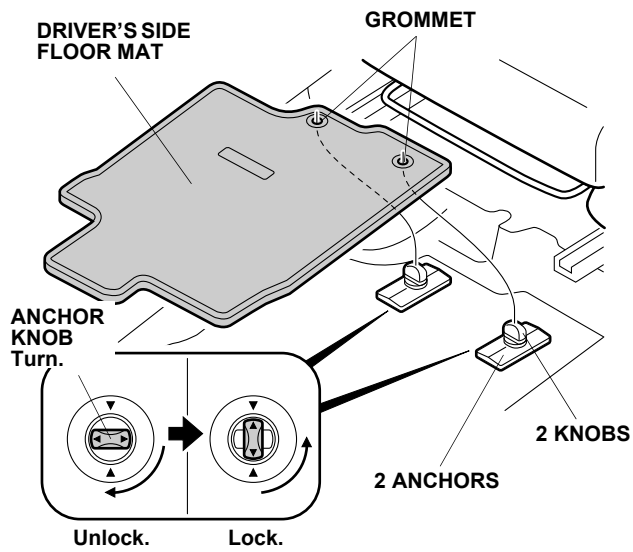

2. Turn the knob on each anchor to secure the driver's side floor mat.
3. Install the passenger's side floor mat.

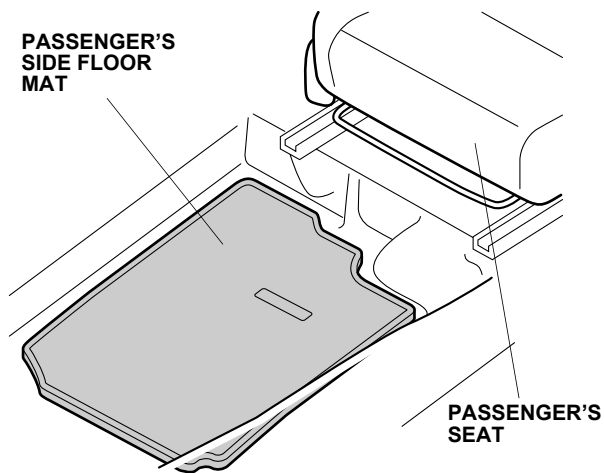

4. Install the rear floor mat.

