

# HONDA INSTALLATION INSTRUCTIONS

Accessory  
**ALL SEASON MATS**

Application  
**2013 FIT**

Publications No.  
**All 13196**  
Issue Date  
**JULY 2012**

## PARTS LIST

Driver's side floor mat

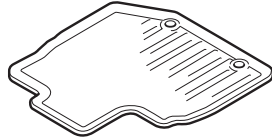

Passenger's floor mat

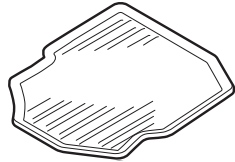

Left rear floor mat

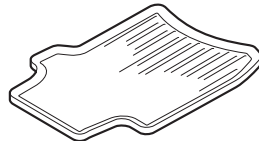

Right rear floor mat

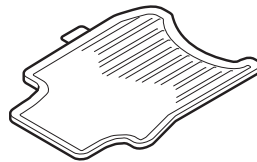

2 Anchors  
(Not used)

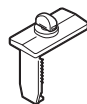

## INSTALLATION

### NOTE:

- Before installing the floor mats, identify their installation positions.
- Anchors are required for the driver's side of the vehicle; they prevent the floor mat from sliding forward and interfering with the pedals.
- If you remove the driver's side floor mat, make sure you reanchor it when you put it back in your vehicle.
- If you replace the floor mats, use factory all-season floor mats designed to be used with the anchors.
- Do not put additional floor mats on top of the anchored mat. The additional floor mats may slide forward and interfere with the pedals.

1. Make sure you have the anti-theft code for the audio unit and navigation system (if equipped), then write down the radio station presets.

### DRIVER'S SIDE FLOOR MAT

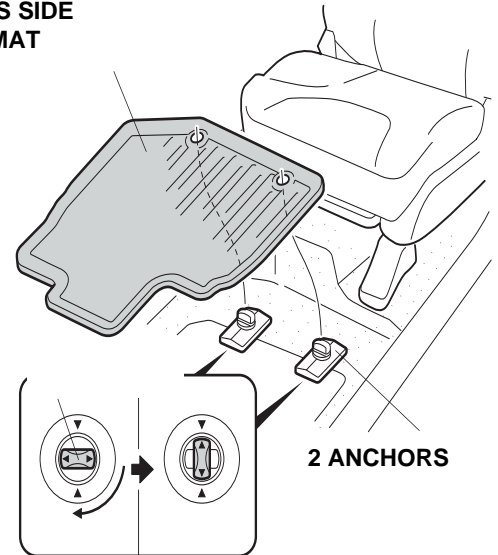

ANCHOR  
KNOB

2 ANCHORS

2. Disconnect the negative cable from the battery.
3. Allow the engine and all cooling system components to cool down.
4. Place a clean drain pan under the radiator drain plug, then remove the drain plug from the bottom of the radiator to drain the coolant. Remove the radiator cap to increase the flow.

### NOTICE

Radiator coolant will damage paint. Quickly rinse any spilled coolant from painted surfaces.

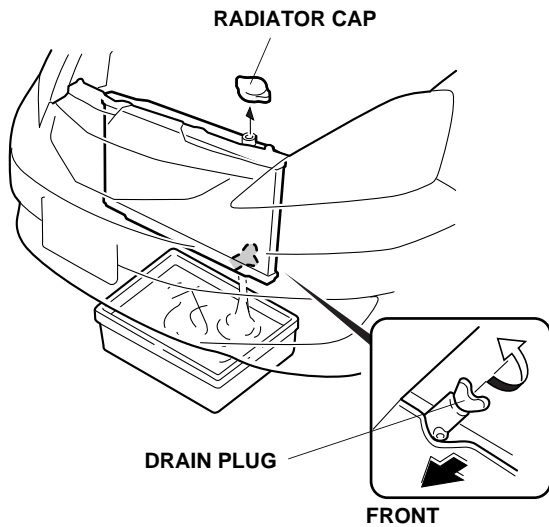

5. With the vehicle on a lift, remove the engine splash guard (one screw and three clips).

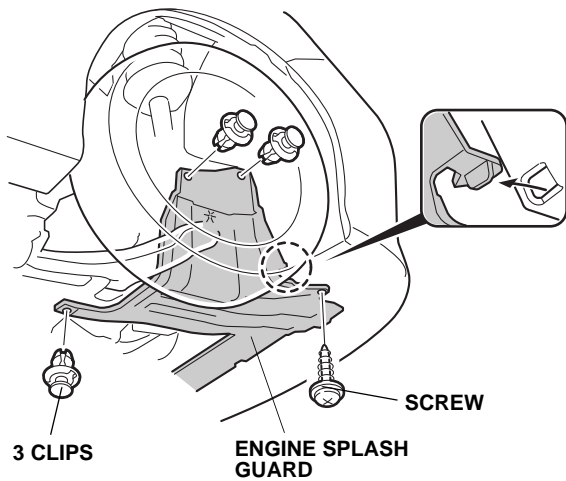

6. Using a 19 mm socket, remove the drain bolt and washer from the engine block. Coolant remaining in the engine jackets will flow out the hole when the plug is removed. Retain the plug; it will be used if the engine block heater is removed.

NOTE: Use a new washer if the drain bolt is reinstalled.

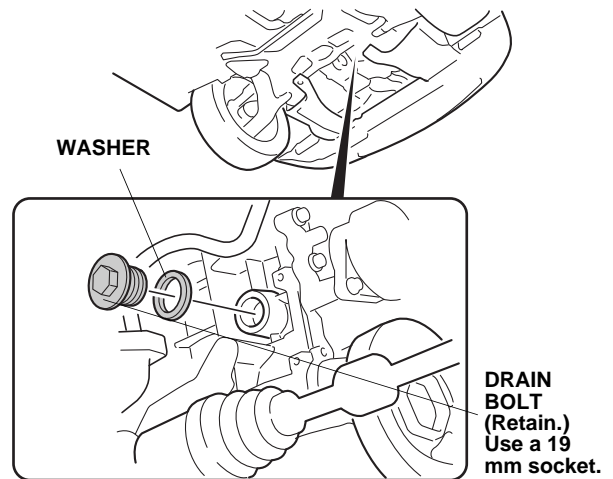

7. Install the engine block heater with aluminum washer into the engine block using a 24 mm socket with a 100 mm (4 in.) extension. Torque the engine block heater to 60 N·m (44 lbf·ft). Using an extension longer than 100 mm (4 in.) will give you an incorrect torque reading.

**ENGINE BLOCK HEATER**  
60 N·m (44 lbf·ft)  
Use a 24 mm socket.

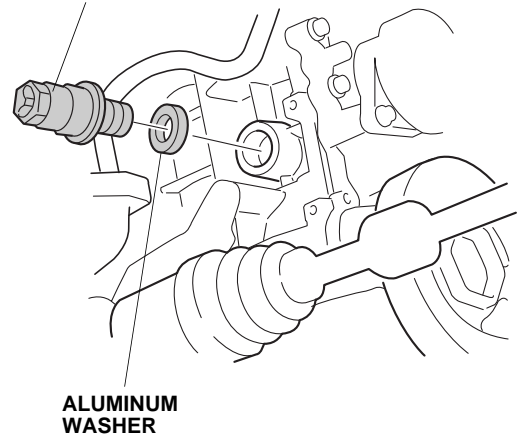

8. Measure and mark the heater harness at the point shown. Install a wire tie with clip to the heater harness at each of the measurements shown.

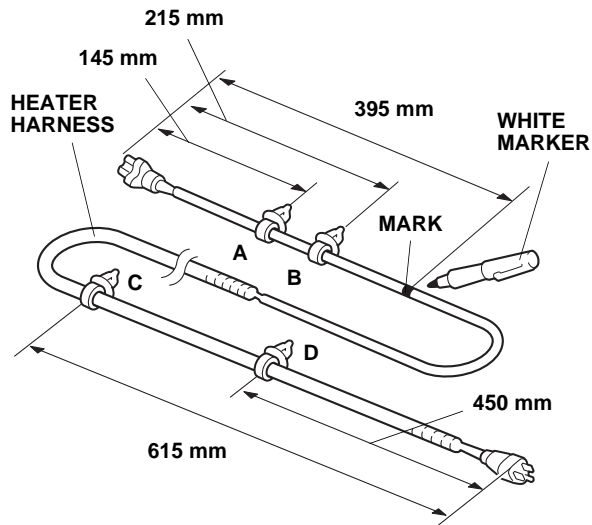

9. Plug the heater harness connector into the engine block heater. Temporarily place the entire heater harness on top of the engine.

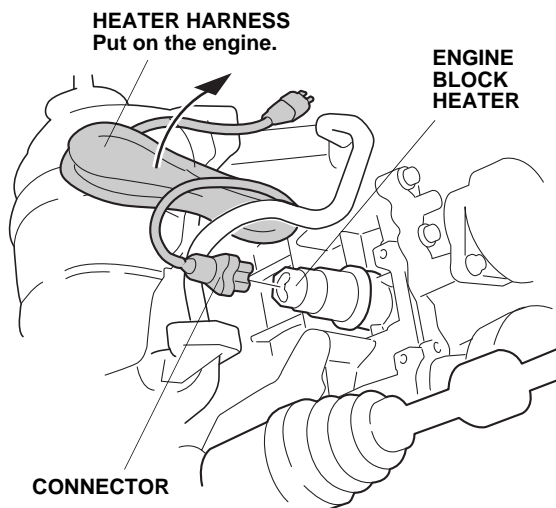

10. Lower the vehicle.
11. Remove the grille cover (eight clips).

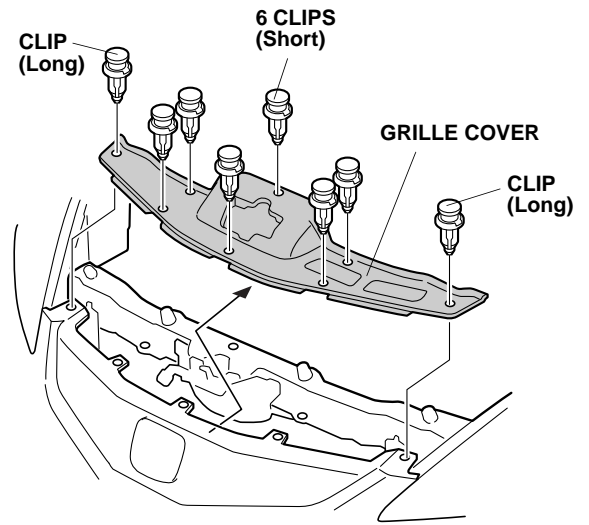

12. Using one washer-bolt, install the bracket as shown.

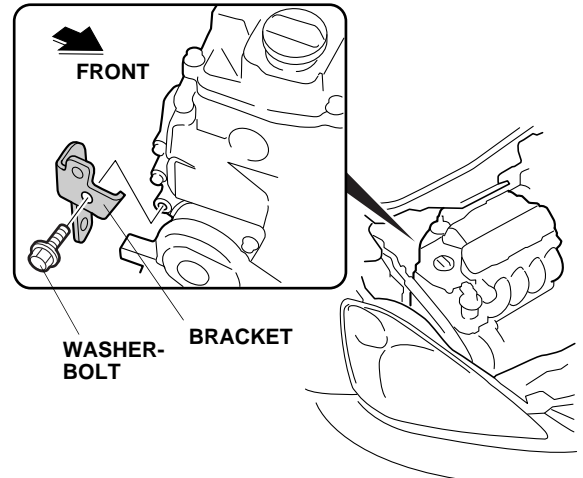

13. Route the heater harness as shown, and secure the two wire ties with clips (points A and B) to the bracket.

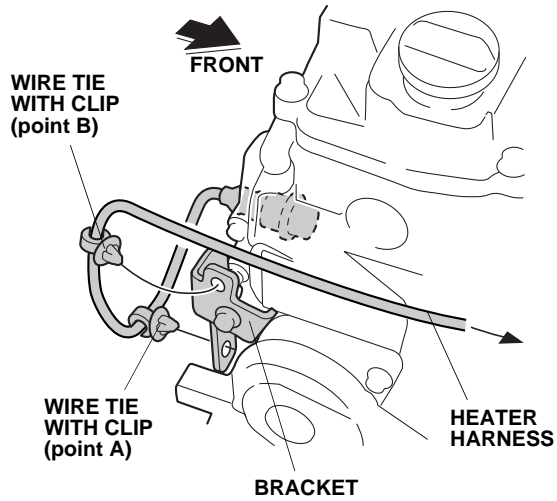

14. Route the heater harness as shown. Using two black wire ties, secure the heater harness to the vehicle harness.

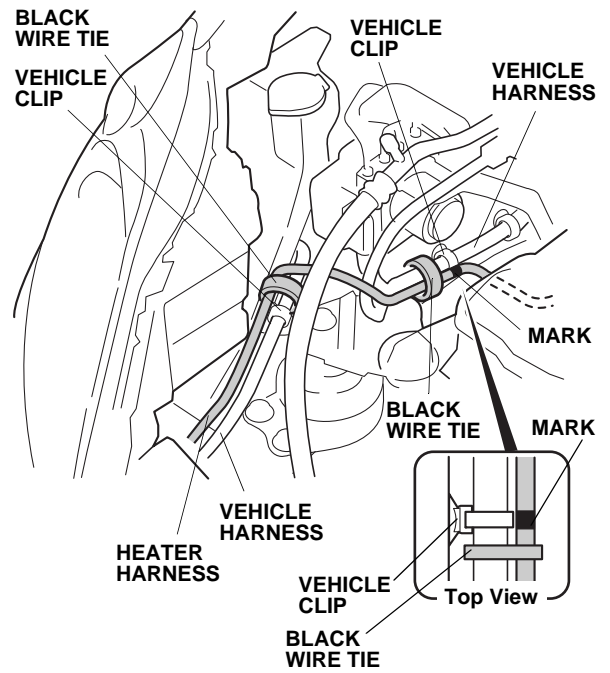

15. Route the heater harness as shown and secure the two wire ties with clips (points C and D) to the vehicle frame.

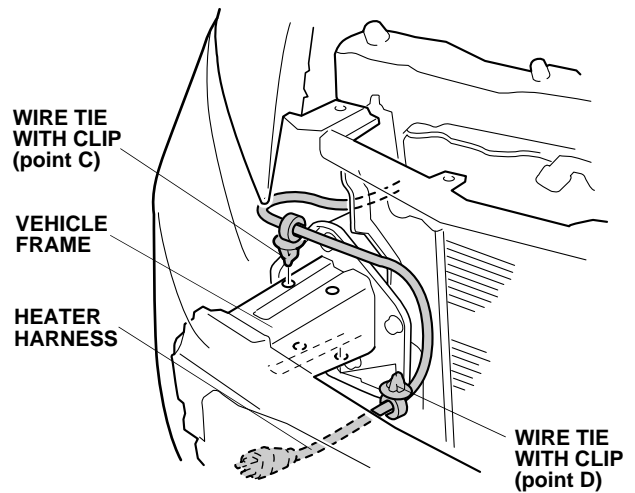

16. Bundle the excess of the heater harness. Using three black wire ties, secure the harness to the vehicle harness.

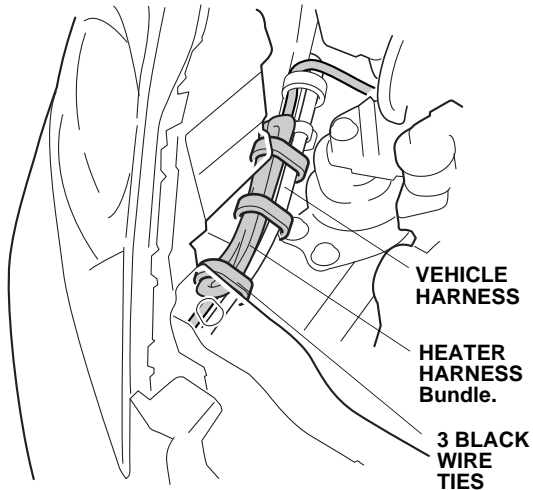

17. Route the heater harness:

- Sport model: Route the heater harness as shown. Using one black wire tie, secure the heater harness to the front bumper grille. Attach the protective cap to the front bumper grille, and plug the connector on the heater harness into the protective cap.

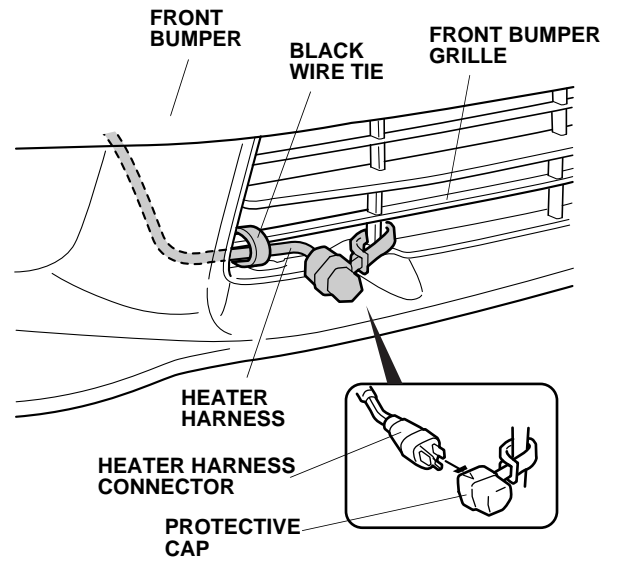

- Base model: Route the heater harness as shown. Using one black wire tie, secure the heater harness to the front bumper grille. Attach the protective cap to the front bumper grille, and plug the connector on the heater harness into the protective cap.

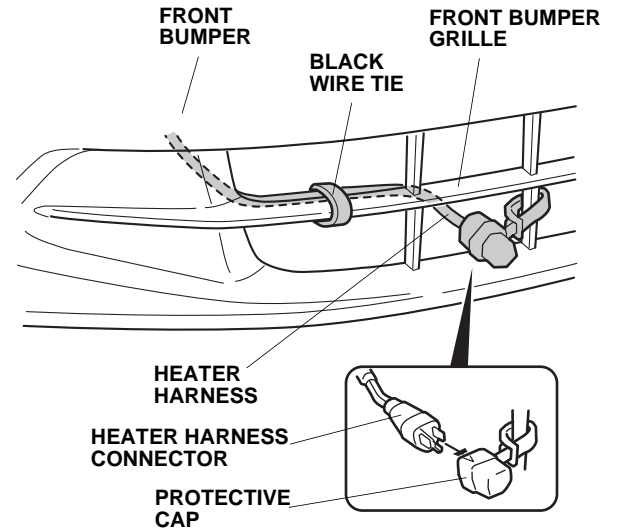

18. Reinstall all removed parts.
19. Reinstall the radiator drain plug.
20. Fill the system with coolant. Follow the instructions described in the service manual to fill and bleed the cooling system.

21. Check the coolant reservoir for the correct level and check the cooling system for signs of leakage.  
Repair as necessary.
22. Check that the heater harness is routed properly and all connectors are plugged in.
23. Put the drain plug (removed in step 6) in the glove box.
24. Reconnect the negative cable to the battery.
25. Enter the audio unit anti-theft code, and reset the radio station presets.
26. Reset the clock.