



INSTALLATION INSTRUCTIONS

Accessory	Application	Publications No. All 36608
HONDA MUSIC LINK (FOR IPOD®)	2008 RIDGELINE	Issue Date MAY 2007

PARTS LIST

Attachment Kit (sold separately)
P/N 08A28-1H1-800

4 Cushion tapes

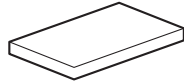

Holder cushion

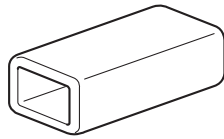

Grommet



8 Wire ties

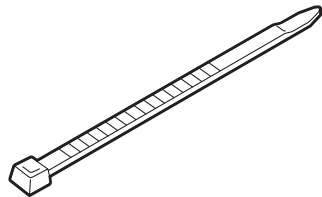

2 Long wire ties

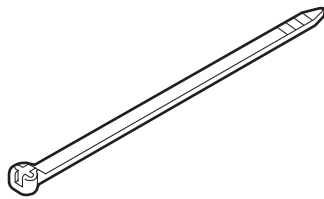

Music Link Adapter Kit (sold separately)
P/N 08A28-1H1-100

Music Link adapter unit

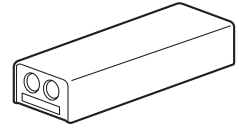

Bus cable

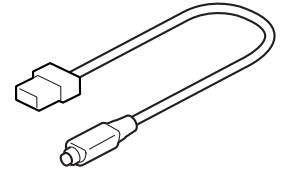

Music Link harness

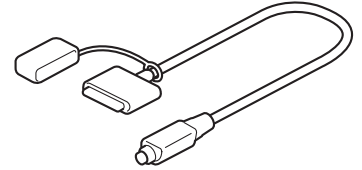

CD-ROM

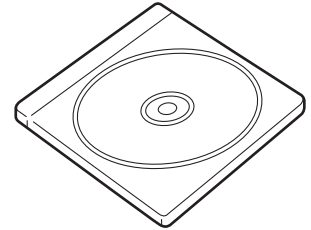

Quick reference guide

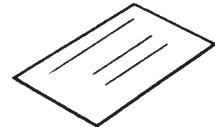

Bus Cable 2 Port (sold separately)
P/N 08A31-0F1-000

Bus cable 2 port

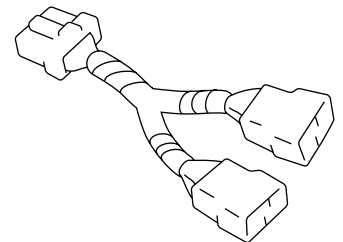

TOOLS AND SUPPLIES REQUIRED

#2 Phillips screwdriver
Flat-tip screwdriver
Diagonal cutters
Scissors
Ratchet
10 mm Socket
10 mm Combination wrench
Drill motor
Drill bit (3 mm)
Hole saw (20 mm)
Shop towel
Pushpin
Eye protection
Isopropyl alcohol
Electrical tape

Illustration of the Music Link System Installed on the Vehicle

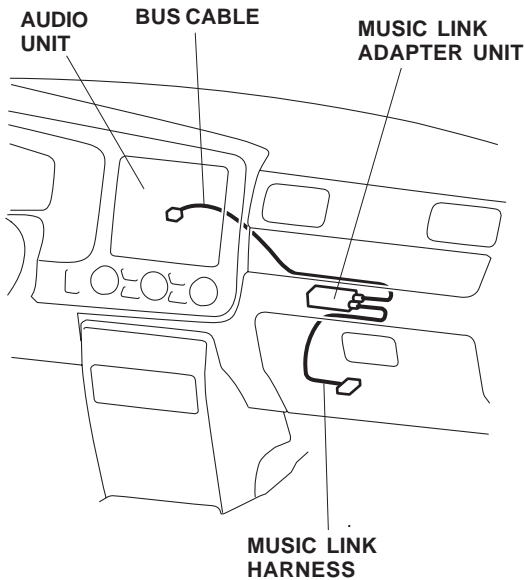

INSTALLATION

Customer Information: The information in this installation instruction is intended for use only by skilled technicians who have the proper tools, equipment, and training to correctly and safely add equipment to your vehicle. These procedures should not be attempted by “do-it-yourselfers.”

1. Make sure you have the anti-theft code for the radio, then write down the frequencies for the preset buttons.
2. Disconnect the negative cable from the battery.

3. Remove the glove box:
 - Open the glove box. Disconnect the damper arm.
 - Remove the stoppers (two retaining tabs for each stopper).
 - Remove the two screws.

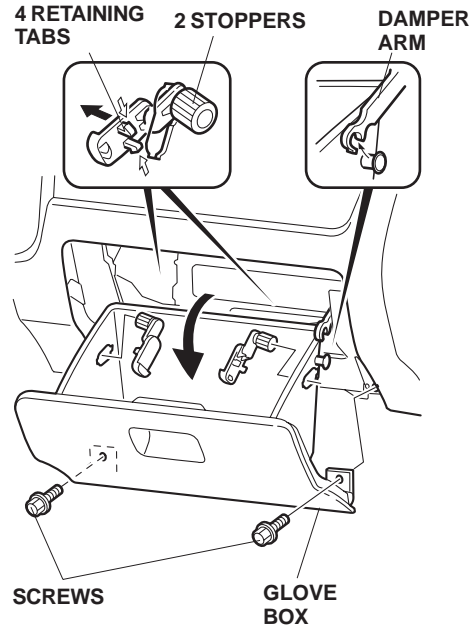

4. Insert a flat-tip screwdriver wrapped with a shop towel into the groove of the instrument panel, and release the two clips. Pull the instrument panel out toward you to release the eighteen clips, and remove the instrument panel by unplugging the vehicle connectors.

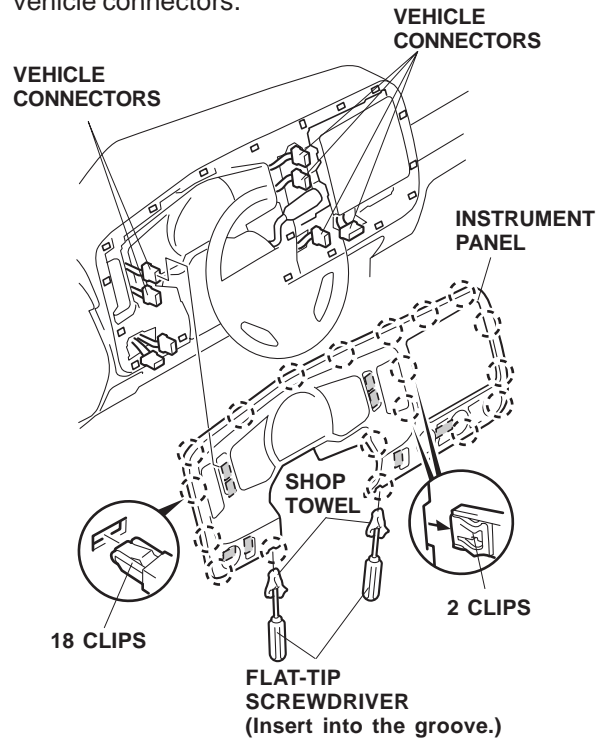

- Remove the audio unit (five screws, and pull the audio unit out towards you), and unplug the vehicle connectors.

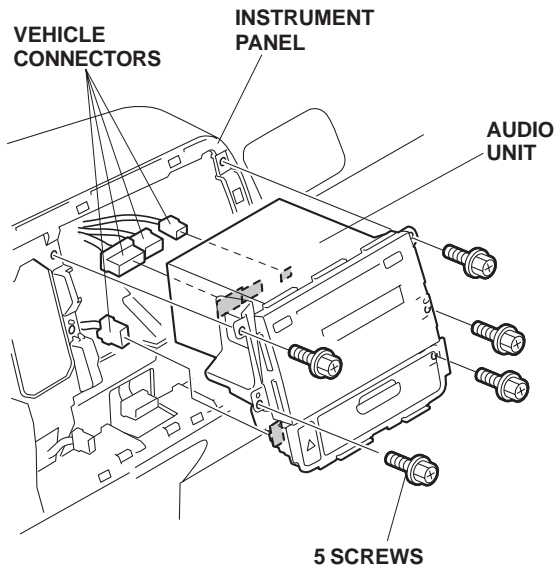

- Route the DIN connector end of the bus cable from the audio unit opening to the glove box opening.

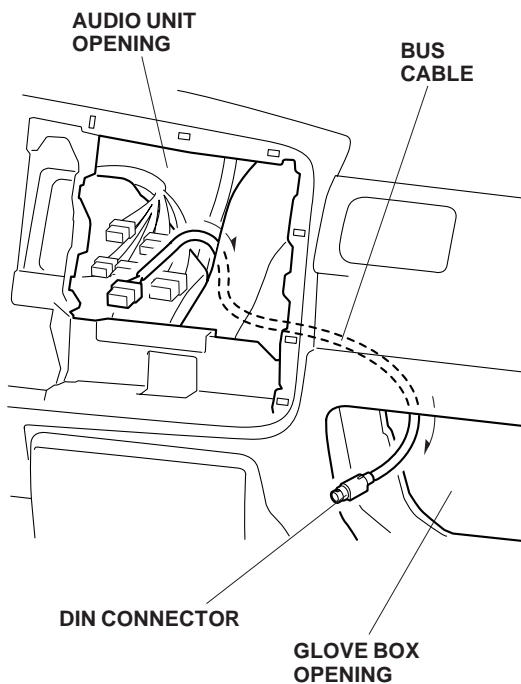

- Secure the bus cable:

Without the 14-pin Connector: Align the bus cable 14-pin connector with vehicle 20-pin connector, and secure the bus cable to the vehicle harness with the two wire ties.

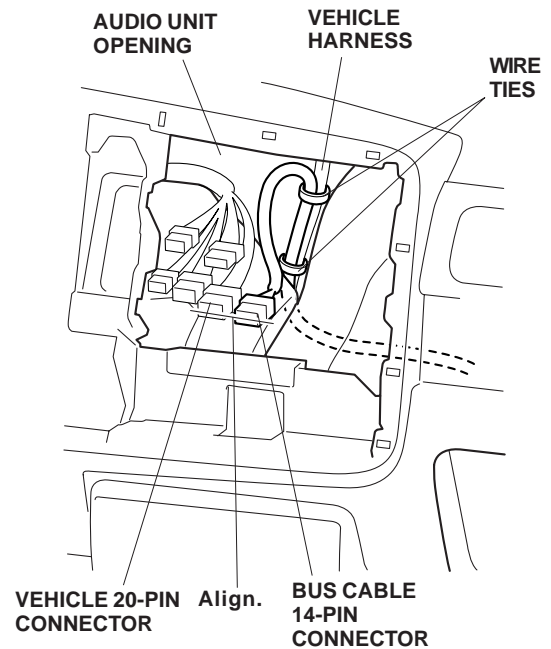

With the Vehicle 14-pin Connector or the XM Radio:

- Connect the bus cable 14-pin connector and vehicle 14-pin connector to the bus cable 2 port 14-pin connectors.
- Attach one cushion tape around each bus cable 2 port 14-pin connector.

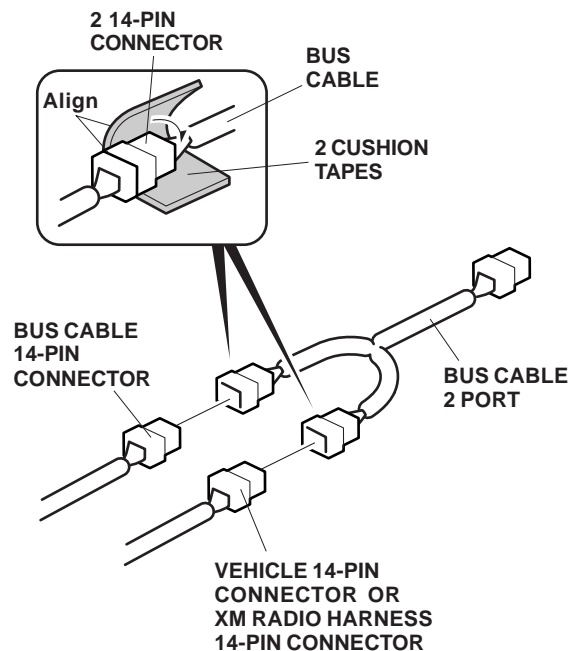

- Align the bus cable 2 port 14-pin connector with vehicle 20-pin connector. Bundle up the vehicle harness or XM radio harness. Secure the bus cable 2 port, bus cable, and vehicle harness with two wire ties as shown.
- Secure the bus cable to the vehicle harness with two wire ties.

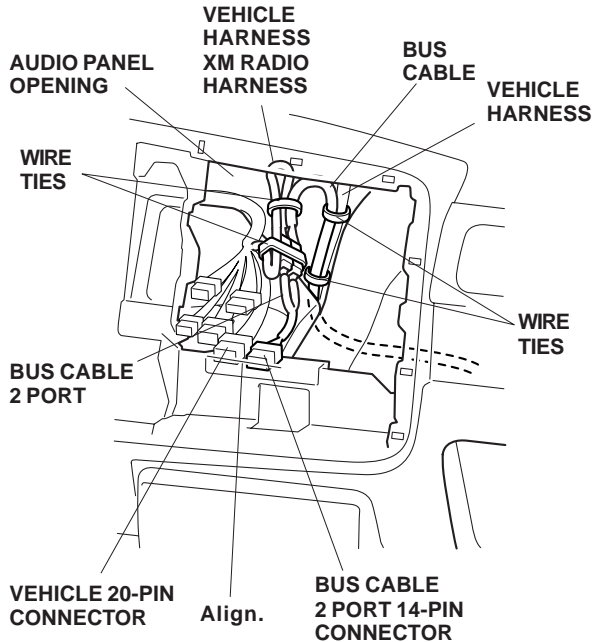

With the Player and the XM Radio:

- Connect the bus cable 14-pin connector and XM radio harness 14-pin connector to the bus cable 2 port 14-pin connectors.
- Attach one cushion tape around each bus cable 2 port 14-pin connector.

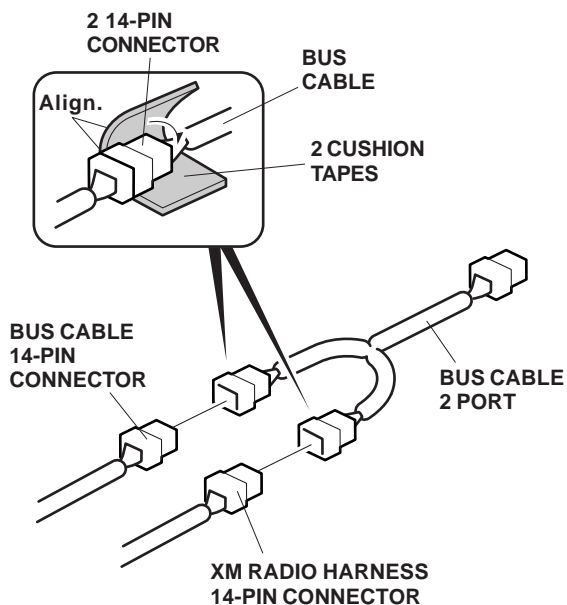

- Align the bus cable 2 port 14-pin connector with the vehicle 20-pin connector. Bundle up the XM radio harness. Secure the bus cable 2 port, bus cable, and the vehicle harness with two wire ties as shown.
- Secure the bus cable to the vehicle harness with the two wire ties.

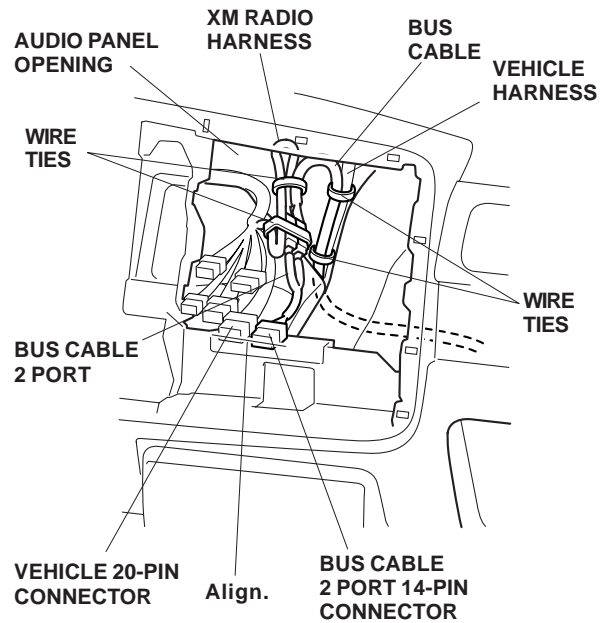

- Using a felt-tip pen, mark the Music Link harness as shown.
- Cut one cushion tape into four quarters, and wrap three sections to the Music Link harness.

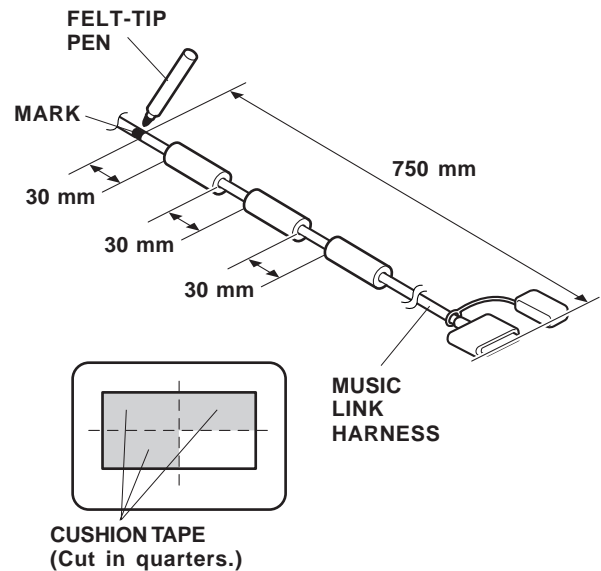

- To prevent damage, wrap electrical tape around the drill bit about 30 mm away from the tip. While wearing eye protection, drill a 20 mm hole through the marked location. Remove all burrs from the drilled hole.

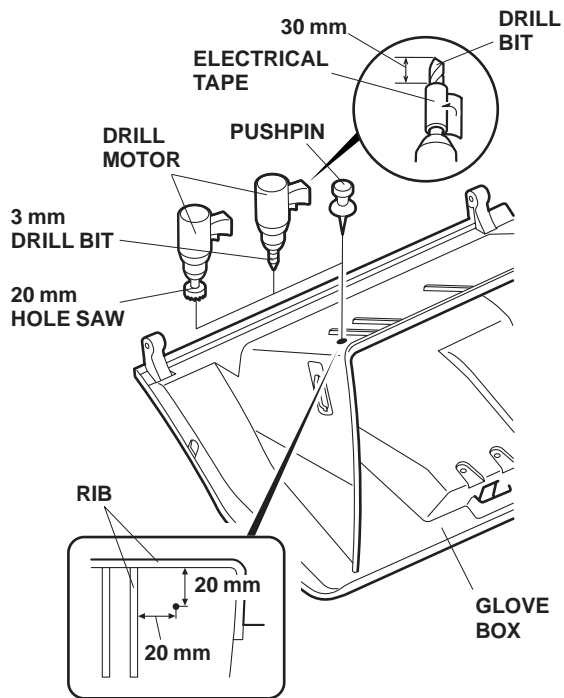

- Route the Music Link harness DIN connector into the 20 mm hole in the direction shown.

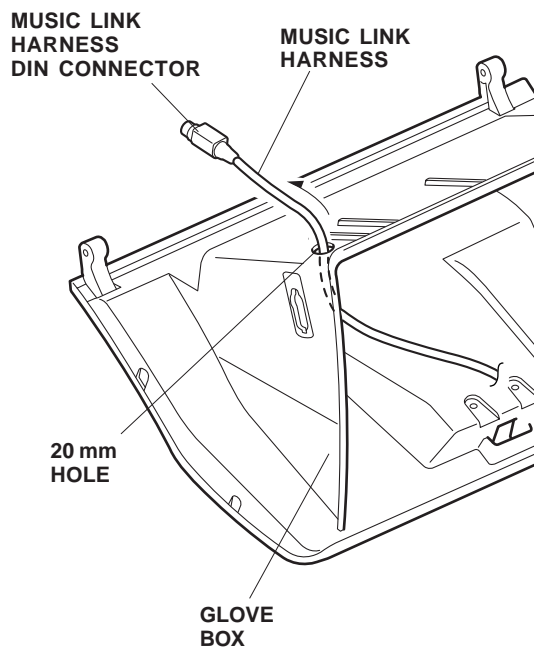

- Cut the grommet as shown. Attach the grommet to the Music Link harness, and seat the grommet into the 20 mm hole.

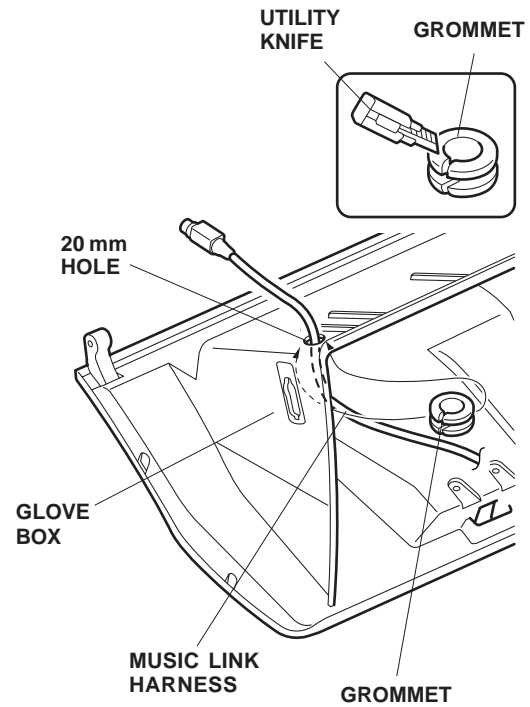

- Clean the vehicle pipe and vehicle bracket with isopropyl alcohol where the cushion tape will attach. Attach the tape to the vehicle pipe.

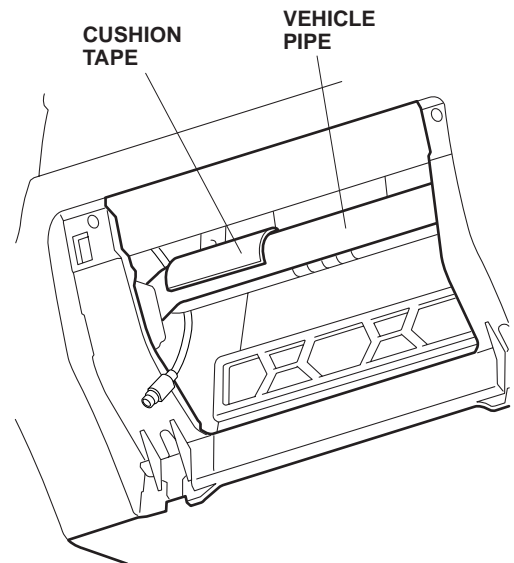

14. Insert the Music Link adapter unit into the unit cushion.

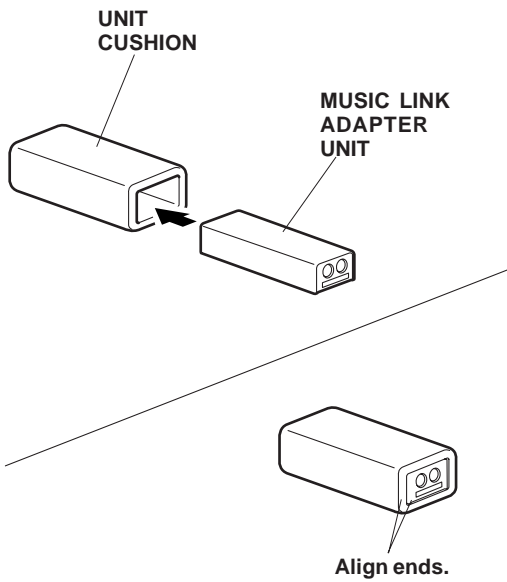

15. Route the Music Link harness through the glove box opening and connect the Music Link harness DIN connector (White) to the Music Link adapter assembly. Note the location of the connectors and the terminals.

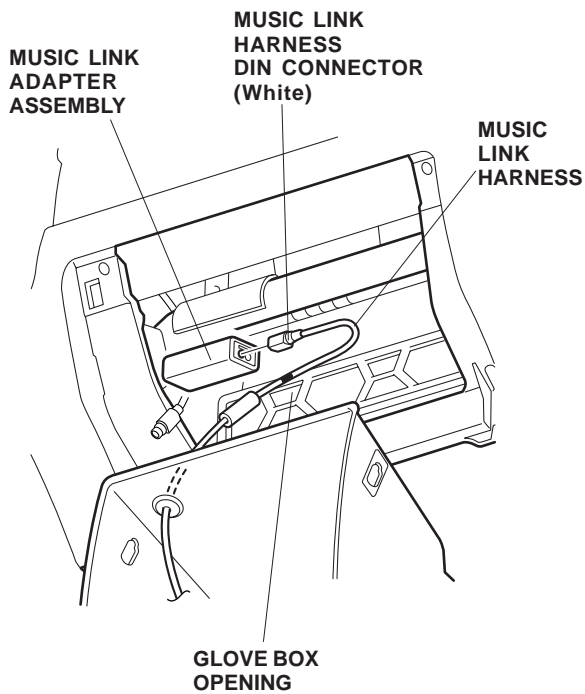

16. Bundle up the excess Music Link harness, and temporarily secure them and Music Link adapter assembly to the vehicle pipe with two long wire ties. (Align the mark scribed in the step 8 with the long wire tie as shown.)

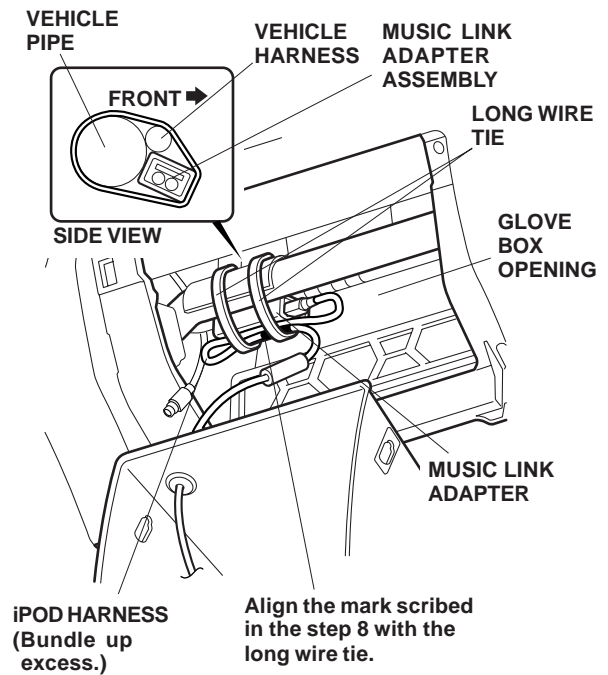

17. Route the bus cable through the two long wire ties temporarily secured in the step 16, and connect bus cable DIN connector (Black) to the Music Link adapter assembly. Note the location of the connectors and the terminals.

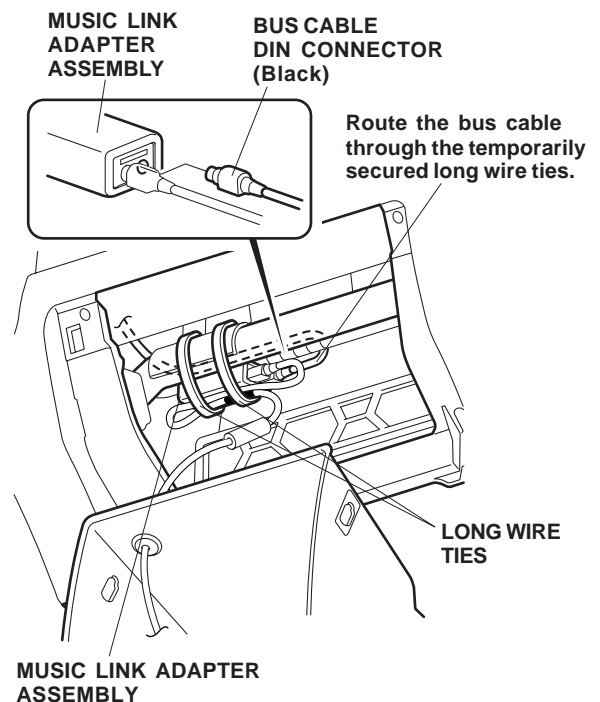

- Secure the bus cable to the vehicle harness with a wire tie.

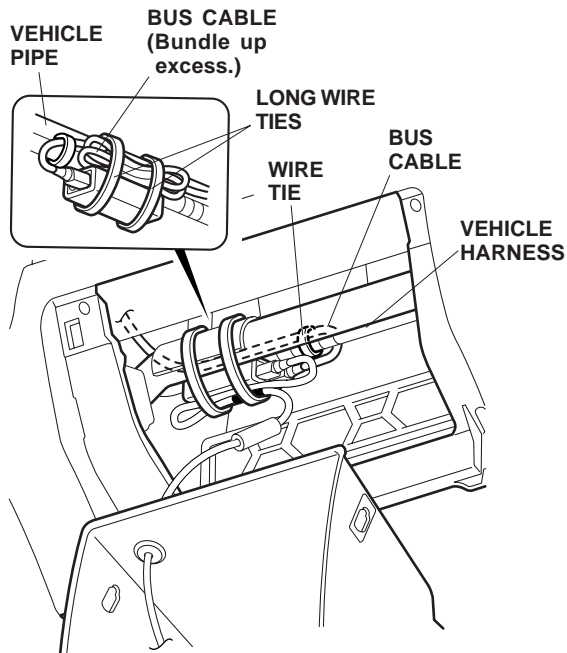

- Bundle up the excess bus cable, secure them to the vehicle pipe with the two long wire ties temporarily secured in step 16.

- Reinstall the glove box.

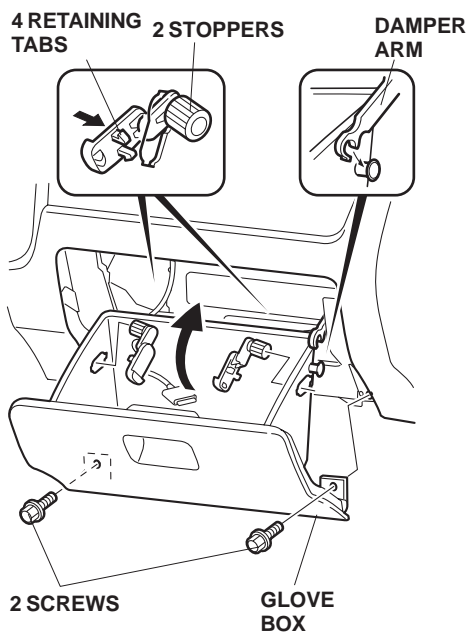

- Connect the vehicle connectors and bus cable 14-pin connector (or bus cable 2 port 14-pin connector) to the audio unit, and reinstall the audio unit.

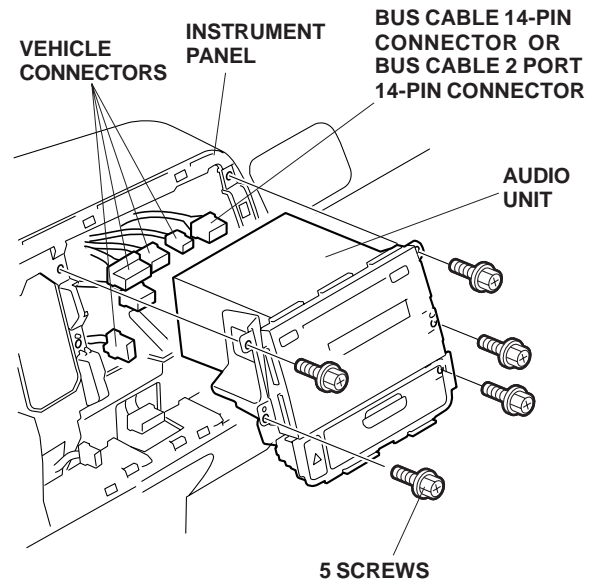

- Check that all wire harnesses are routed properly and all connectors are plugged in.
- Reconnect the negative cable to the battery.
- Enter the customer's radio anti-theft code, and reset the radio station presets and the clock.
- Reinstall all removed parts.
- Turn the audio unit ON. Check that "No Disc" is shown on the display while in the CD changer mode (the Music Link should be recognized as CD changer 4).

NOTE: Whenever the battery is disconnected, the driver's AUTO function is disable.

- Start the engine. Push down on the driver's window switch until the window is fully open.
- Pull up on the driver's window switch fully to close the window completely, then hold the switch for 2 seconds or more.
- Test the window AUTO function.