



INSTALLATION INSTRUCTIONS

Accessory
CARGO NET

Application
2007 FIT

Publications No.
All 32088
Issue Date
MAR 2006

Put this information in the glove box with the vehicle owner's manual.

PARTS LIST

Cargo net

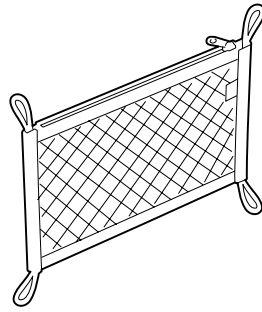

4 Snaps



2 Straps



INSTALLATION

NOTE: The cargo net can be installed in 2 different positions, horizontally or vertically.

1. Attach the four snaps onto the cargo net as shown.

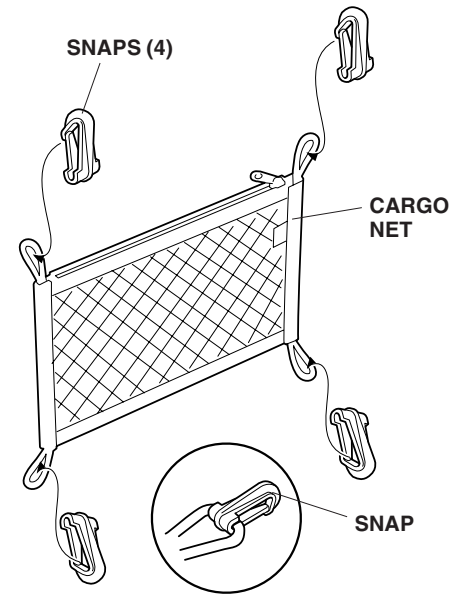

Installation in the Horizontal Position

2. Attach the snaps to the tie-down hooks in the trunk.

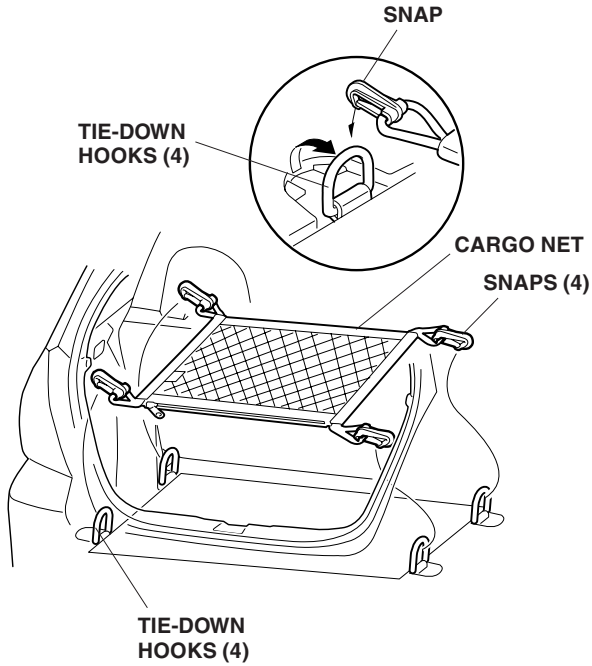

Installation in the Vertical Position

3. Remove the screws from the body. Attach the straps to the body with the screws.
4. Attach the snaps to the tie-down hooks and straps.

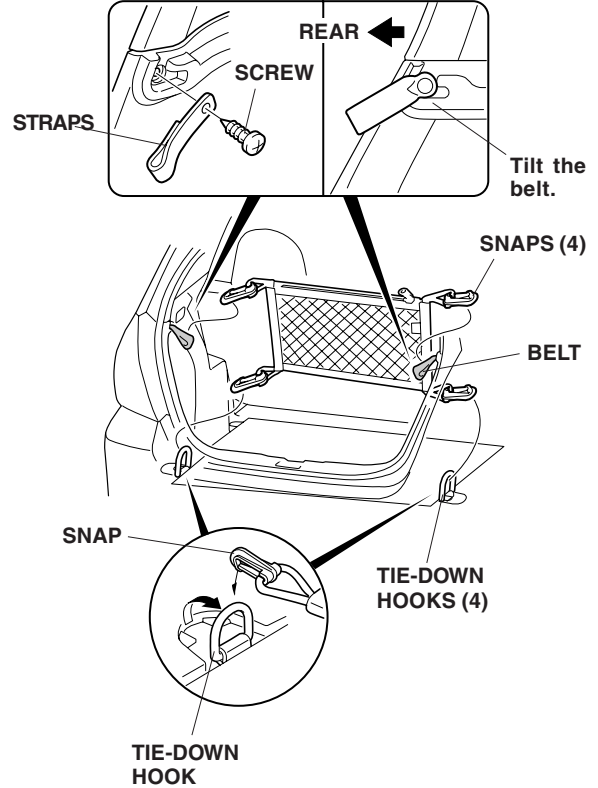

NOTE

- Do not store large or fragile objects in the net.
- Do not store objects with sharp edges or corners, as they may damage the cargo net or the vehicle. Wrap such objects in paper or a blanket so they will not contact the net directly.