



# INSTALLATION INSTRUCTIONS

Accessory

**CD CHANGER ATTACHMENT KIT**

Application

**2005 CIVIC SI**

Publications No.

**All 27936**

Issue Date

**AUG 2004**

## PARTS LIST

**CD Changer Attachment Kit (sold separately):  
P/N 08B26-S5T-100**

CD changer bracket

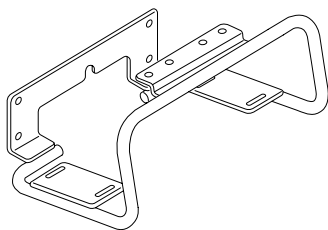

2 CD changer plates

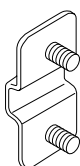

Template A

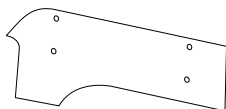

Left side bracket

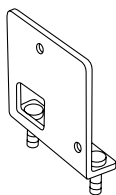

Right side bracket

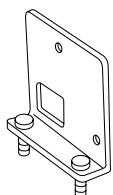

Bus cable

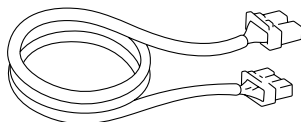

13 Wire ties

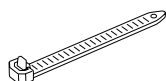

3 EPT seals

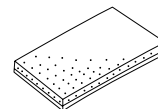

4 Cushion tapes

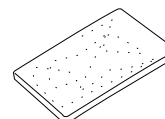

8 Cap nuts, 6 mm



4 Washer-screws, 4 x 8 mm



4 Clip-nuts, 6 mm



4 Stepped bolts, 6 mm



Template B

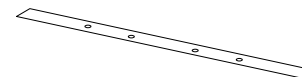

**6-Disc CD Changer (sold separately):  
P/N 08A26-1B1-100**

CD changer

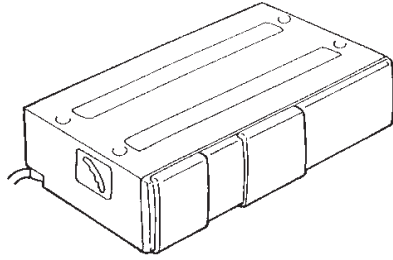

4 Washer-screws, 4 x 6 mm  
(Not used)



Adhesive seal sheet

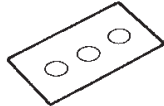

Cover plates



CD magazine

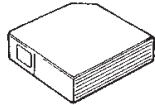

Owner's Manual

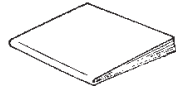

**TOOLS AND SUPPLIES REQUIRED**

- Phillips screwdriver
- Flat-tip screwdriver
- Shop towel
- 10 mm Combination wrench
- Stubby Phillips screwdriver
- Diagonal cutters
- Utility knife
- Safety goggles
- Pushpin
- Drill
- 3 mm, 7.5 mm, and 10 mm Drill bits
- Uni-bit 30 mm
- Awl
- Masking tape
- Electrical tape or drill stop
- Isopropyl alcohol

**Illustration of the CD Changer Installed in the Vehicle**

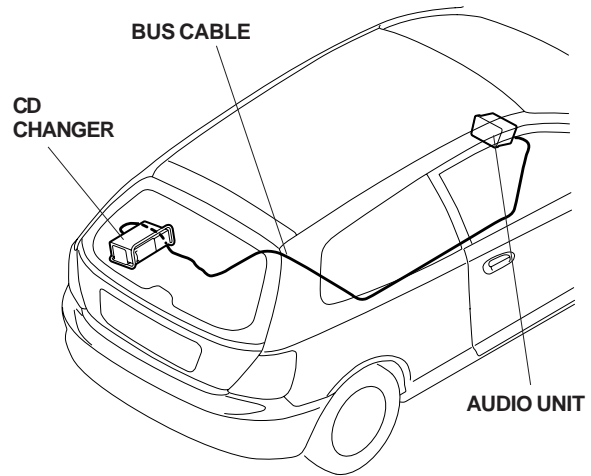

**INSTALLATION**

**Customer Information:** The information in this installation instruction is intended for use only by skilled technicians who have the proper tools, equipment, and training to correctly and safely add equipment to your vehicle. These procedures should not be attempted by "do-it-yourselfers."

1. Make sure you have the anti-theft code for the radio, then write down the radio station presets.
2. Disconnect the negative cable from the battery.
3. Open the glove box. Lower the glove box by releasing the right and left glove box stops.

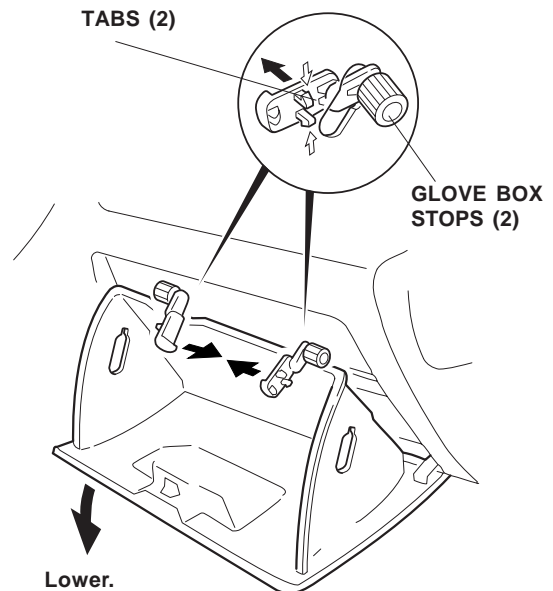

- Remove the driver's dashboard lower cover. Turn the lock knob 90° counterclockwise. Gently pull down on the left side of the cover to release the two hooks, then pull down on the cover to release the three retaining tabs. Take care not to damage the retaining tabs.

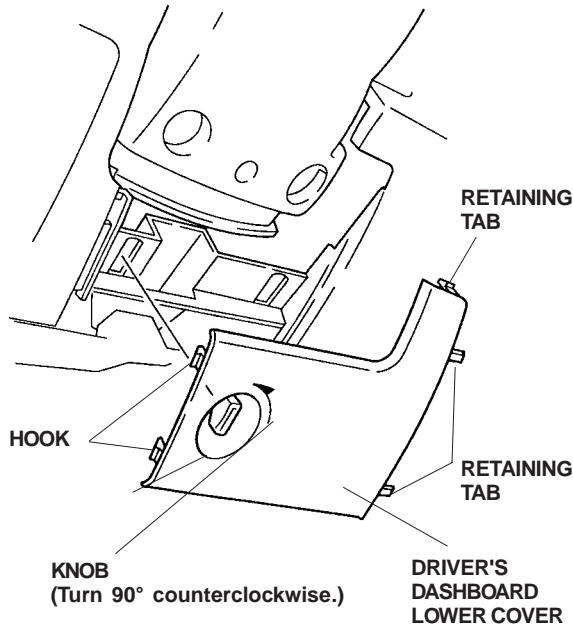

- Remove the driver's dashboard under cover. Turn the lock knob 90° counterclockwise, and pull down on the rear of the cover to release the left clip. Pull the cover out toward you to release the remaining clip. Take care not to damage the clips.

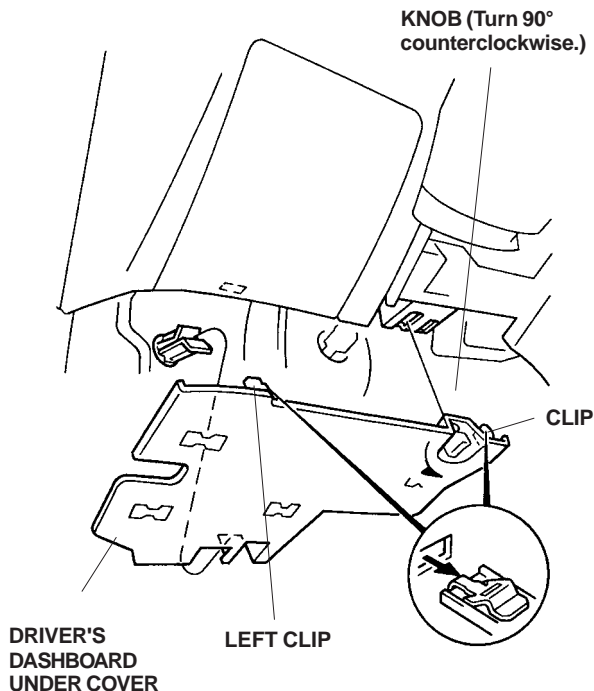

- Remove the shift lever trim:

- Pull the shift boot down, and remove the shift knob by turning it counterclockwise.
- Reach through the shift boot, and gently pull out on the shift lever trim to release the bottom of the trim. Lift up on the shift lever trim to release the five hooks and four clips.
- Unplug the hazard warning switch connector, and remove the shift lever trim.

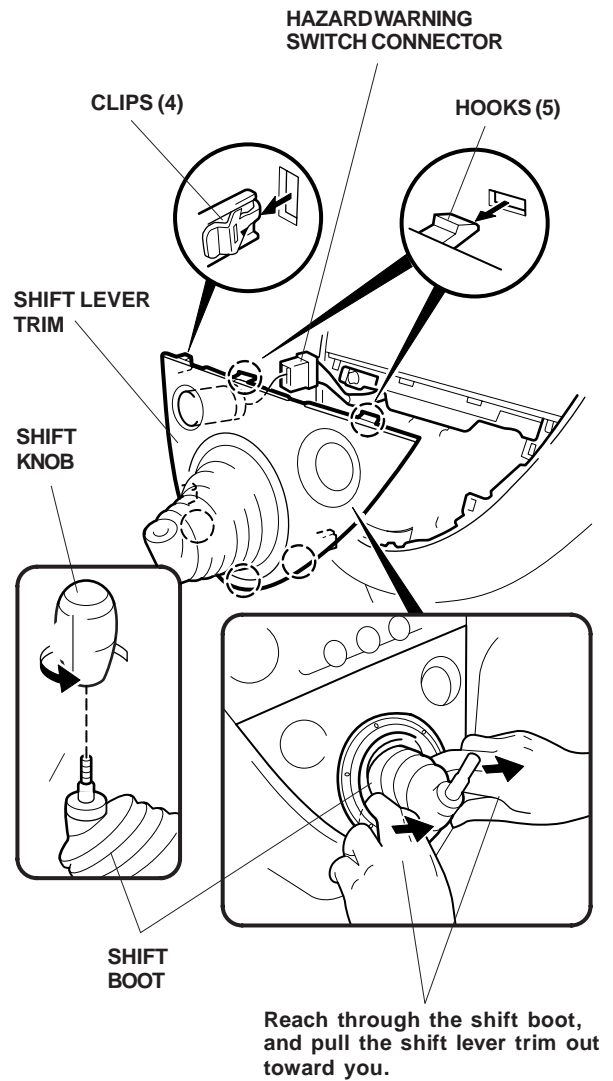

- Remove the vehicle harness clip from the center panel bracket by pushing up on the locking tab on the clip and pulling the clip out toward you.

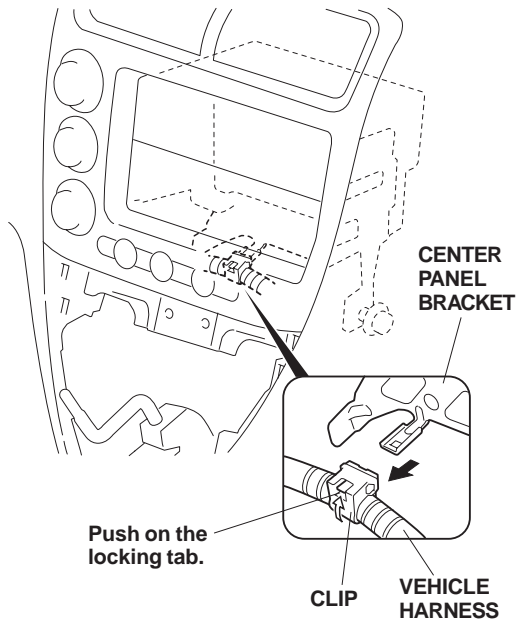

- Reach through the glove box area, and loosen the bolt that secures the center panel. Reach through the area near the steering wheel, and loosen the bolt that secures the center panel. Remove the center panel (eight clips, and unplug the connectors).

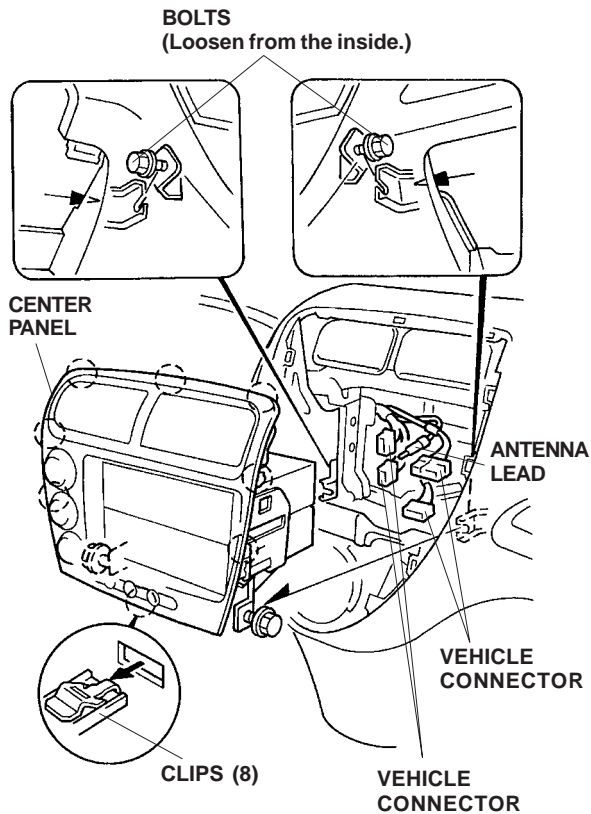

- Remove the dashboard center lower cover, and disconnect the accessory power socket connector. Remove the two self-tapping screws from the back of the front center console.

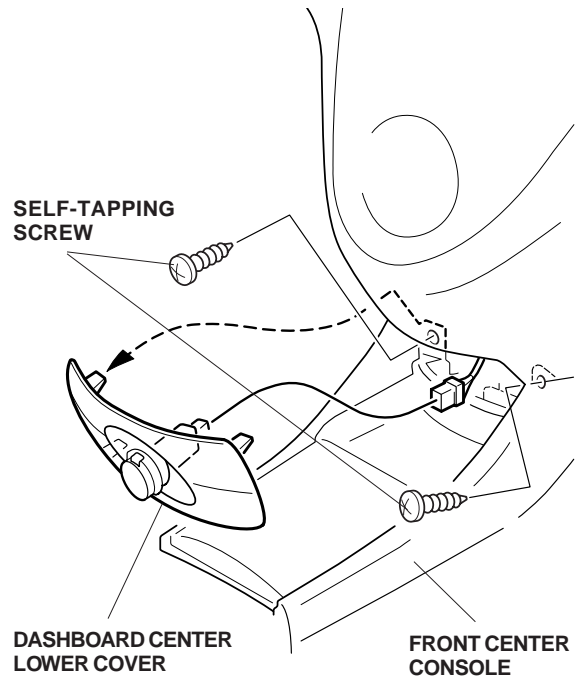

- Slide the front seat completely forward. Remove the rear center console (two washer-screws, two clips, and two retaining tabs). Take care not to damage the clips and retaining tabs.

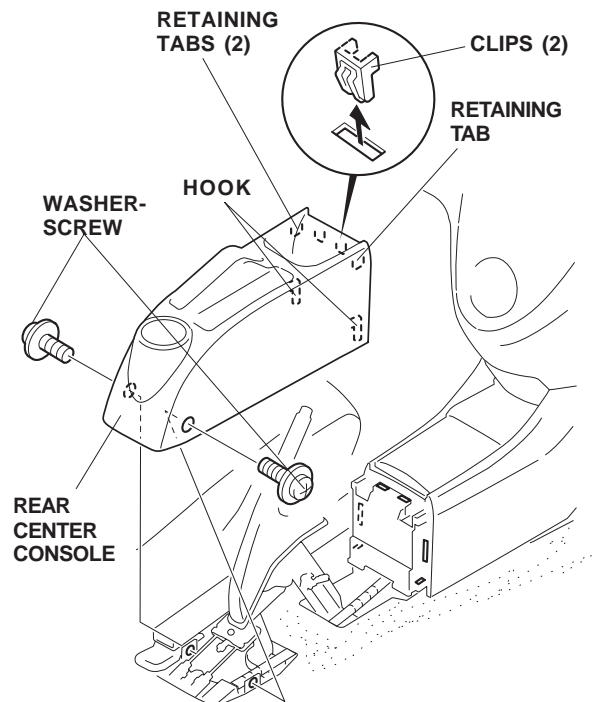

11. Remove the front center console:

- Slide the front seat completely rearward.
- Open the lid, and take out the console box mat.
- Remove the two bolts from the inside of the pocket.
- Remove the two clips, then slide the front center console to the rear to release the four retaining tabs. Take care not to damage the retaining tabs.

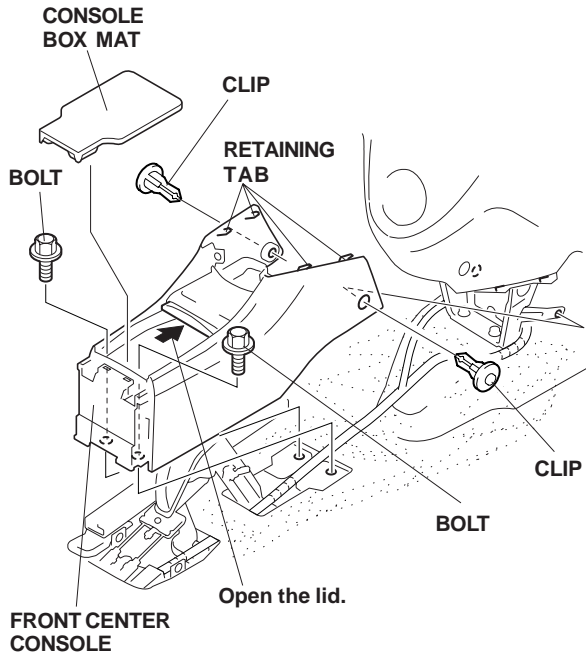

12. Open the hatch, and remove the center shelf.

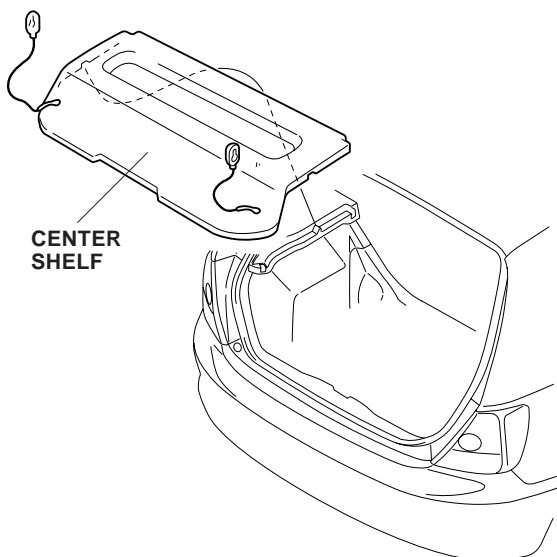

13. Turn over the cargo area mat, and remove the cargo area floor.

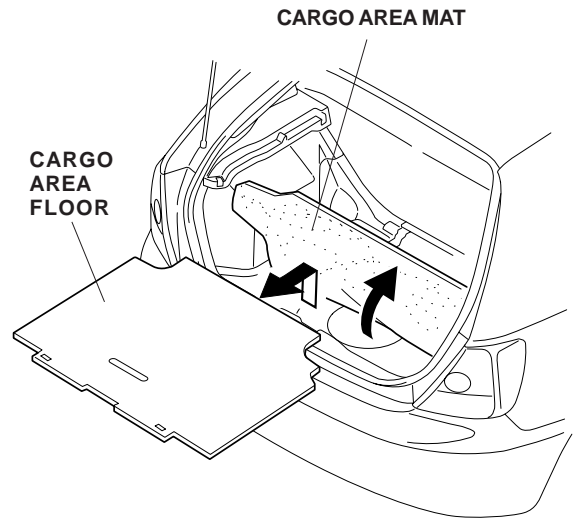

14. Remove the cargo area mat (three clips).

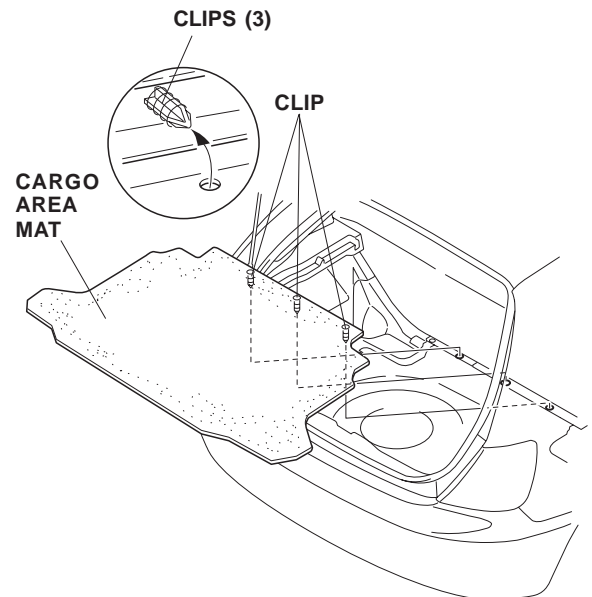

- Remove the rear seat cushion bolt, and remove the rear seat cushion by lifting the rear of the cushion to release the hooks and then pulling it toward you.

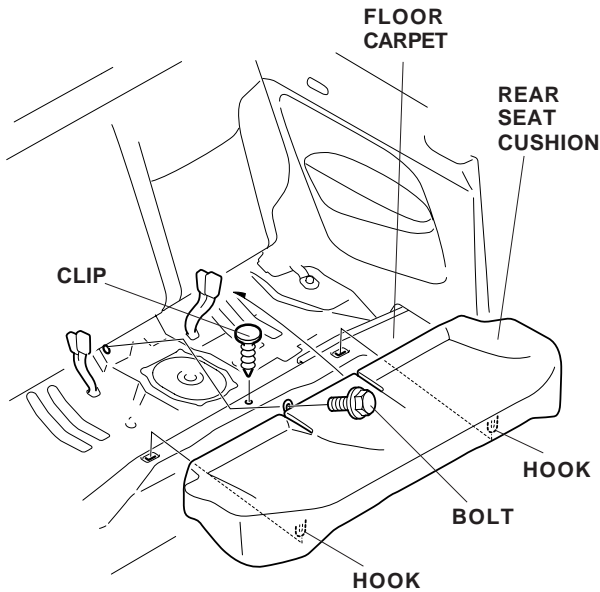

- Remove the clip that secures the floor carpet.
- Fold the right rear seat-back forward. Remove the hinge cover from the seat-back (three retaining clips). Take care not to damage the retaining clips.

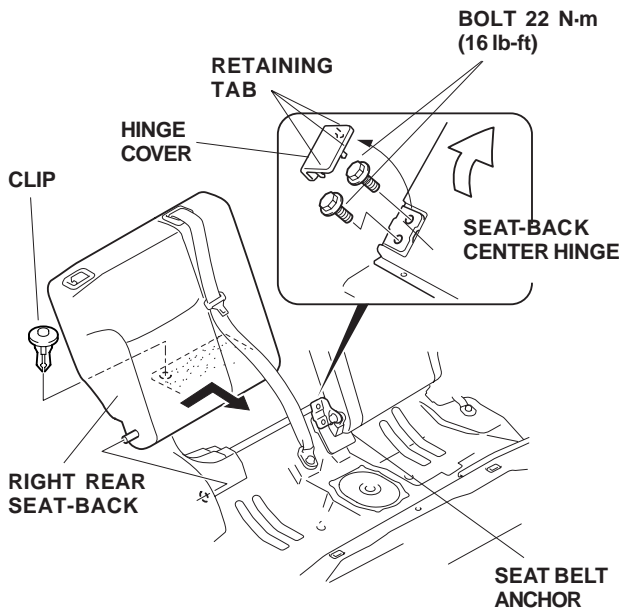

- Remove the clip from the floor panel behind the seat-back.
- Remove the two bolts that fasten the seat-back hinge bracket, and move the right rear seat-back out of the way.

- Remove the left rear seat-back center hinge (one bolt).

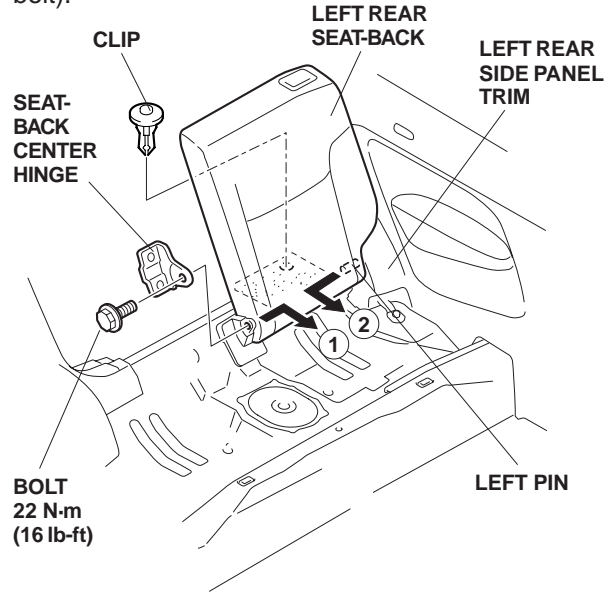

- Remove the clip from the floor panel behind the seat-back.
- Release the seat-back pin from the left rear side panel trim by sliding the seat-back forward while pushing it toward the outside. Remove the left rear seat-back.
- Open the screw lid from the left rear side shelf. Remove the two self-tapping screws, and separate the left rear side shelf from the C-pillar trim. Push down to release the rear clip hooks, then pull the shelf out toward you to remove it.

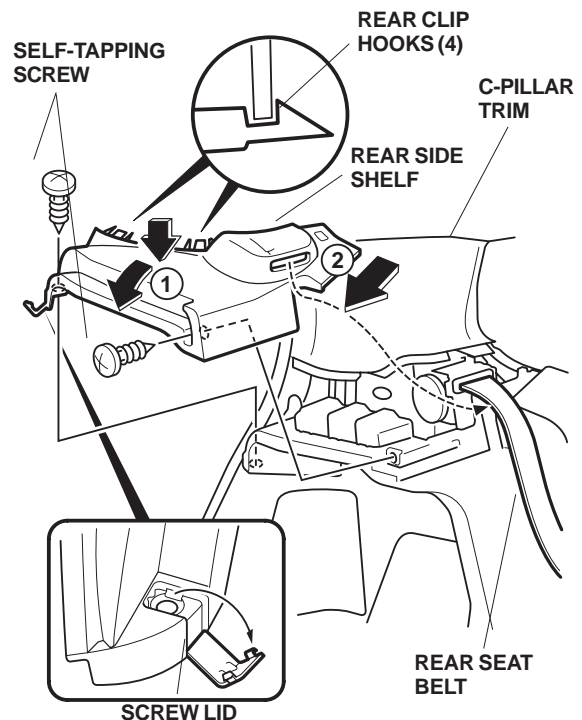



24. Remove the left rear bulkhead cover:

- Remove the clip from the left rear bulkhead cover. Take care not to damage the clip.
- Gently pry the left rear bulkhead cover away from the left rear side trim panel by inserting the end of a flat-tip screwdriver wrapped in a shop towel into the groove of the left rear bulkhead cover.
- Pry up on the seven retaining tabs, and remove the left rear bulkhead cover. Take care not to damage the retaining tabs.

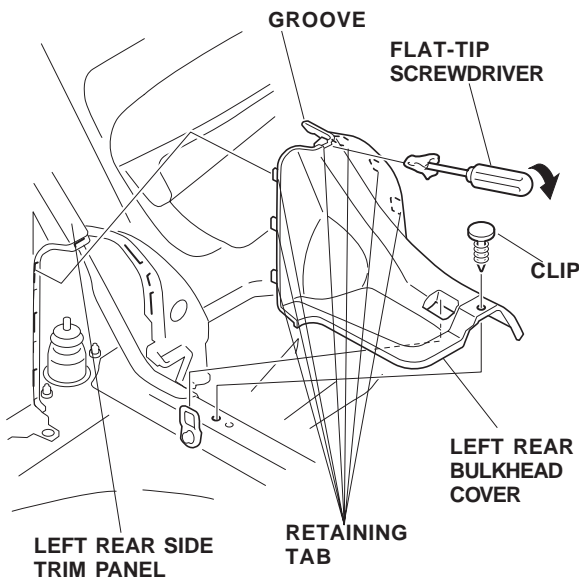

25. Remove the clip that fastens the left rear side trim panel. Take care not to damage the clip.

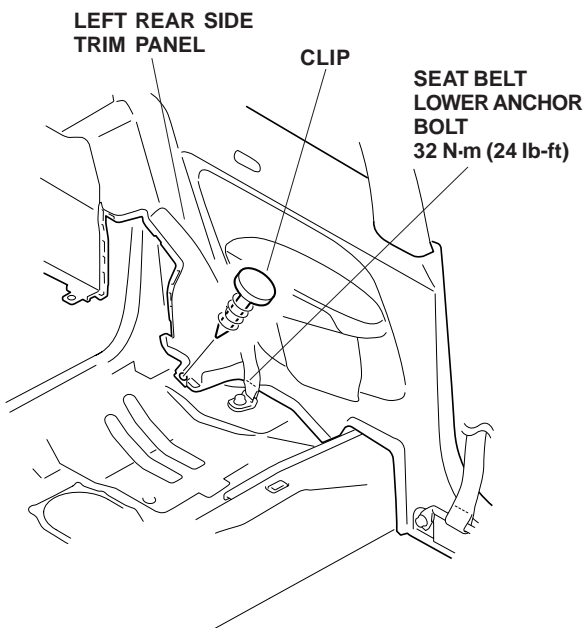

26. Remove the left rear seat belt lower anchor bolt.

27. Remove the rear trim panel (three clips and two hooks).

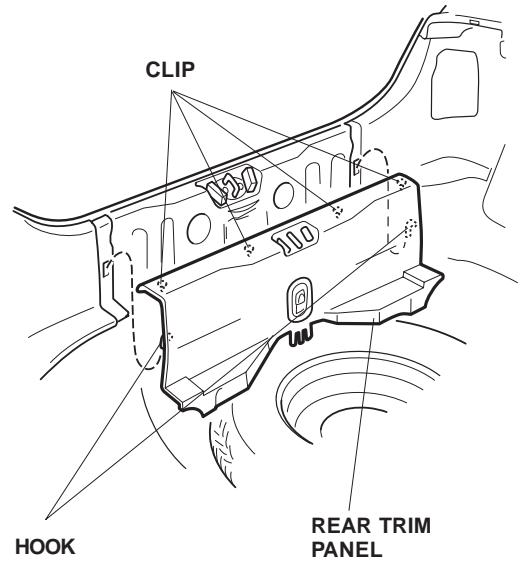

28. Remove the two upper screws and the rear lower clip from the left rear side trim panel.

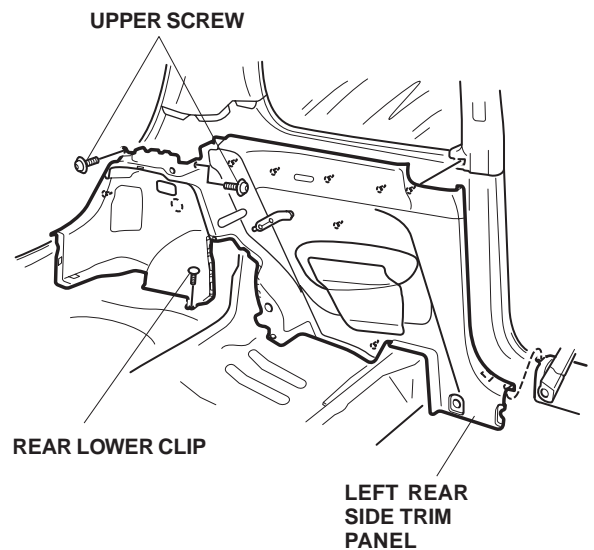

29. Carefully pull the left rear side trim panel away from the body without creasing it.

30. Get template A from the kit. Tape the template to the left rear side trim panel in the area shown, and tape it in place using strips of masking tape. Using a pushpin, mark the trim panel at each of the five marked points on the template. Remove template A.

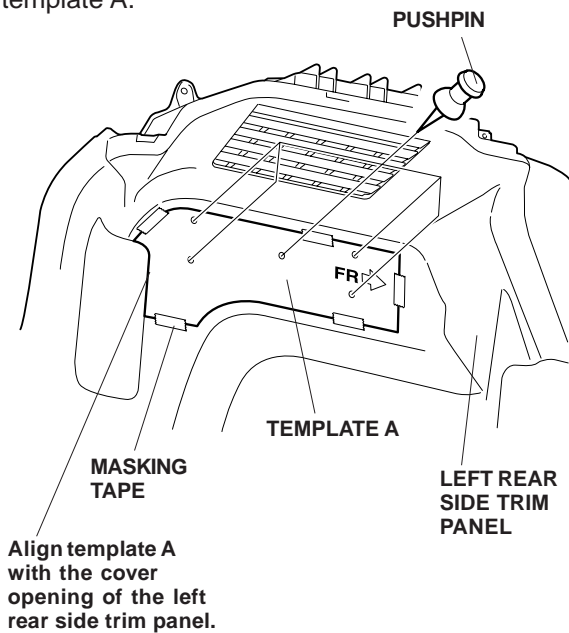

31. While wearing eye protection, drill a 7.5 mm hole through each of the five marks on the trim panel. First drill with a 3 mm bit, then finish with a 7.5 mm bit. Wrap electrical tape 10 mm from the end of the drill bit, or use a drill stop.

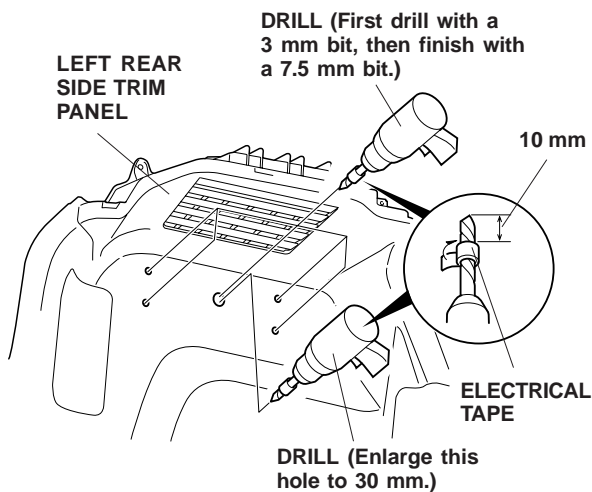

32. Expand the center 7.5 mm hole to 30 mm with a 30 mm Uni-bit.

33. Position template B on the air outlet area of the left rear side trim panel, and tape it in place using strips of masking tape. Using a pushpin, mark the trim panel at each of the four marked points on the template. Remove template B.

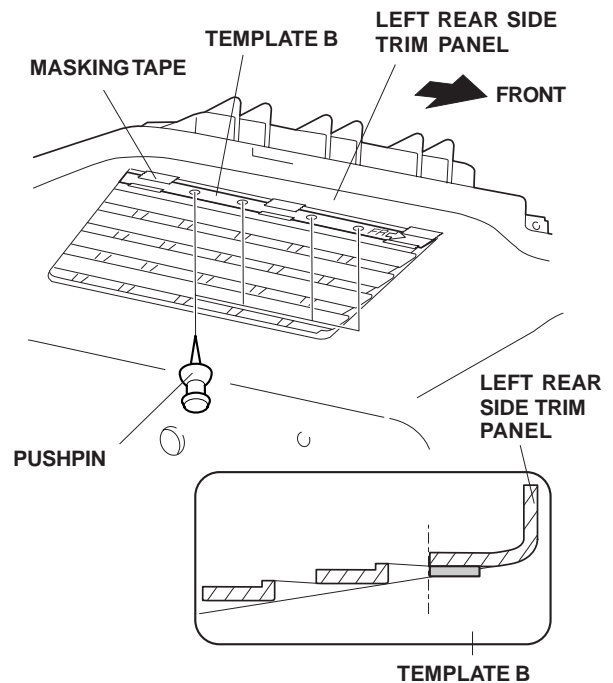

34. While wearing eye protection, drill a 10 mm hole through the left rear side trim panel at each of the four marks you just made. First drill with a 3 mm drill bit, then finish with a 10 mm drill bit. Wrap electrical tape 10 mm from the end of the drill bit, or use a drill stop.

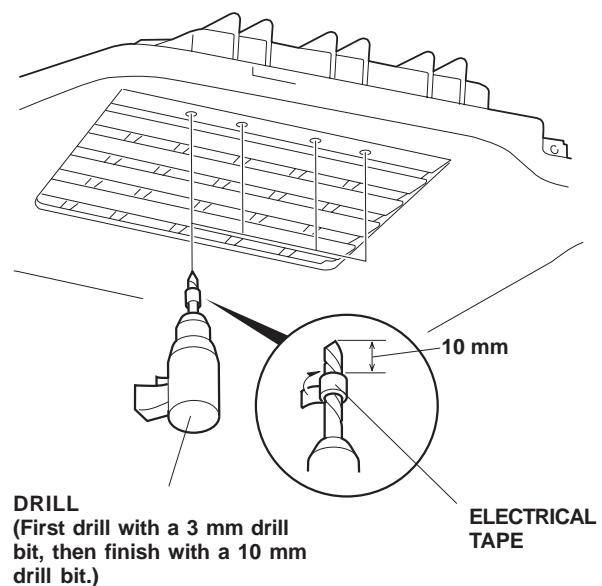



35. Slide the four 6 mm clip nuts onto the left rear side trim panel through the 10 mm holes you just made.

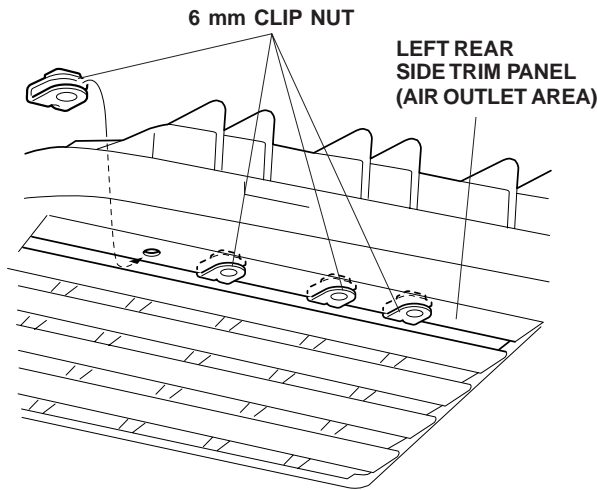

36. Using scissors, cut 1/4 piece from one of the EPT seals. Wrap the other two EPT seals and the 1/4 piece of the EPT seal around the bus cable in the areas shown.

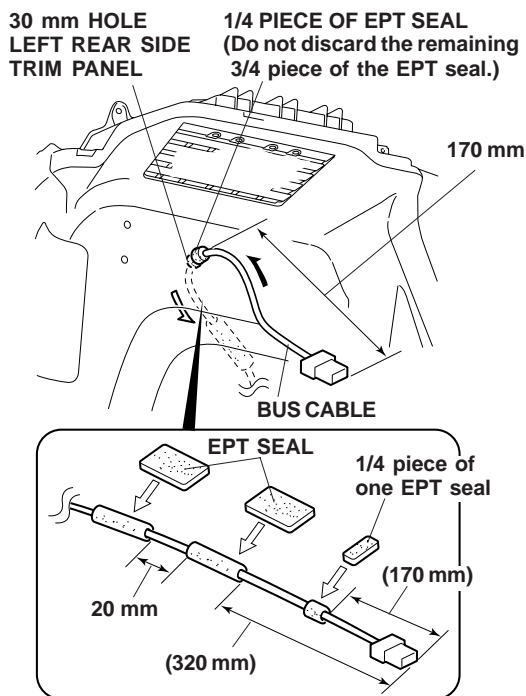

37. Align the 1/4 piece of the EPT seal you cut in step 36 with the 30 mm hole you drilled in step 32.

38. Insert the studs of the two CD changer plates into the 7.5 mm holes (made in step 31) from the back.

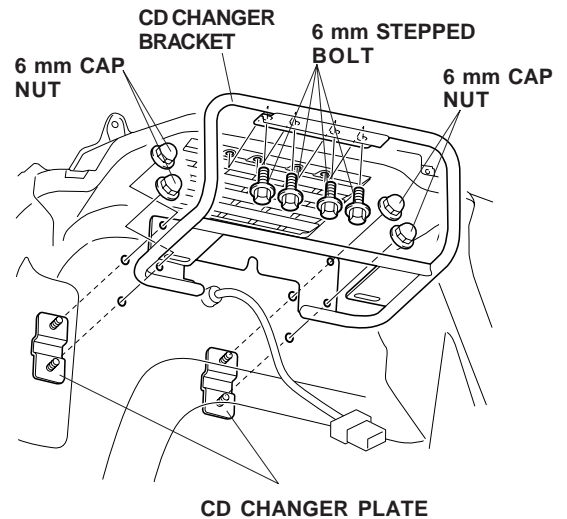

39. Insert the studs of the CD changer plate into the holes in the CD changer bracket, and install a 6 mm cap nut on the end of each stud. Do not tighten the 6 mm cap nuts yet.
40. Temporarily secure the top of the CD changer bracket to the rear side lining with the four 6 mm stepped bolts, then tighten the four cap nuts and the four stepped bolts securely.

### Installing the CD Changer

41. Carefully unpack the CD changer. Remove the three shipping clips, and discard the shipping cover. Install an adhesive seal (included with the CD changer kit) over each of the three clip holes. Retain the shipping clips in case the unit needs to be serviced.

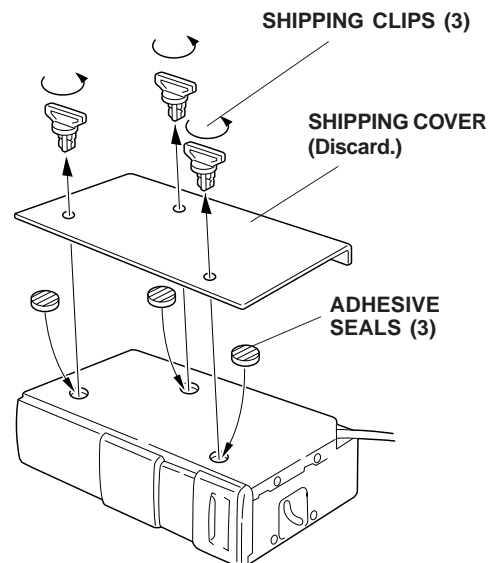

42. Visually check the position of the spring adjusting pins on both sides of the CD changer. If both of the spring adjusting pins are not in the horizontal (H) position, move the pins to the horizontal (H) position by sliding them up with an awl.

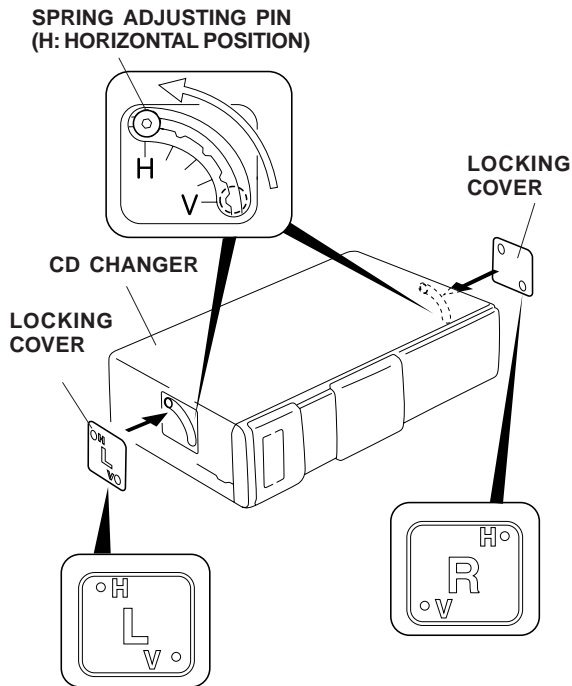

43. Remove the backing from the "L" and "R" locking covers, and attach them to the sides of the CD changer. Align the diagonally opposite holes with the H and V positions.
44. Position the side brackets on the CD changer, and install the four washer-screws supplied with the CD Changer Attachment Kit. Note the direction of the side brackets. The square hole in each of the brackets should face the rear of the CD changer. Tighten the washer-screws securely.

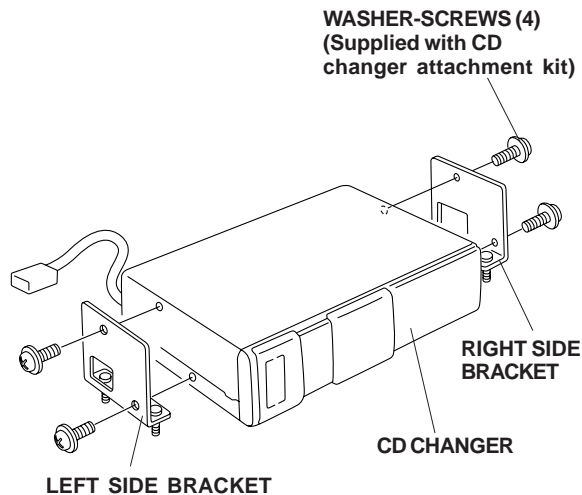

45. Secure the CD changer bus cable connector to the CD changer with the remaining 3/4 piece of the EPT seal cut in step 36.

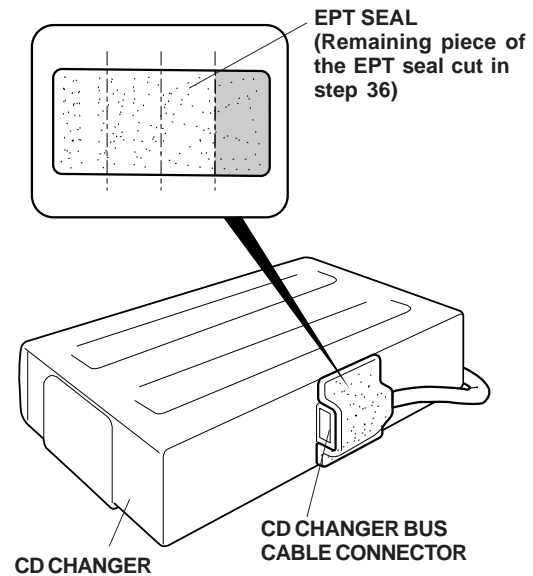

46. Connect the bus cable connector to the CD changer bus cable connector.
47. Insert the studs of the right and left side brackets installed on the CD changer into the holes in the CD changer bracket, and install a cap nut on the end of each stud. Tighten the cap nuts securely.

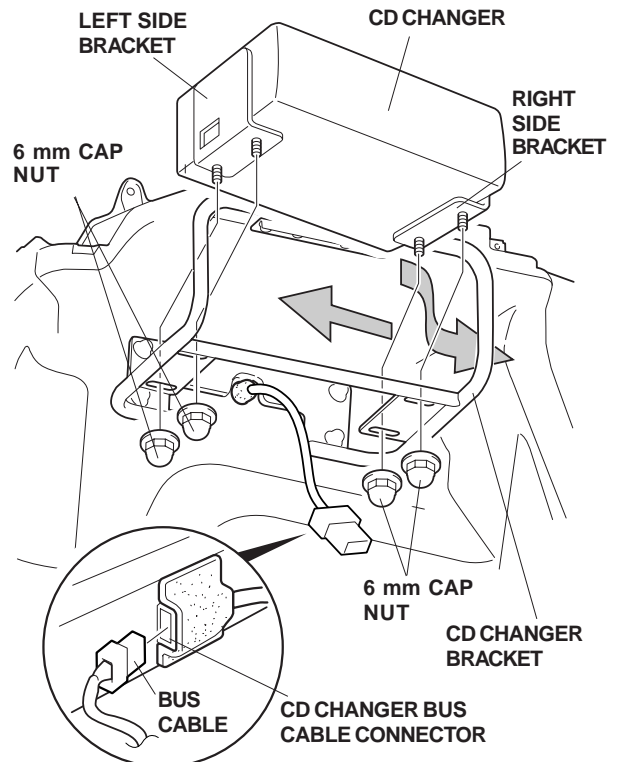

## Routing the Bus Cable

48. From the back of the left rear side trim panel, route the bus cable as shown. Secure the bus cable to the fuel fill door opener cable with two wire ties in the areas shown. Do not secure the bus cable to the clear washer tube.

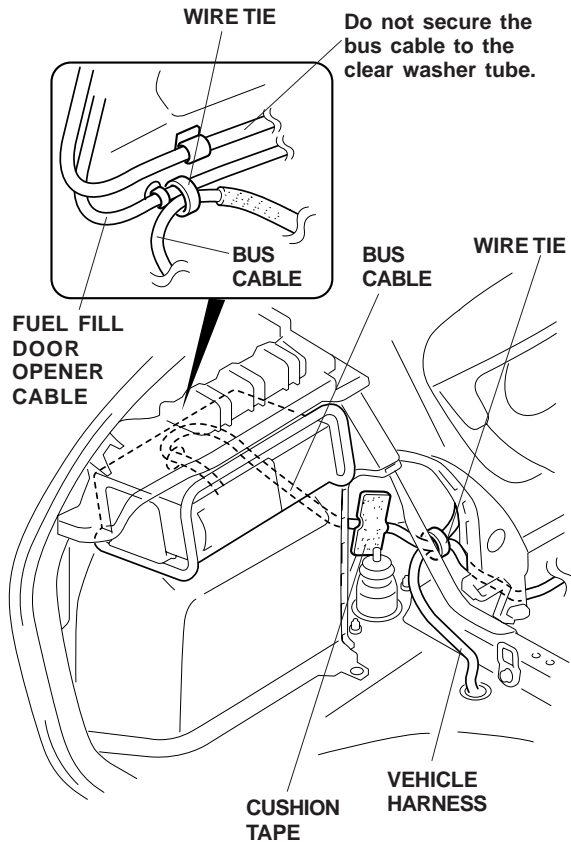

49. Secure the bus cable to the body panel with one cushion tape in the area shown. Clean the area where the cushion tape will attach with isopropyl alcohol.

50. Route the bus cable from the side panel to the center of the floor panel along the floor cross member as shown.

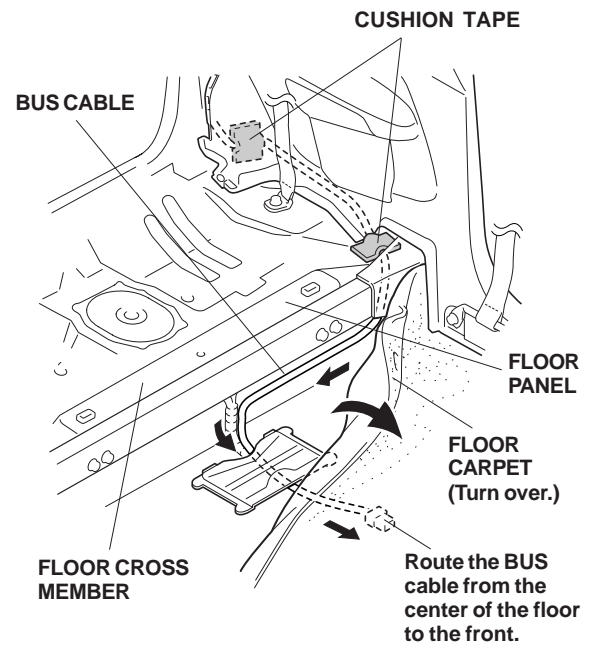

51. Secure the bus cable to the floor panel with two cushion tapes in the areas shown. Clean the areas where the cushion tapes will attach with isopropyl alcohol.
52. Continue routing the bus cable through the center of the floor panel to the center panel opening.

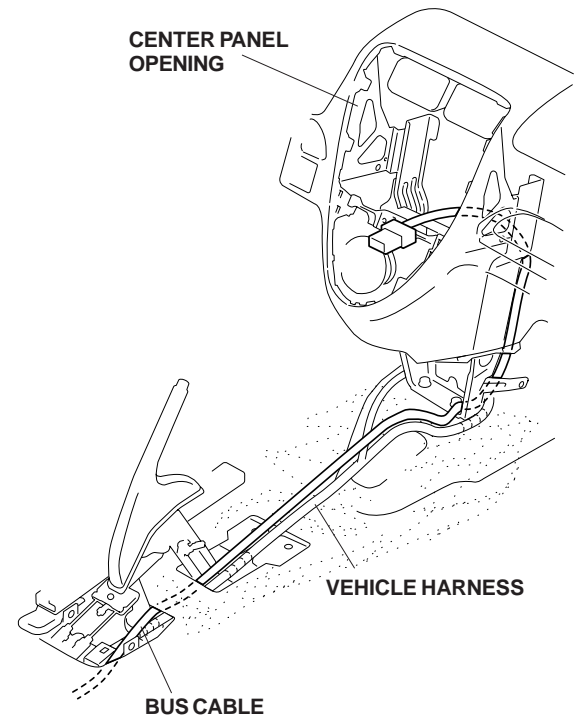

53. Route the bus cable so that its connector is about 50 mm farther than the vehicle 20-pin connector. Secure the bus cable to the vehicle harness with two wires in the areas shown.

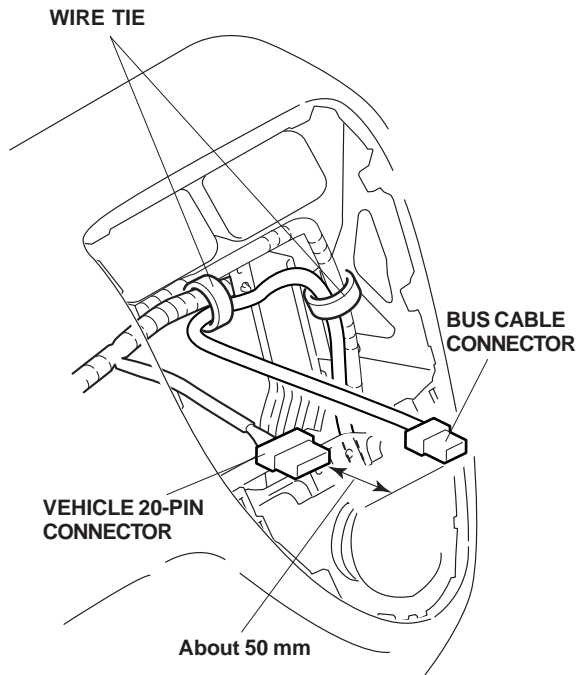

54. Secure the bus cable to the vehicle harness with two wire ties in the areas shown.

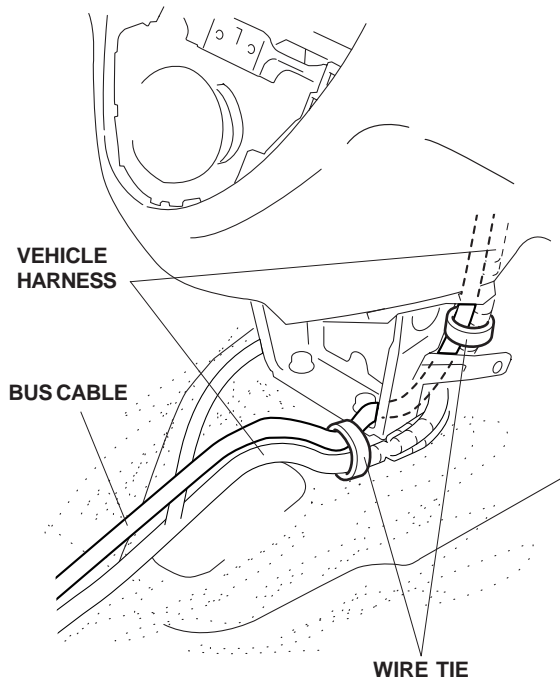

55. Near the parking brake lever, secure the bus cable to the vehicle harness with three wire ties in the areas shown.

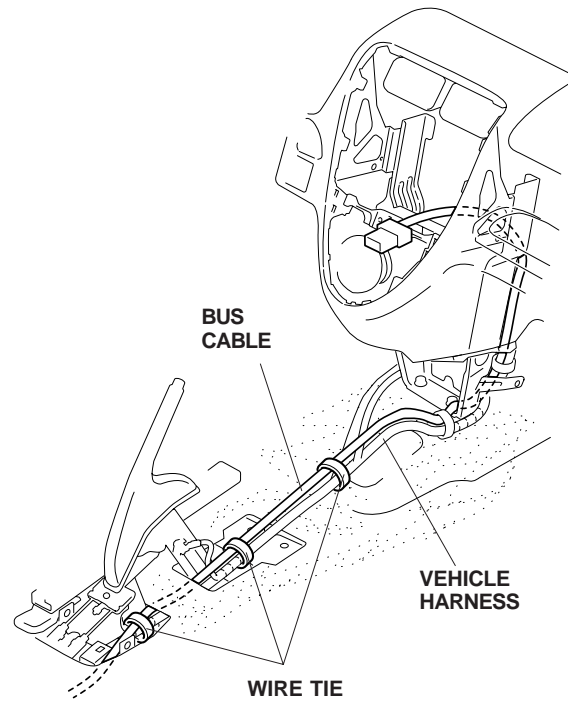

56. Loop the excess bus cable at the floor cross member, and secure it to the vehicle harness with four wire ties and one cushion tape. Clean the area where the cushion tape will attach with isopropyl alcohol.

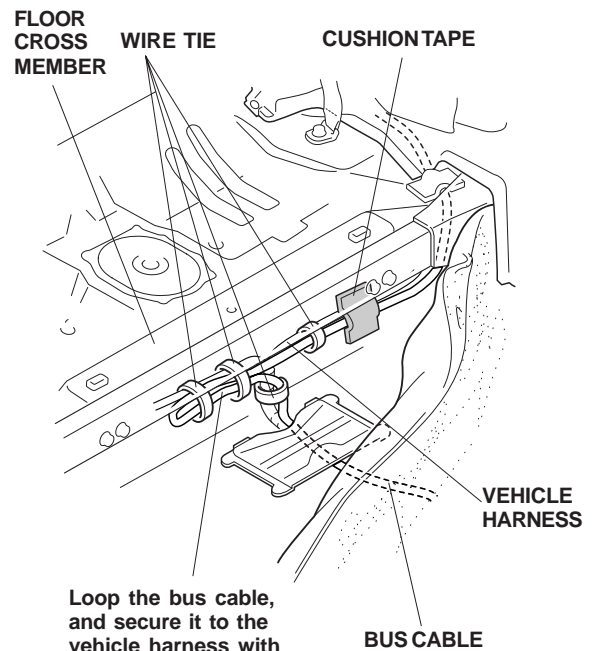

Loop the bus cable, and secure it to the vehicle harness with four wire ties and one cushion tape.

## Installing the Center Panel/Radio Unit

57. Check that the vehicle harnesses are not pinched by the stays.

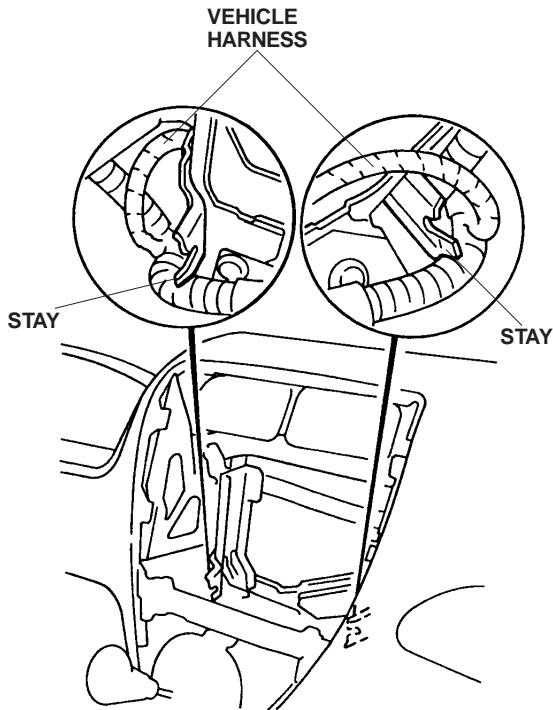

58. While holding the center panel with the radio unit installed near the center panel opening, plug the vehicle 20-pin connector, the antenna lead, the heater control harness connector, and the bus cable connector into the rear of the radio unit.

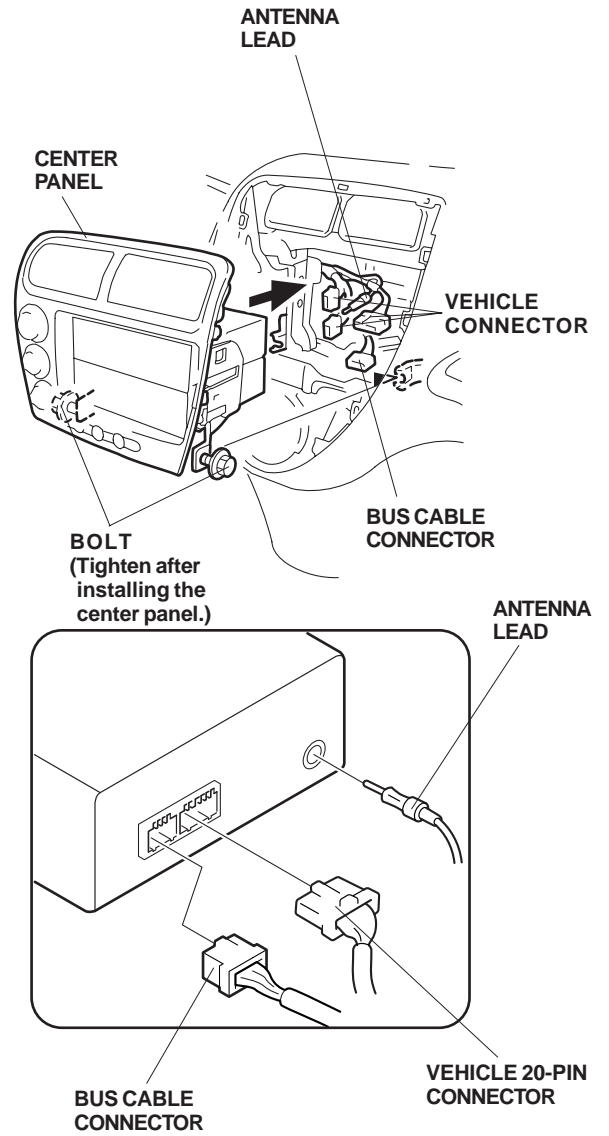

59. Reinstall the center panel.

60. Check that all wire harnesses are routed properly and all connectors are plugged in.
61. Reconnect the negative cable to the battery, and set the clock.
62. Enter the customer's radio anti-theft code, and reset the radio station presets.
63. Check the operation of the CD changer according to the Owner's Manual.
64. Put the CD changer Owner's Manual and the shipping clips retained in step 41 in the glove box.
65. Reinstall all removed parts.
66. Do the engine control module (ECM) idle learn procedure:
  - Make sure all electrical items (A/C, audio, rear defogger, lights, etc.) are off.
  - Start the engine. Hold the engine speed at 3,000 rpm with no load (in Park or Neutral) until the radiator fan comes on.
  - Let the engine idle for 5 minutes with the throttle fully closed and all electrical items off.

NOTE: When the radiator fan comes on, do not include its running time in the 5 minutes.