



INSTALLATION INSTRUCTIONS

Accessory

FRONT GRILLE TRIM
P/N 08P01-S9A-100

Application

2004CR-V

Publications No.

All 26126

Issue Date

SEP 2003

PARTS LIST

Front grille trim

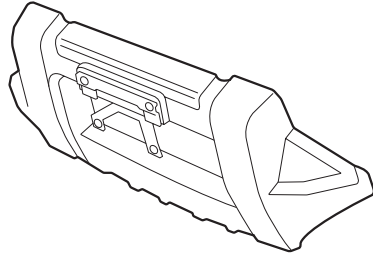

5 Plastic covers



8 Screws



8 Washers



Washer-nut



4 Washer-bolts



TOOLS AND SUPPLIES REQUIRED

Phillips screwdriver

Flat-tip screwdriver

Ratchet

10 mm Socket

Drill

3 mm and 8 mm Drill bits

Blanket

Isopropyl alcohol

Shop towel

Eye protection (face shield, safety goggles, etc.)

File

Center punch

INSTALLATION

Customer Information: The information in this installation instruction is intended for use only by skilled technicians who have the proper tools, equipment, and training to correctly and safely add equipment to your vehicle. These procedures should not be attempted by "do-it-yourselfers."

NOTE: Be careful not to damage the body paint finish.

1. Remove the front license plate (four self-tapping screws), then remove and discard the two clip nuts.

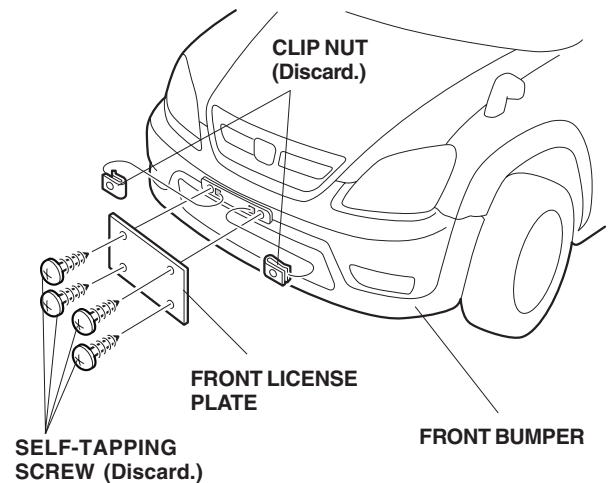

2. Remove the brackets from the front bumper (one bolt). Set the bolt and the brackets aside; they will not be reused.

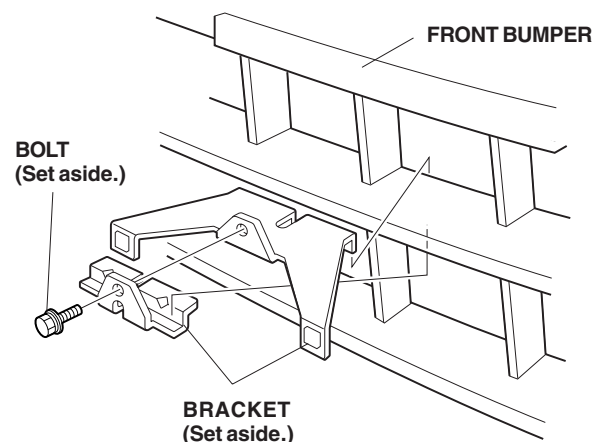

- Open the hood. Remove the radiator cover (seven clips and one bolt).

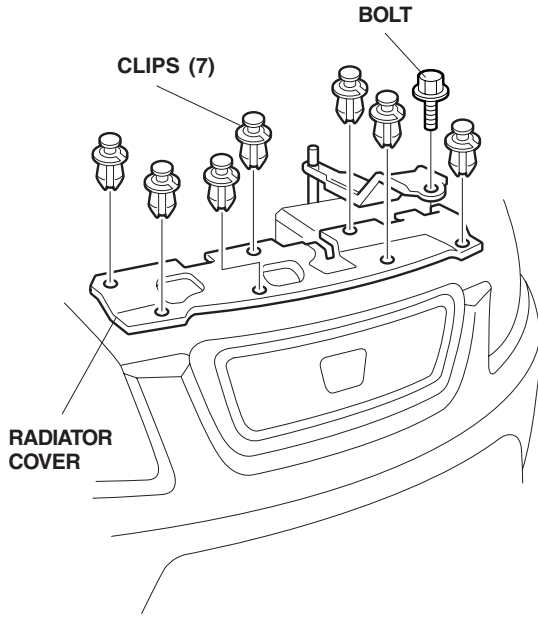

- Remove the four clips, four bolts and two self-tapping screws that fasten the front bumper. If equipped, unplug the fog light connectors, remove the front bumper, and set it on a blanket to install the front grille trim.

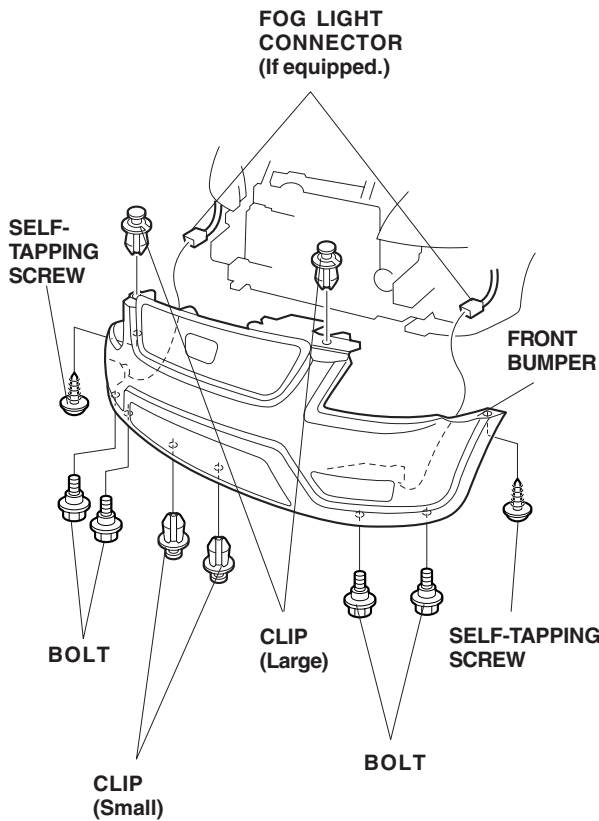

- On the inside of the front bumper, locate the nine marks. Center-punch each mark.

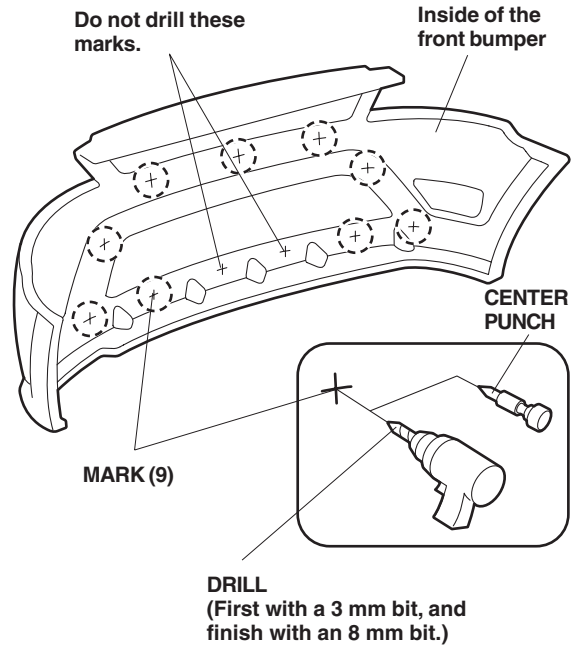

- While wearing eye protection, drill an 8 mm hole through each of the center-punched marks:
 - First drill with a 3 mm bit and finish with an 8 mm bit.
 - File any burrs off of the holes.
- Position the front grille trim on the bumper, and insert the upper stud into the center hole in the front bumper.

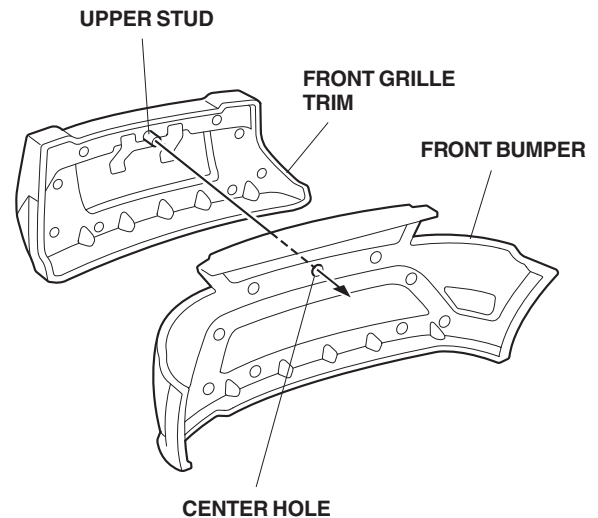

- Install the washer-nut on the end of the upper stud. Insert one screw with washer through each of the remaining eight holes and into the front grille trim. Tighten all screws and the washer-nut securely. Torque the washer-nut to 8.8 N·m (6.5 lb-ft).

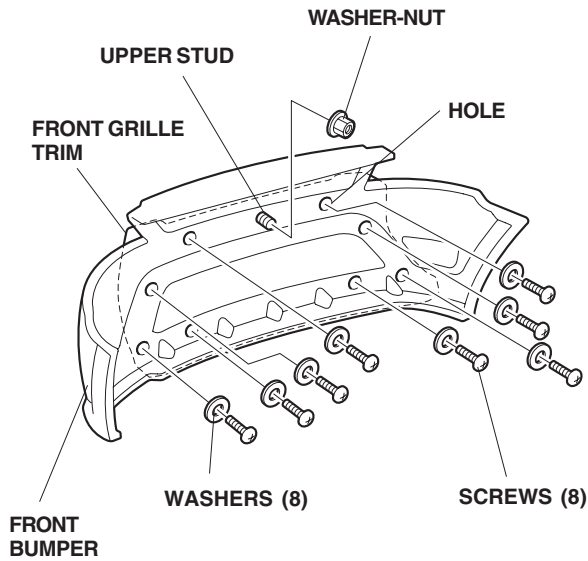

- Reinstall the front bumper. If equipped, plug in the fog light connectors. Install the license plate on the front grille trim with the four washer-bolts.

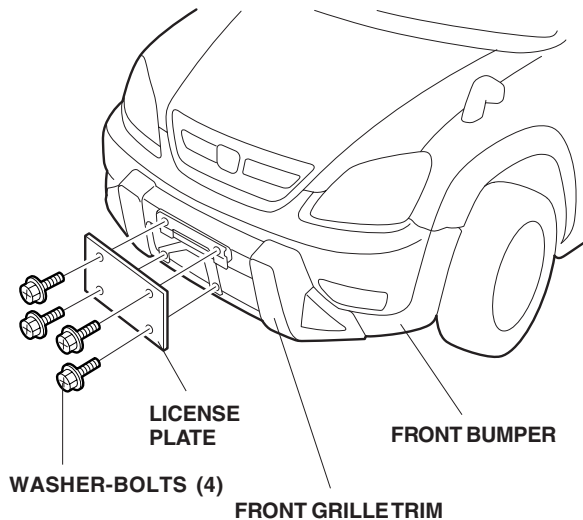

- Using isopropyl alcohol on a shop towel, clean the areas where the plastic covers will attach.

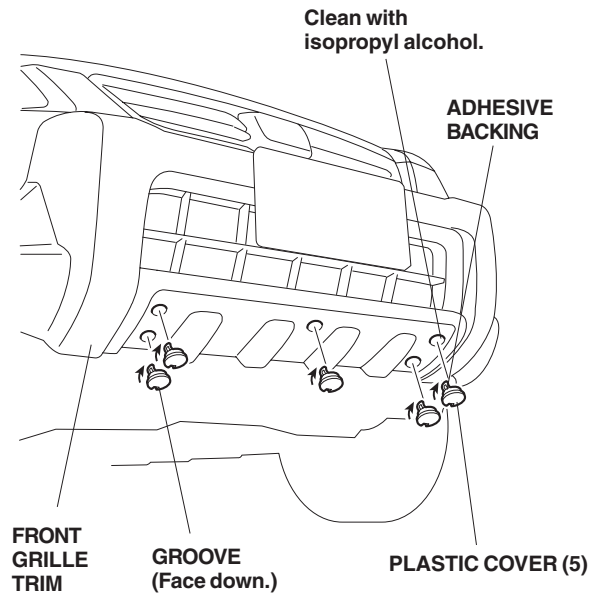

- Remove the adhesive backing from each plastic cover, and attach one cover over each of the five holes along the bottom of the front grille trim with the groove facing down. Hold each cover firmly against the front grille trim with your thumb for about 30 seconds.
- Reinstall the radiator cover.