



INSTALLATION INSTRUCTIONS

Accessory
REMOTE CONTROL ENGINE STARTER

Application
**2016 HR-V
(LX Only)**

Publications No.
VERSION 1
Issue Date
APR 2015

PARTS LIST

**Remote Engine Starter Unit Kit
P/N 08E91-T2A-100**

Transmitter



Control unit



Antenna



ID label



**Remote Control Engine Starter Attachment Kit
P/N 08E92-T7S-100B**

Engine starter harness

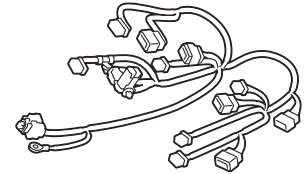

Control unit bracket



3 Relays



19 Wire ties



3 Long wire ties



Ground bolt



Aluminum tape

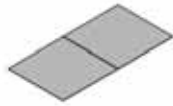

9 Urethane tapes



Caution label



Fuse label



Clip



Accessory User's Information Manual

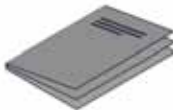

Quick Start Guide



TOOLS AND SUPPLIES REQUIRED

Phillips screwdriver

Flat-tip screwdriver

Diagonal cutters

Ratchet

10 mm Socket

10 mm Open end wrench

Isopropyl alcohol

Scissors

Shop towel

Ruler

HDS/MVCI

Masking tape

Tape

The following tools are available through the Honda Tool and Equipment Program. On the iN, click on: Service > Service Bay > Tool and Equipment Program, then enter the number under "Search". Or, call 888-424-6857.

- Trim Tool Set (T/N SOJATP2014)
- Plastic Trim Tool (T/N SILTRIMTL10)

Illustration of the Remote Control Engine Starter Installed in the Vehicle

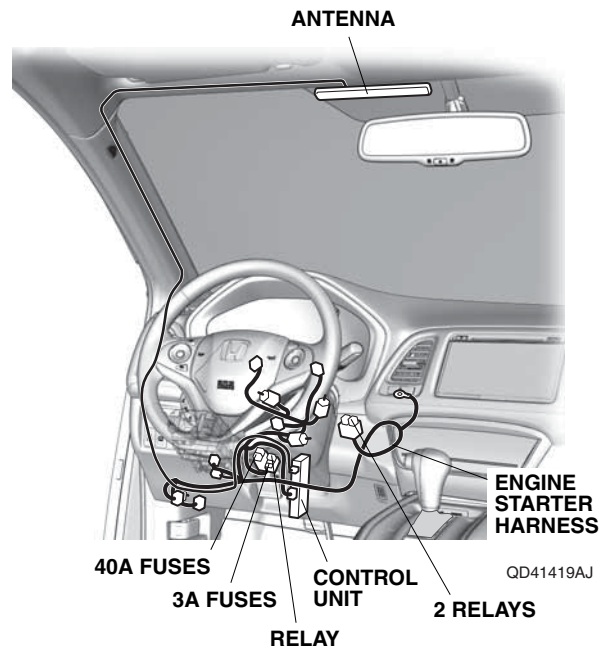

INSTALLATION

Customer Information: The information in this installation instruction is intended for use only by skilled technicians who have the proper tools, equipment, and training to correctly and safely add equipment to your vehicle. These procedures should not be attempted by “do-it-yourselfers.”

NOTE: The antenna should only be installed if the ambient air temperature 15°C (60°F) or above.

1. Disconnect the negative cable from the battery.
2. Attach the ID label.
 - Using isopropyl alcohol on a shop towel, clean the transmitter where the ID label will attach.
 - Attach the ID label to the transmitter in the area as shown.

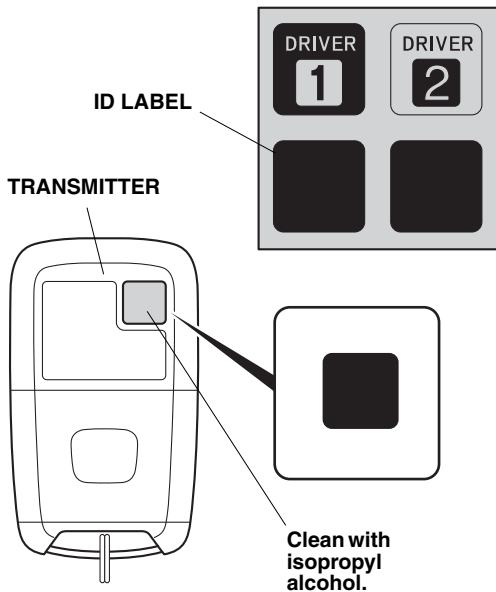

QBD0601AE

3. Remove the driver's sunvisor:
 - Pivot the driver's sunvisor downward.
 - Wrap tape around the tip of flat-tip screwdriver.
 - Locate the slot in the base cover, and insert the flat-tip screwdriver into the slot. Push in and hold the retaining tab.
 - While holding the retaining tab, push up on the sunvisor and rotate it toward the door.

NOTE: If the retaining tab does not stay pushed in, return the sunvisor to its original position and repeat this step.

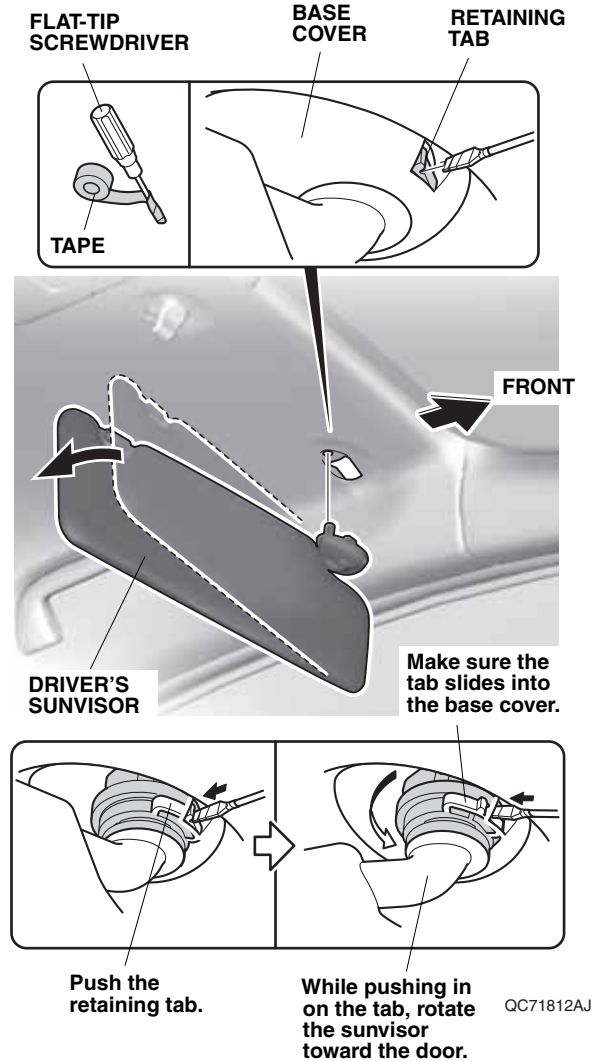

QC71812AJ

4. Remove the driver's sunvisor holder:
 - Wrap tape around the tip of flat-tip screwdriver.
 - Release three retaining tabs on the driver's sunvisor holder.

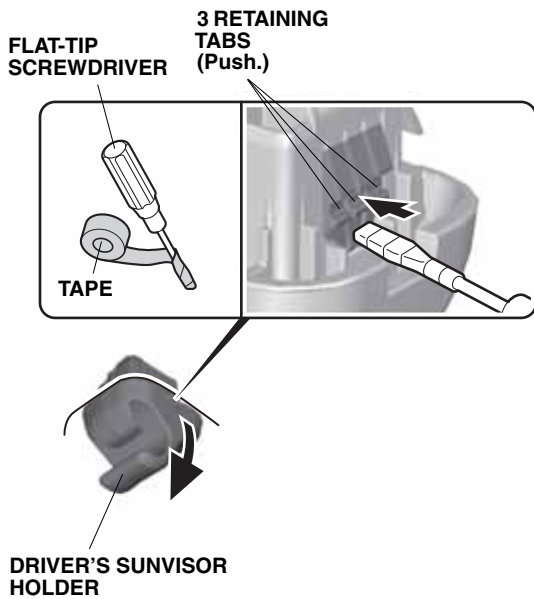

QC22003BJ

- While pulling down the driver's sunvisor holder as shown, use a flat-tip screwdriver wrapped with a tape to remove the driver's sunvisor holder.

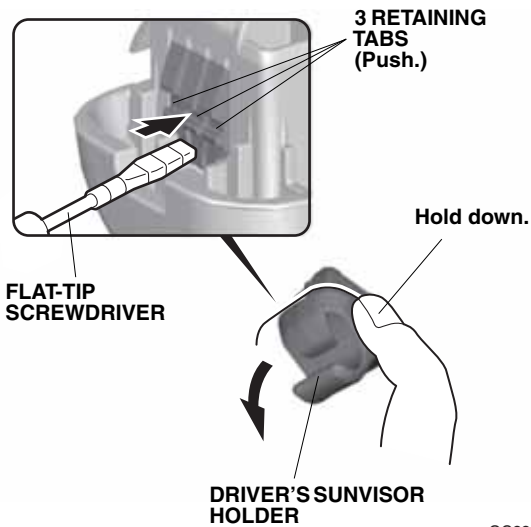

QC22004AJ

5. Remove the driver's A-pillar trim.
 - Pull away the door opening seal from the driver's A-pillar trim.
 - Pull out on the driver's A-pillar trim to release three clips.

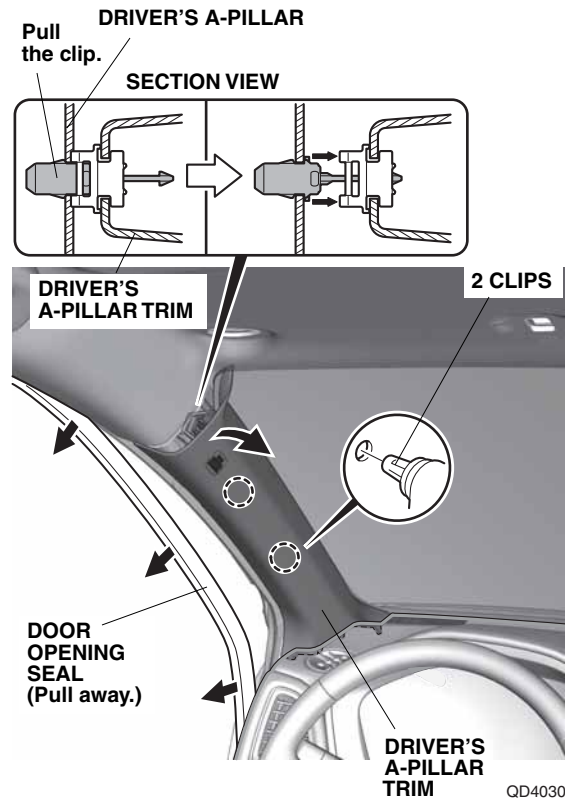

QD40302BJ

- To prevent clips from falling into the body panel area, carefully insert a shop towel between the driver's A-pillar and the driver's A-pillar trim.

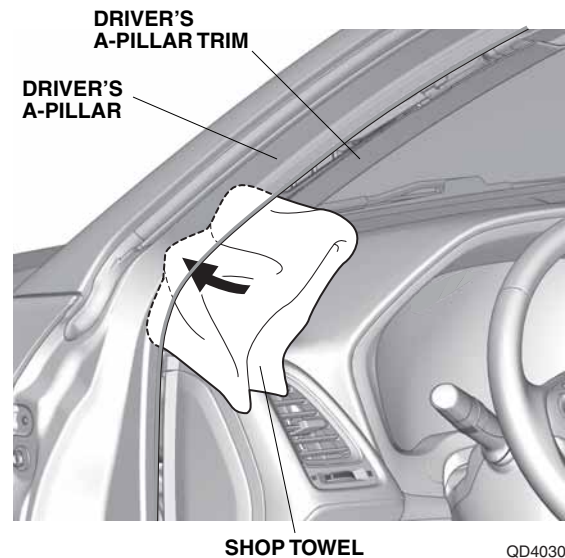

QD40303BJ

- Slide the driver's A-pillar trim upward, and remove the driver's A-pillar trim.
- Remove the shop towel and any clips.

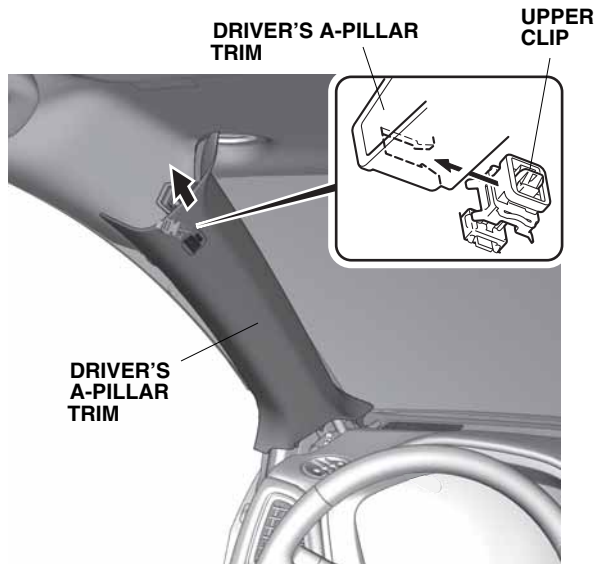

QD40304BJ

6. Remove the remaining upper clip from the driver's A-pillar.

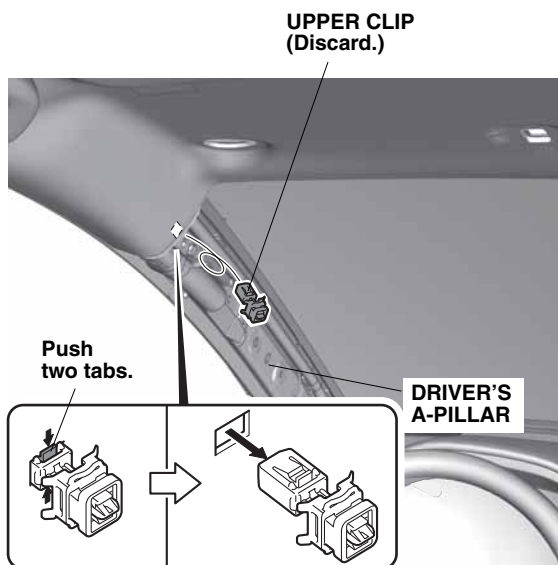

QD40305BJ

7. Install the new clip (supplied) to the driver's A-pillar trim.

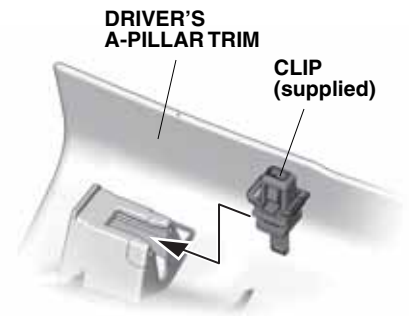

QC72508AJ

8. Lower the steering wheel. Attach tape to the upper column cover as shown.

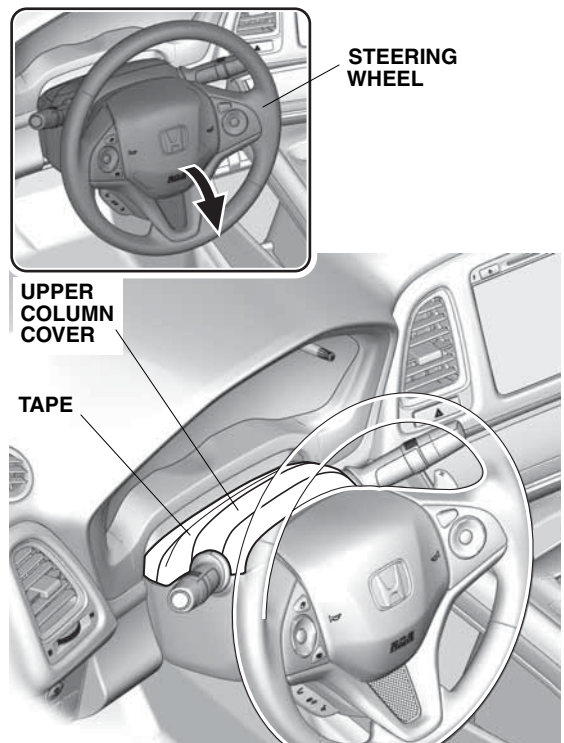

QD41002AJ

- Turn the steering wheel 90° clockwise. Using a plastic trim tool, release the retaining tab.

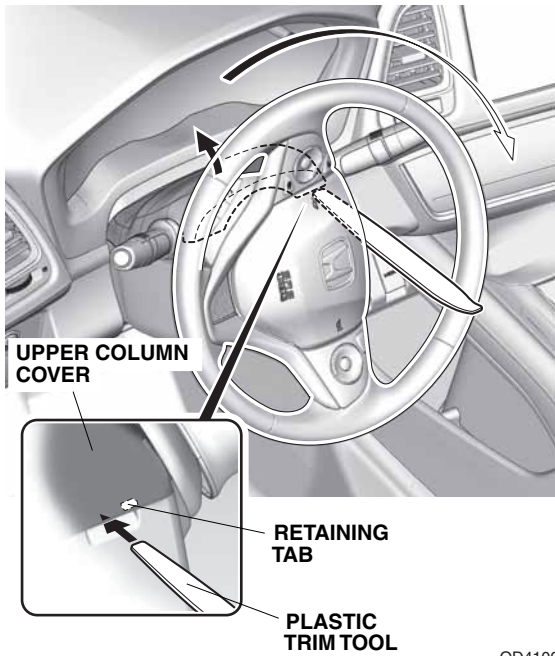

- Turn the steering wheel 180° counterclockwise. Using a plastic trim tool, release the retaining tab.

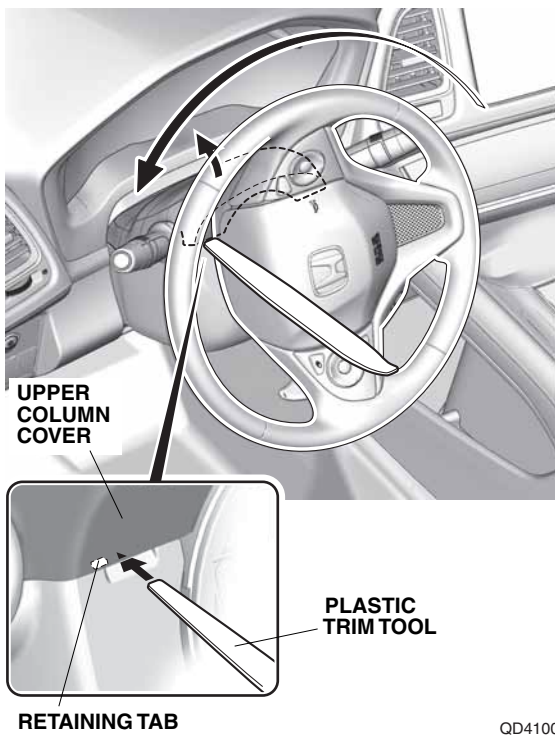

- Remove the upper column cover.

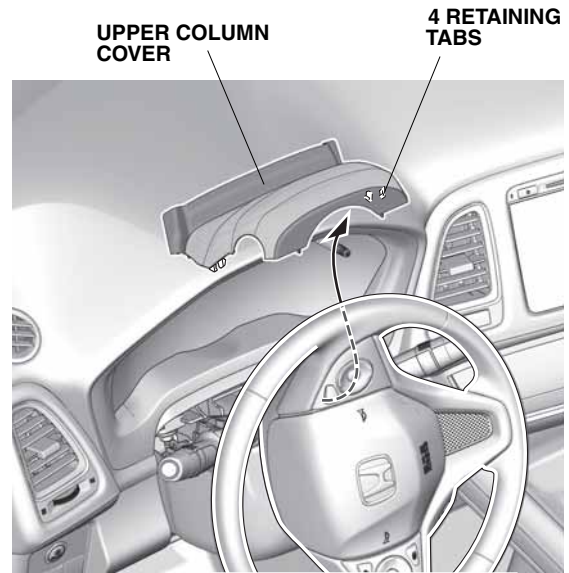

- Remove the self-tapping screw from the lower column cover.



13. Turn the steering wheel 180° clockwise, and remove the self-tapping screw from the lower column cover.

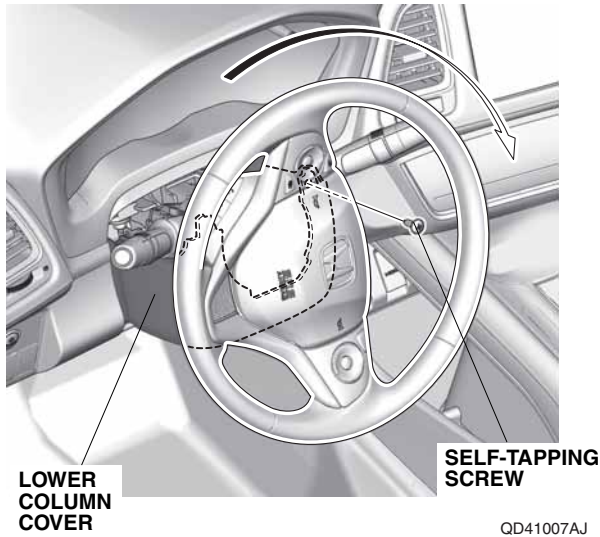

14. Pull away the door opening seal, and remove the driver's dashboard side lid.

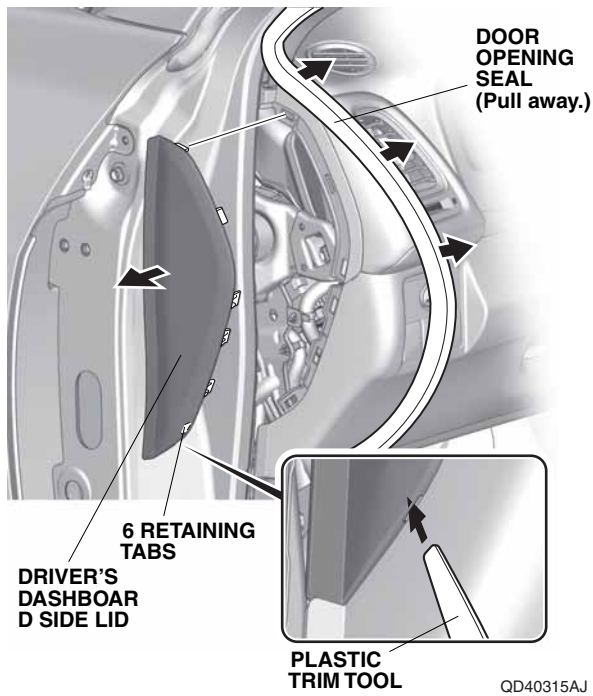

15. Attach tape to the lower column cover.

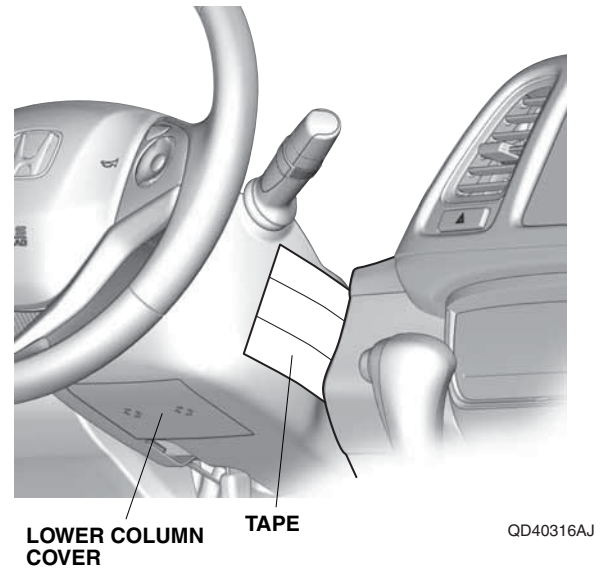

16. Pull away the door opening seal, and remove the driver's dashboard lower cover and unplug the vehicle connectors.

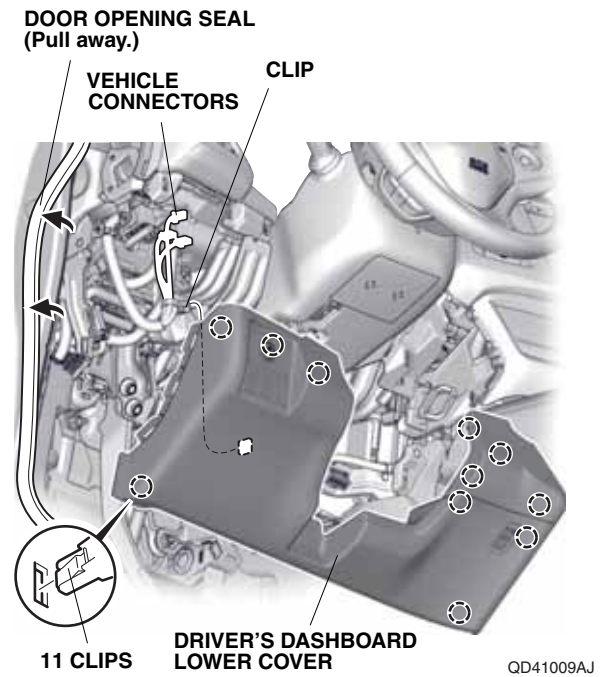

17. Remove the lower column cover.

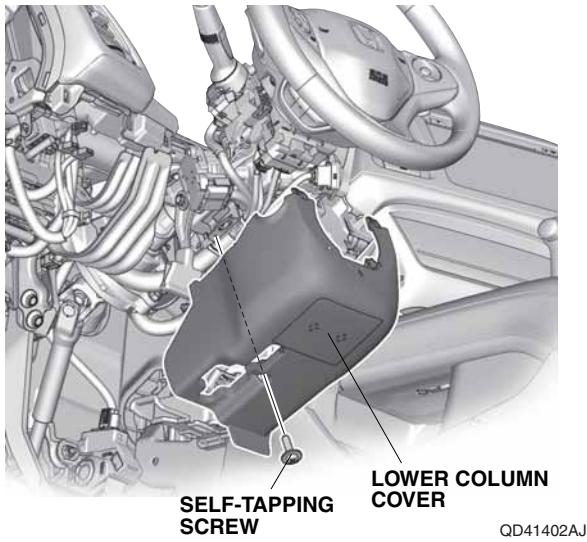

18. Pull away the door opening seal, and remove the driver's front door sill trim.

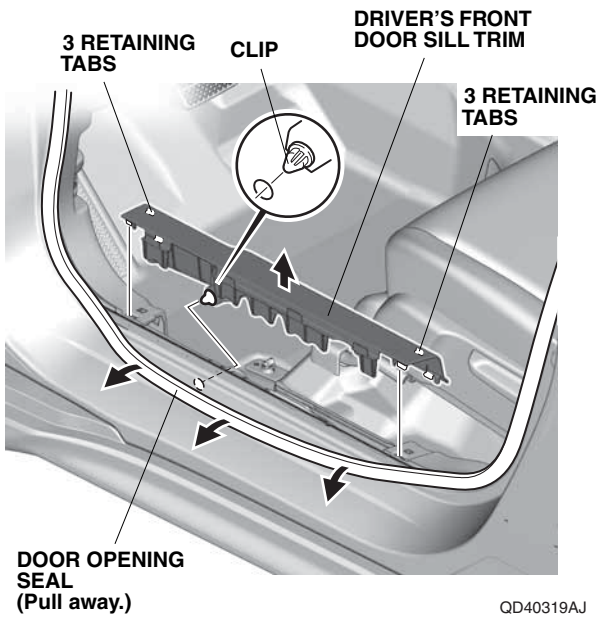

19. Pull away the door opening seal, and remove the driver's kick panel.

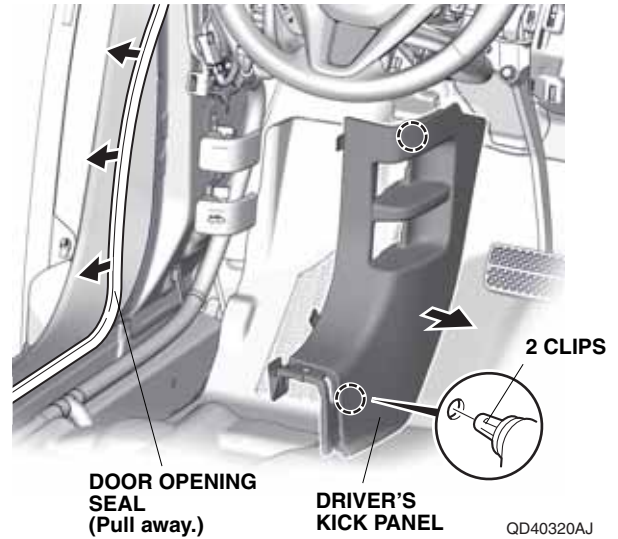

Installing the Antenna

20. Using scissors, cut one urethane tape in half. Wrap two halves of urethane tape around the antenna cable as shown.
NOTE: Do not fold the antenna cable.

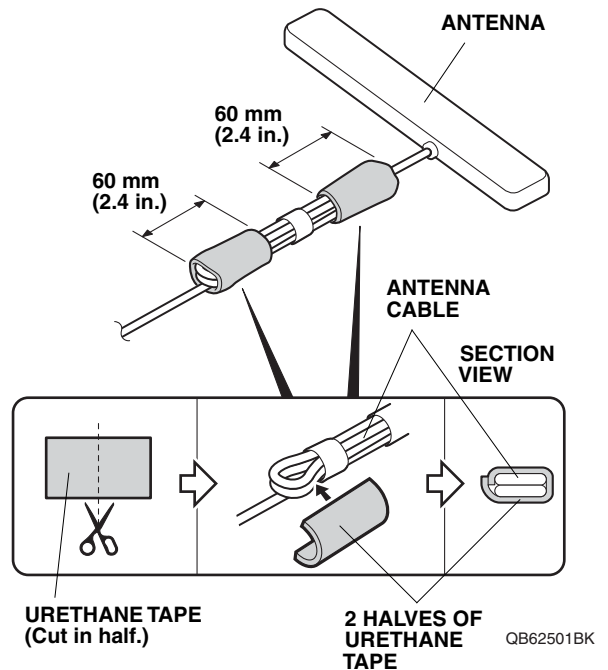

- Using scissors, cut one urethane tape in half. Wrap two halves of urethane tape around the antenna cable at the measurement shown.

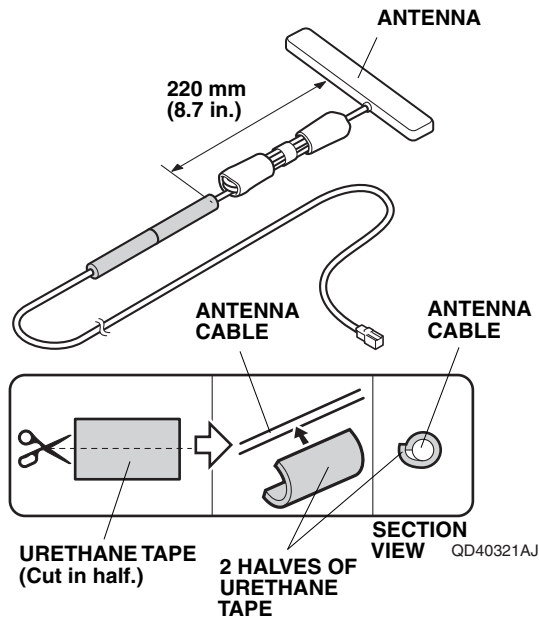

- Attach the antenna.

- Attach masking tape to the windshield at the measurement shown.

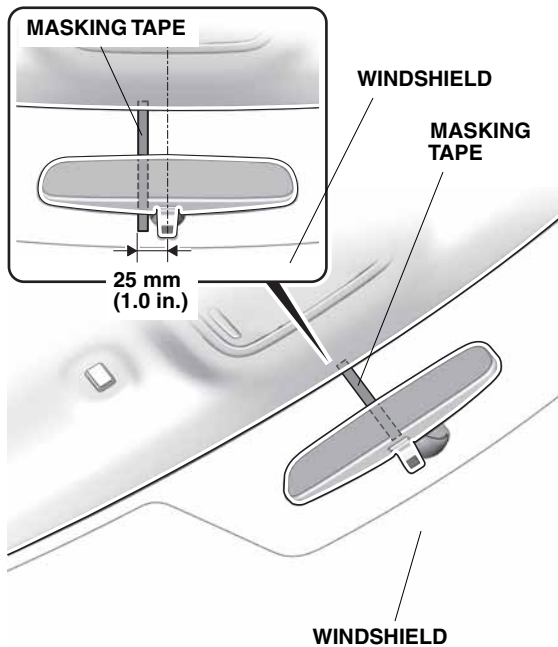

QD40322AJ

- Fold the adhesive backing of the antenna as shown.

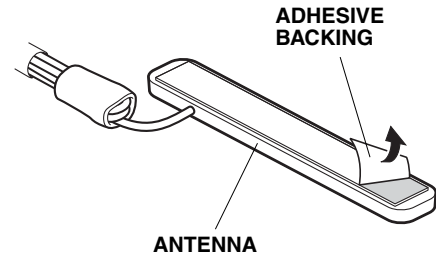

QB51401CH

- Using isopropyl alcohol on a shop towel, clean the windshield where the antenna will attach.
- Attach the antenna with masking tape. Adjust the position of the antenna so there is equal spacing on both sides.

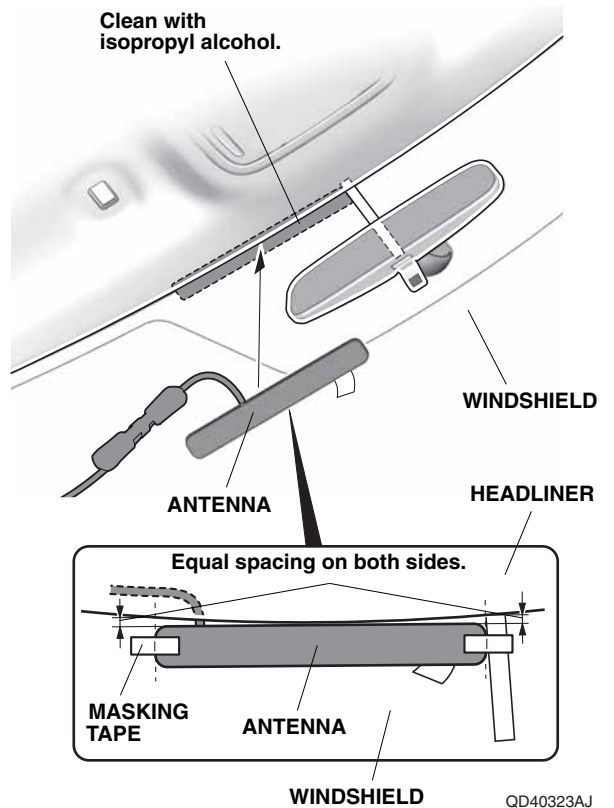

QD40323AJ

- Carefully remove the adhesive backing from the antenna, and attach the antenna to the windshield. Press and hold the antenna firmly in place for 30 seconds.
- Remove the masking tape.

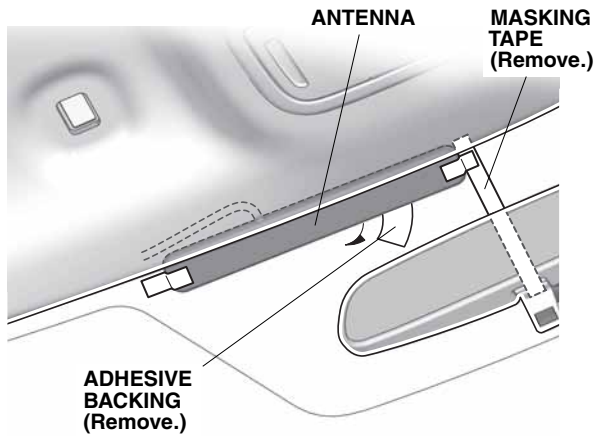

QD40324AJ

23. Gently pull down the headliner, and tuck the antenna cable behind the headliner. Be careful not to crease the headliner.

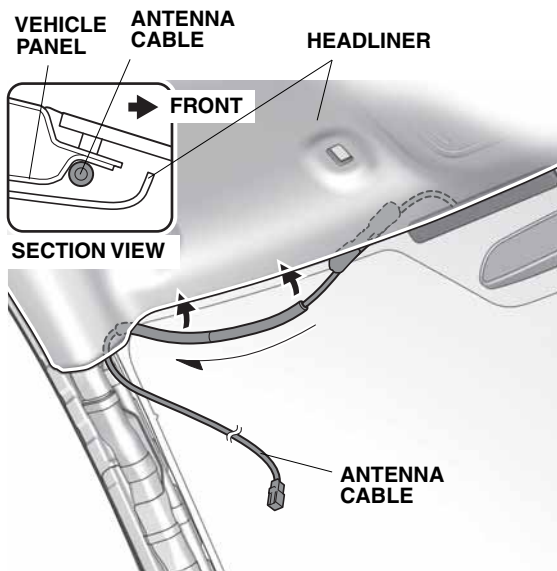

QD40325BJ

24. Route the antenna cable down the A-pillar as shown. Secure the antenna cable to the vehicle harness with four wire ties.

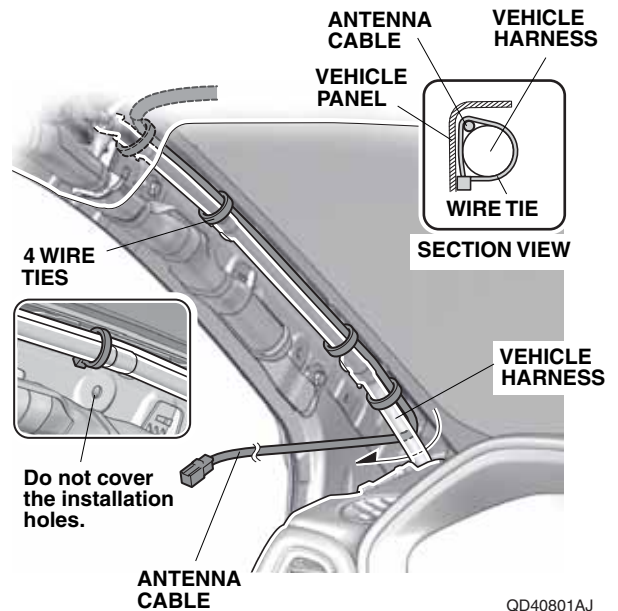

QD40801AJ

25. Using isopropyl alcohol on a shop towel, clean the driver's A-pillar where the urethane tape will attach.

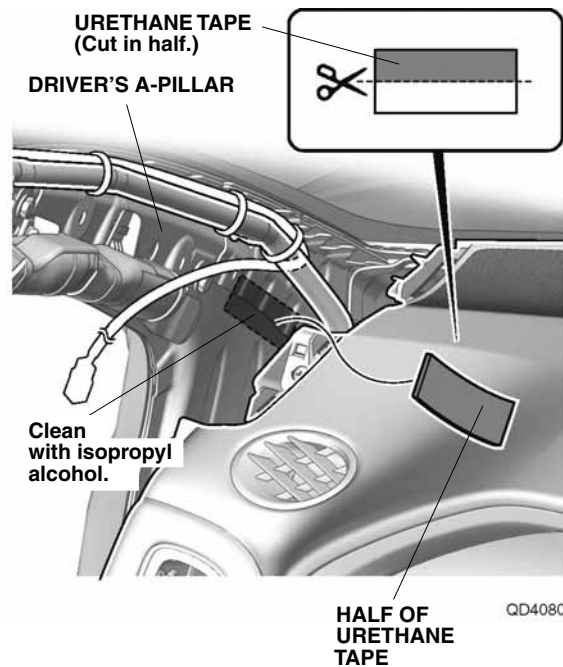

QD40802BJ

26. Using scissors, cut one urethane tape in half. Attach one half of urethane tape to the driver's A-pillar as shown.

27. Wrap the remaining urethane tape in step 26 and one urethane tape around the antenna cable of the measurements shown.

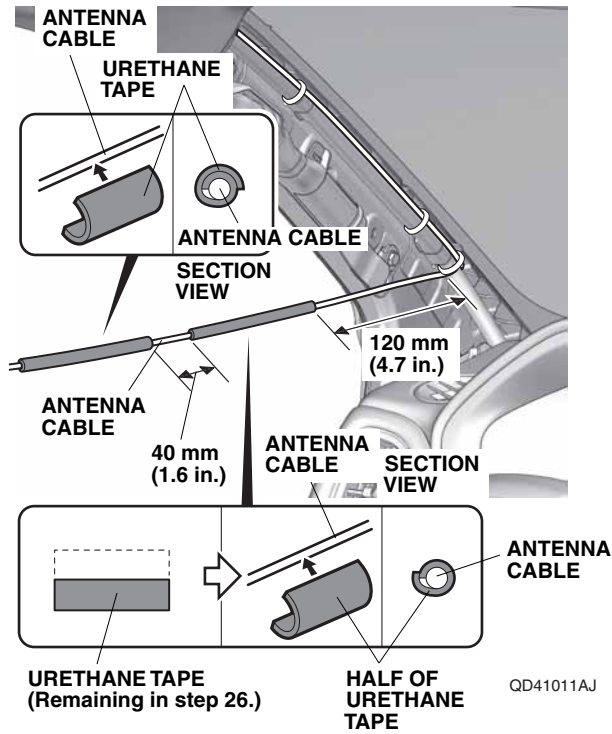

28. Pull away the door opening seal. Route the antenna cable down next to the dashboard, and tuck the antenna cable between the driver's A-pillar and the dashboard.

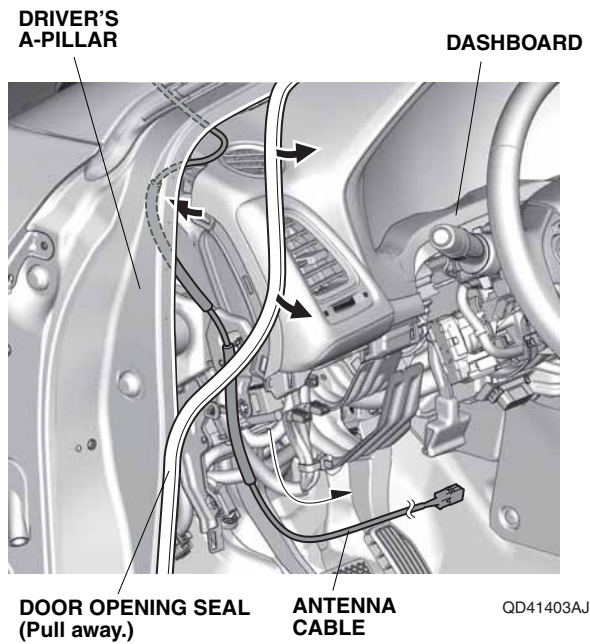

29. Secure the antenna cable to the steering hanger beam and vehicle harness with two wire ties.

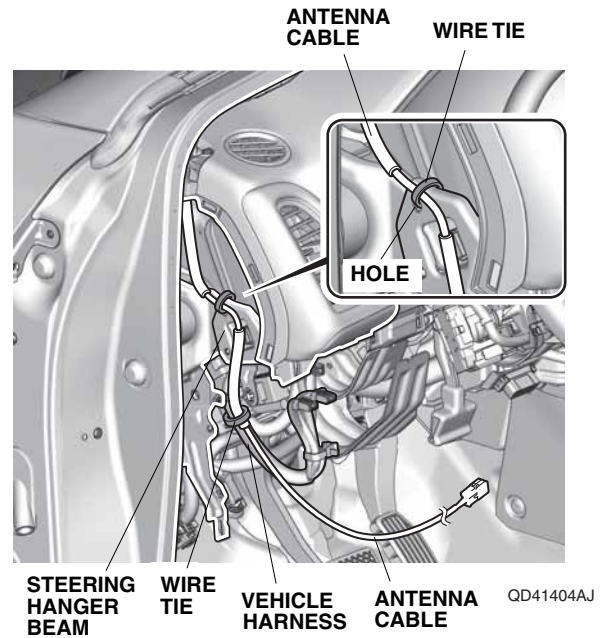

30. Using isopropyl alcohol on a shop towel, clean the driver's A-pillar where the aluminum tape will attach.

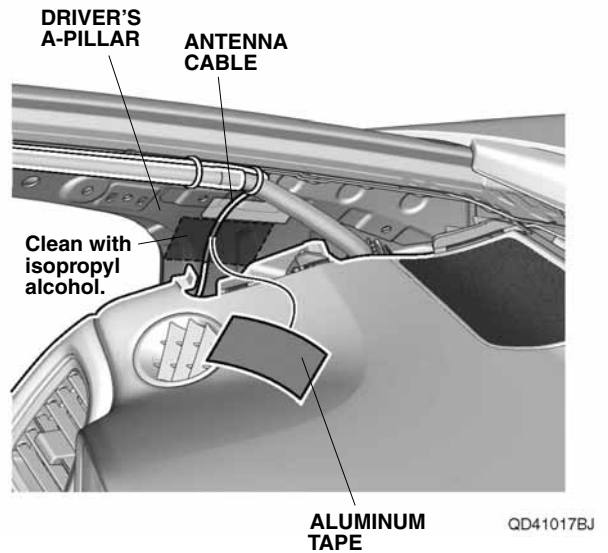

31. Attach the antenna cable to the driver's A-pillar with one aluminum tape.

32. Secure the antenna cable to the vehicle harness with one wire tie.

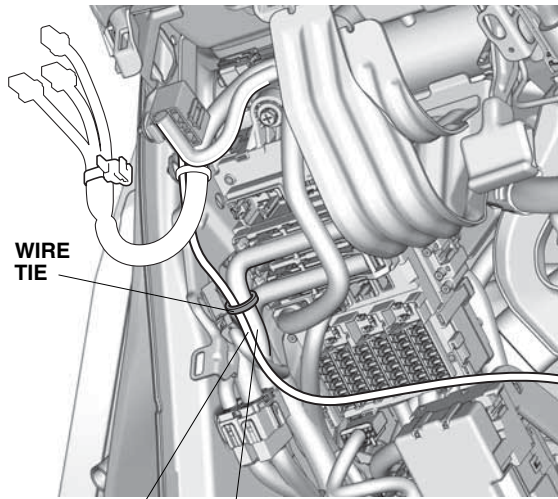

ANTENNA CABLE VEHICLE HARNESS QD41405AJ

Routing the Engine Starter Harness

33. Using isopropyl alcohol on a shop towel, clean the engine starter harness fuse block where the fuse labels will attach.

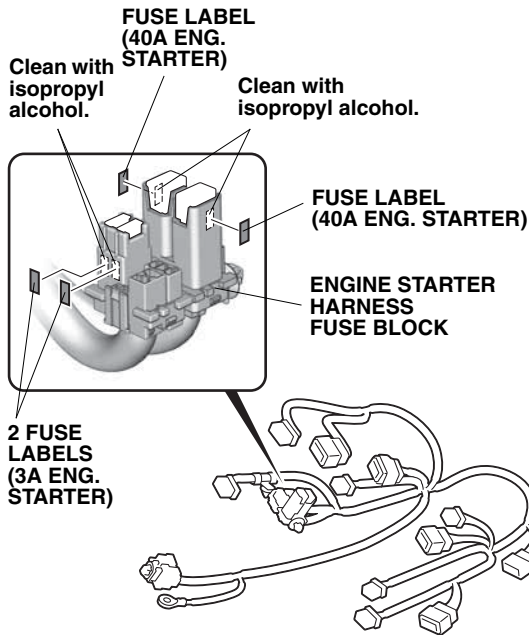

QD41406AJ

34. Attach four fuse labels to the engine starter harness fuse block.

35. Install three relays to the engine starter harness relay block.

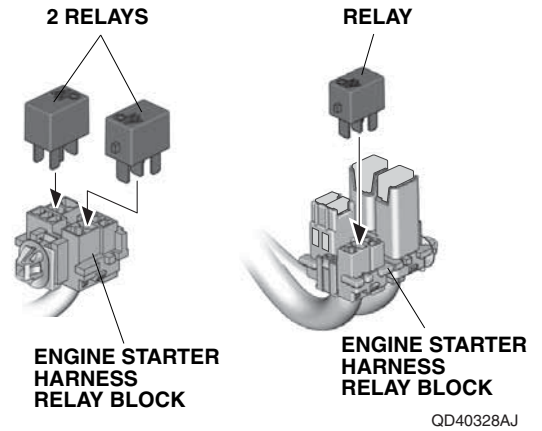

36. Release the subfuse box from the subfuse box bracket.

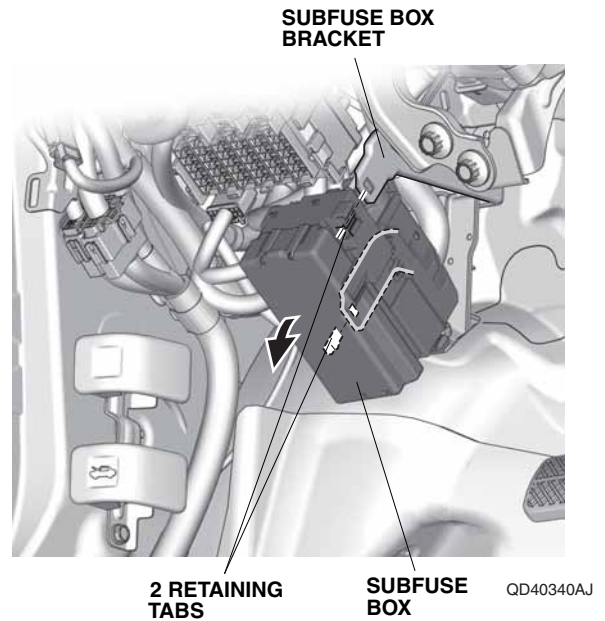

37. Remove the subfuse box bracket.

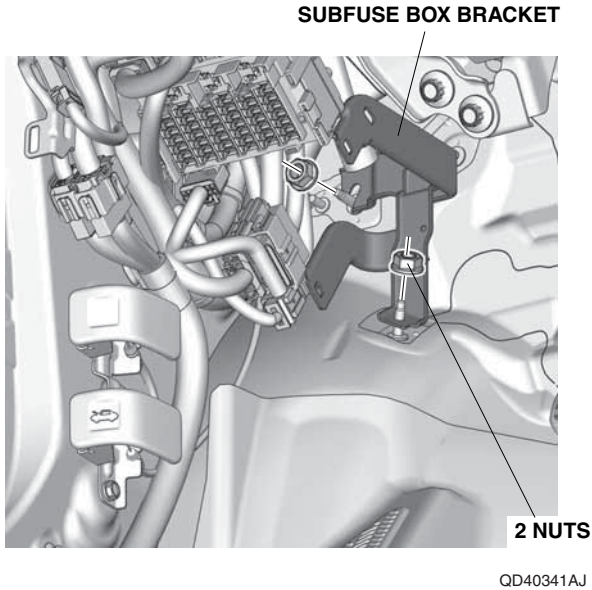

38. Plug the antenna cable connector and engine starter harness 28-pin connector into the control unit.

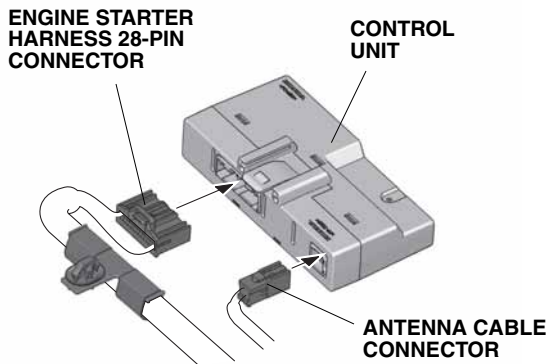

39. Using isopropyl alcohol on a shop towel, clean the control unit bracket where the urethane tape will attach.

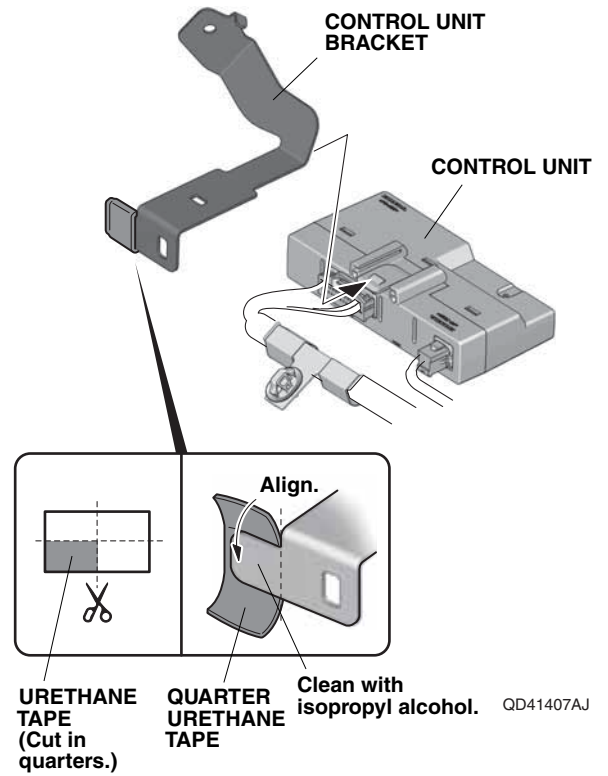

- 40. Using scissors, cut one urethane tape in quarters. Wrap the cut urethane tape around the control unit bracket as shown.
- 41. Install the control unit bracket to the control unit.
- 42. Attach the engine starter harness clip to the control unit bracket.

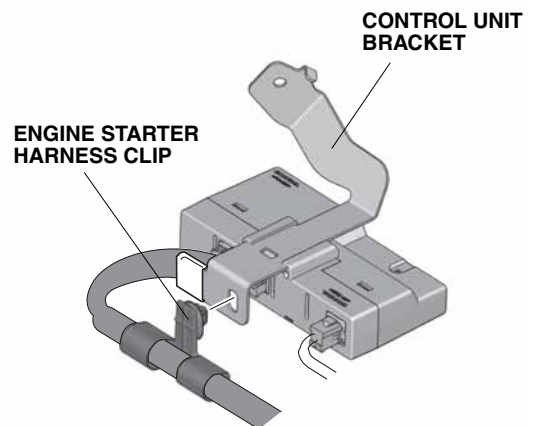

43. Secure the subfuse box bracket (removed in step 37) and control unit bracket to the studs with two nuts in the order shown.

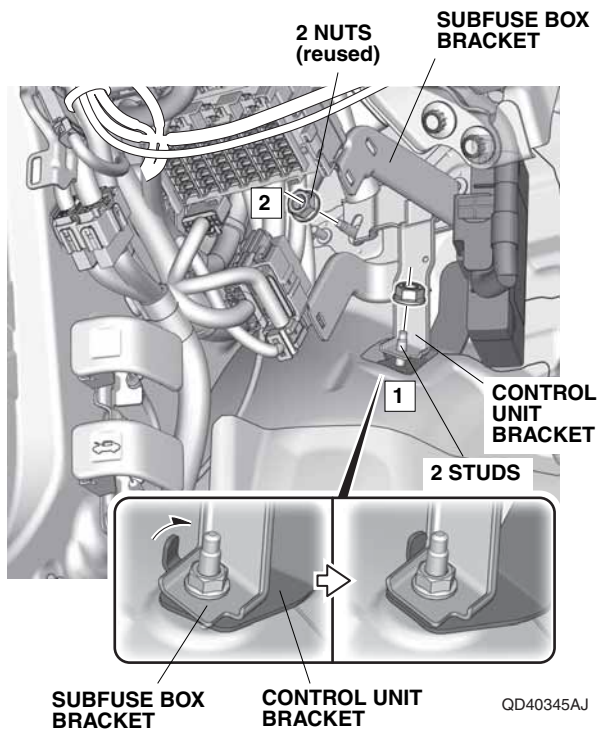

44. Reinstall the subfuse box released in step 36.
45. Secure the engine starter harness fuse block to the hole in the subfuse box bracket.

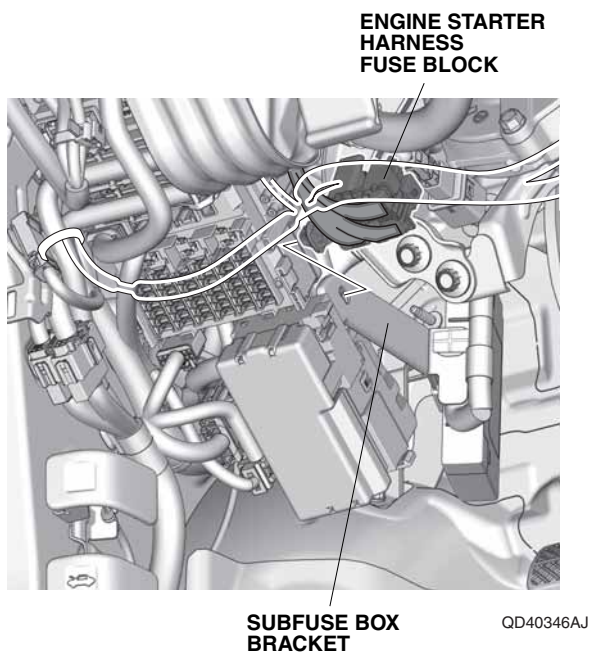

Without Other Accessory Harness 4-pin Connector Plugged Into The Fuse Box

46. Plug the engine starter harness 4-pin connector into the fuse box. Go to step 48.

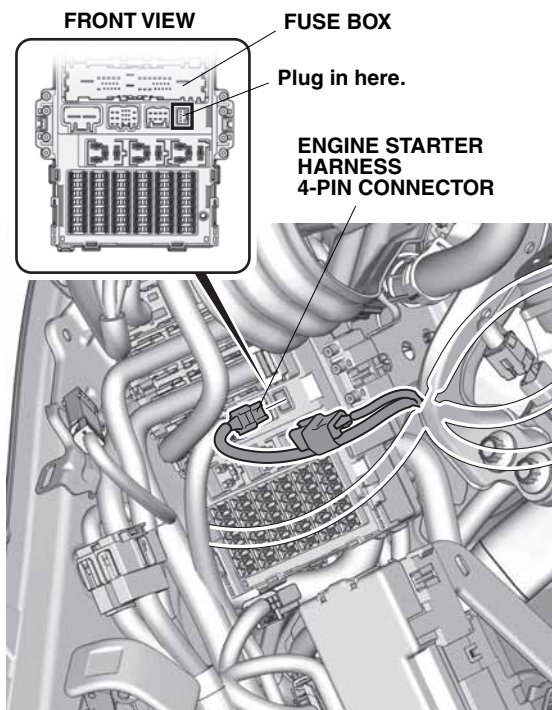

With Other Accessory Harness 4-pin Connector Plugged Into The Fuse Box

47. If other accessory harness 4-pin connector is plugged into the fuse box, unplug the other accessory harness 4-pin connector from the fuse box, then plug the engine starter harness 4-pin connector into the fuse box. Plug the other accessory harness 4-pin connector into the engine starter harness 4-pin connector.

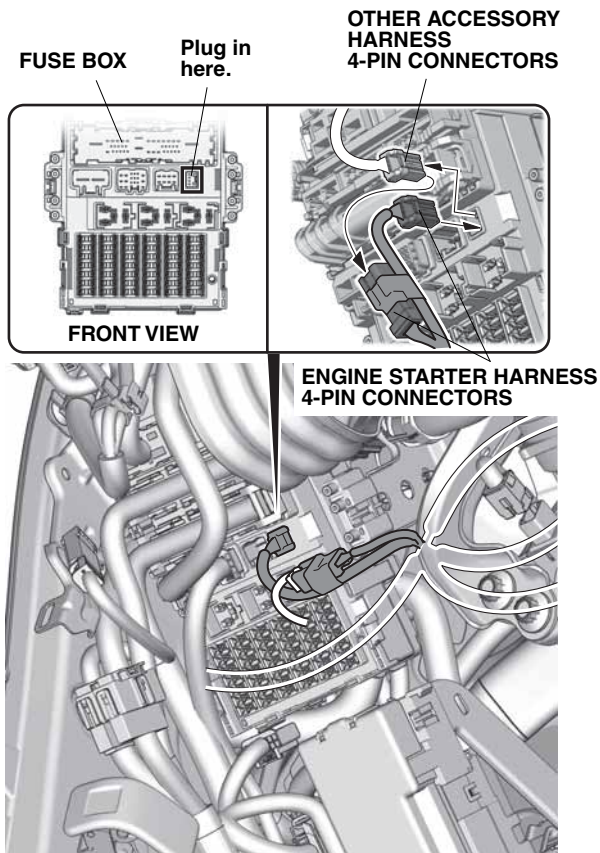

QD41409AJ

48. Unplug the vehicle 22-pin connector, and plug it into the engine starter harness 22-pin connector. Plug the remaining engine starter harness 22-pin connector into the vehicle 22-pin connector.

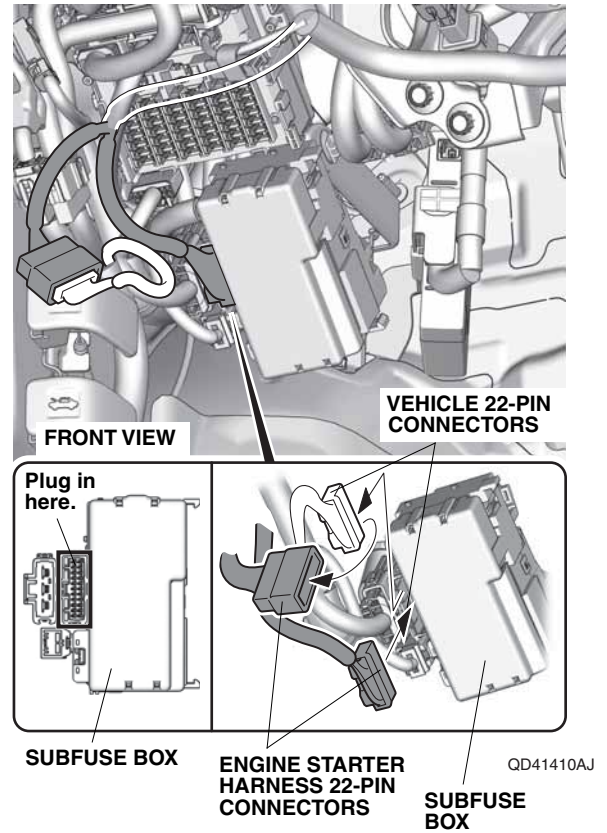

QD41410AJ

49. Secure the 22-pin connectors and engine starter harness to the vehicle harness with one wire tie and one long wire tie.

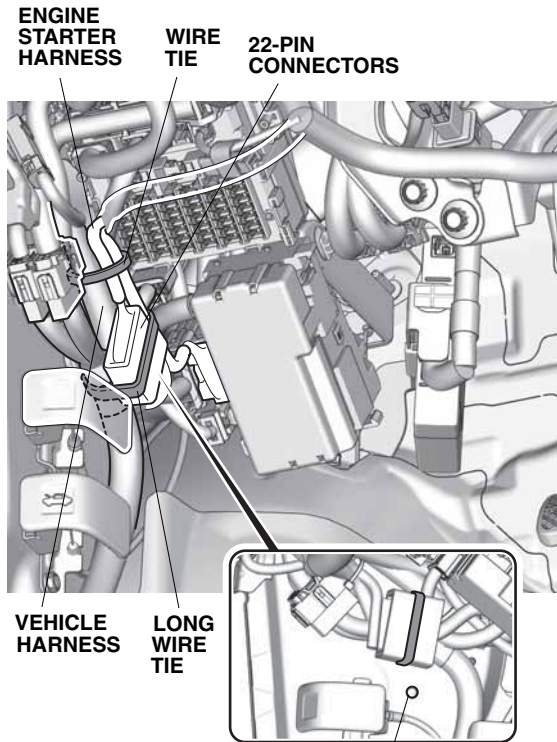

Do not cover the installation hole. QD41411AJ

50. Route the engine starter harness as shown. Install the engine starter harness ground terminal with one ground bolt.

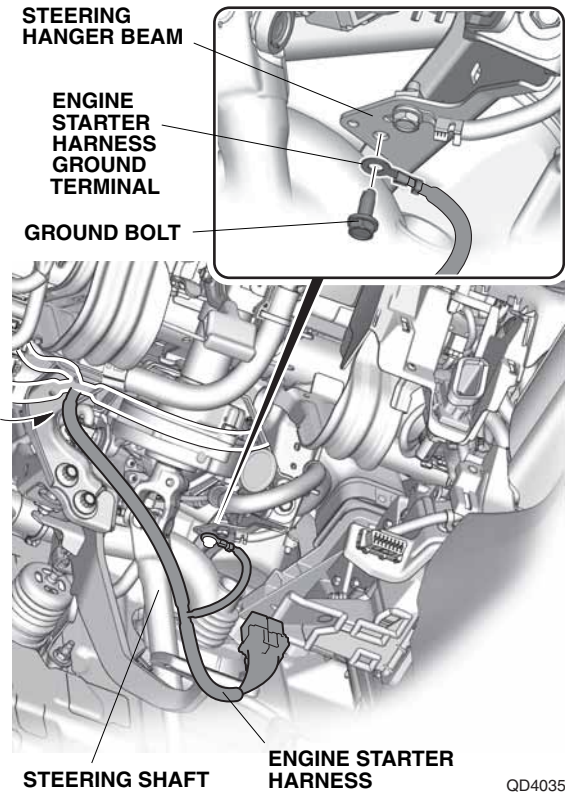

QD40351AJ

51. Secure the engine starter harness relay block to the hole in the vehicle panel. If another relay block is already secured to the hole in the vehicle panel, secure the engine starter harness relay block to the other relay block.

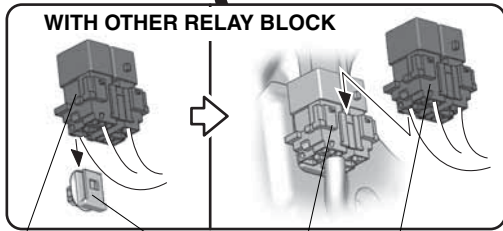
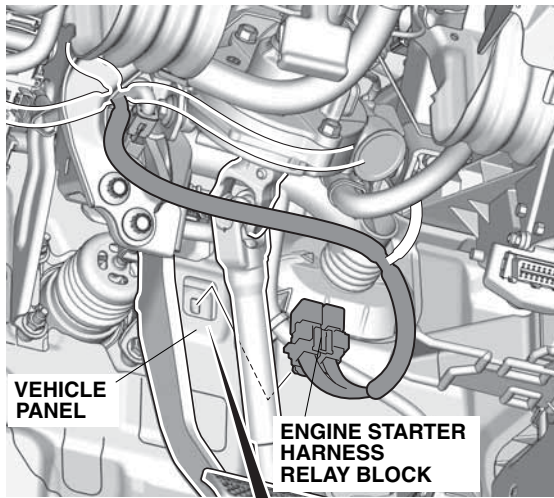

ENGINE STARTER HARNESS RELAY BLOCK

CLIP (Discard.)

OTHER RELAY BLOCK

ENGINE STARTER HARNESS RELAY BLOCK

QD40352AJ

52. Align the white tape on the engine starter harness with the vehicle clip, and secure the engine starter harness to the vehicle harness with four wire ties.

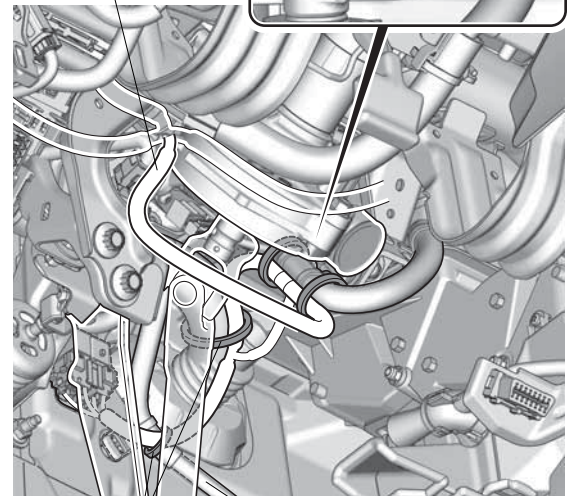
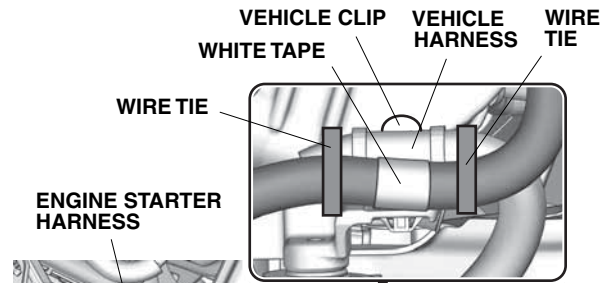

QD40353BJ

53. Secure the engine starter harness to the steering hanger beam with one wire tie.

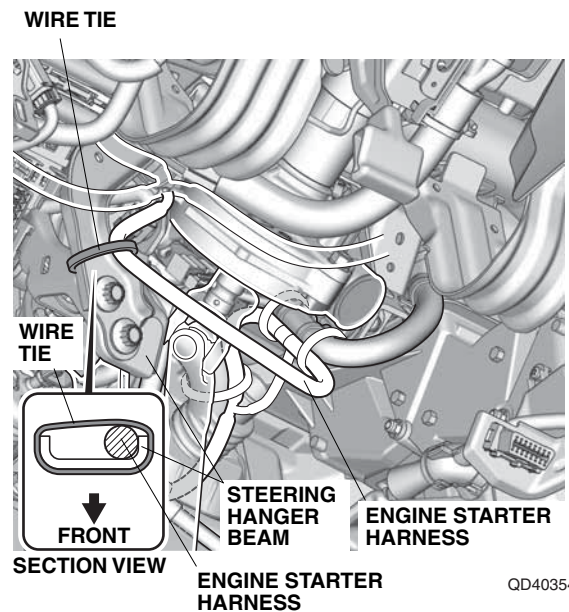

54. Route the engine starter harness along the vehicle harness. Align the white tape on the engine starter harness with end of the vehicle harness protector, and secure the engine starter harness to the vehicle harness with one wire tie.

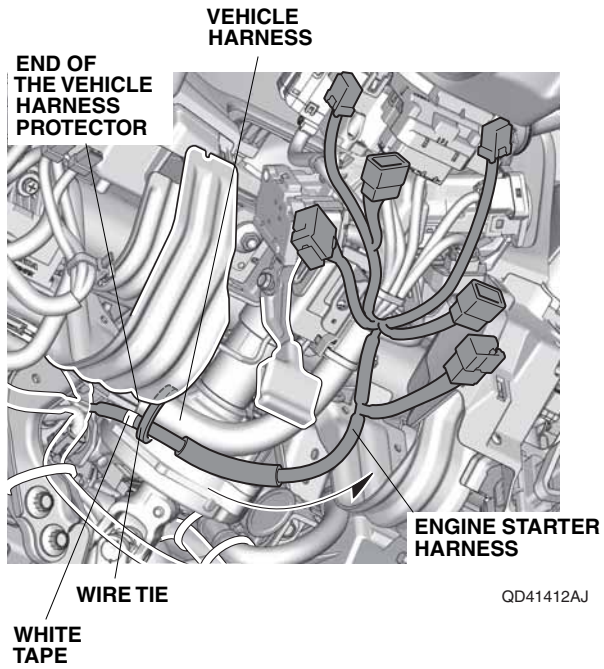

55. Unplug the vehicle 10-pin connector from the wiper switch, and plug it into the engine starter harness 10-pin connector. Plug the remaining engine starter harness 10-pin connectors into the wiper switch.

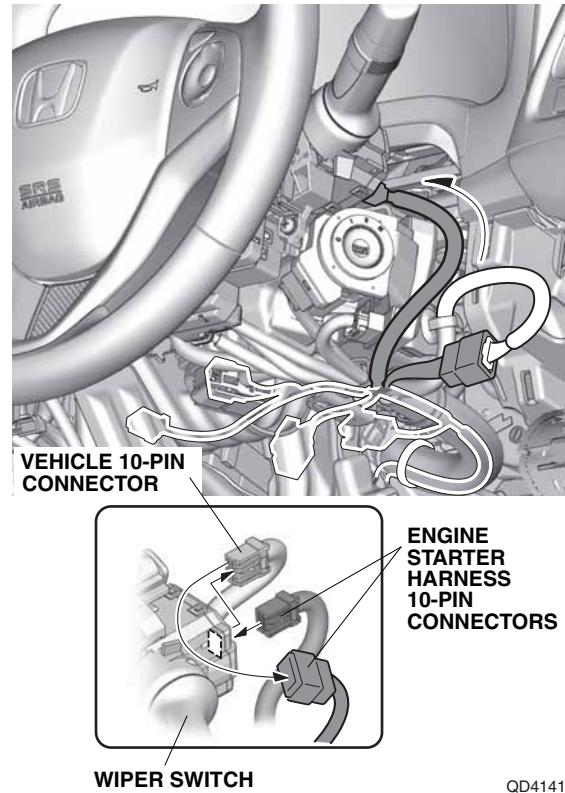

56. Align the white tape on the engine starter harness with the vehicle clip, and secure the engine starter harness and 10-pin connectors to the vehicle harness with one wire tie.

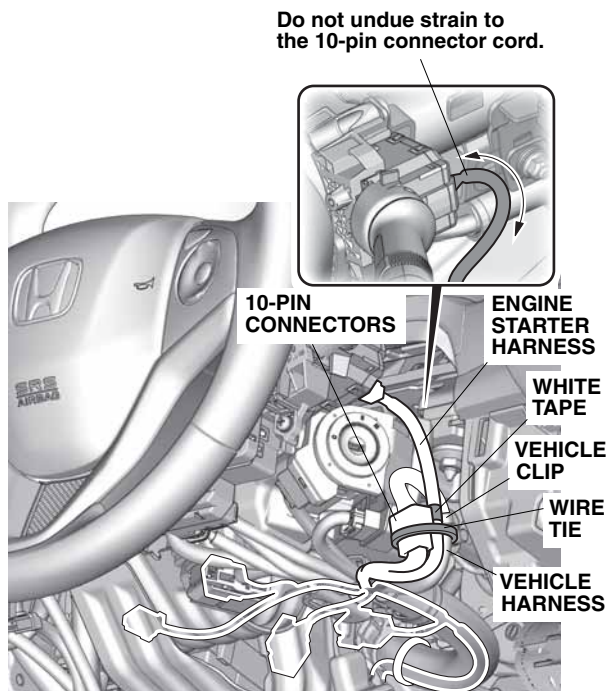

QD41414AJ

57. Unplug the vehicle 12-pin connector from the combination light switch, and plug it into the engine starter harness 12-pin connector. Plug the remaining engine starter harness 12-pin connector into the combination light switch.

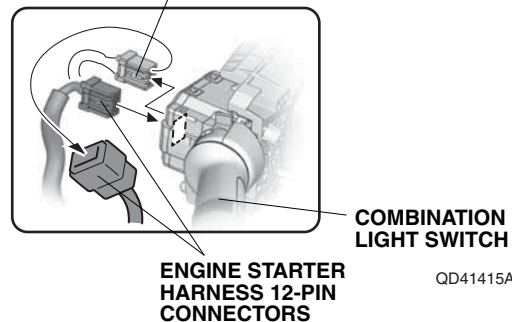
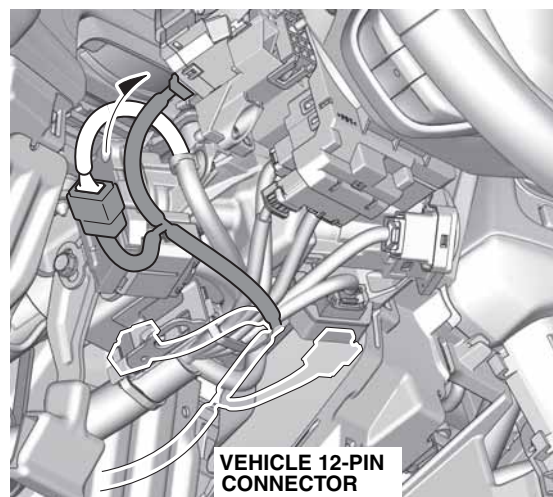

QD41415AJ

58. Align the white tape on the engine starter harness with the vehicle clip, and secure the engine starter harness and 12-pin connectors to the vehicle harness with one wire tie.

Do not undue strain to the 12-pin connector cord.

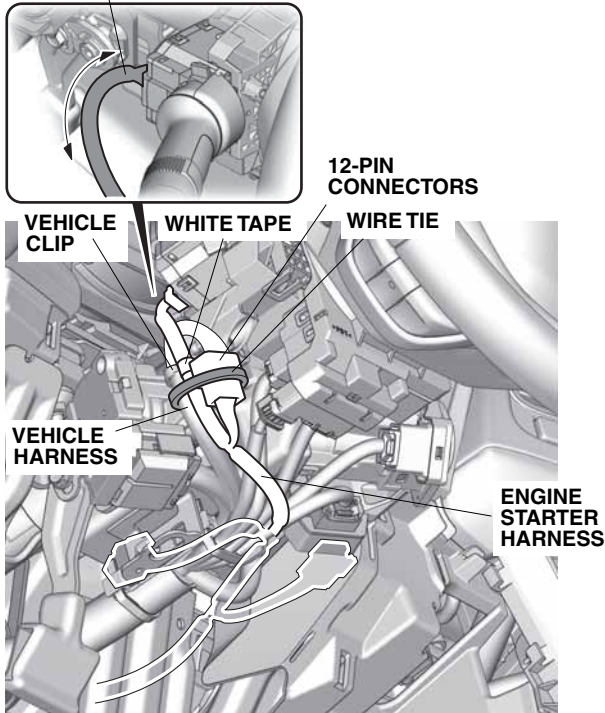

QD41416AJ

59. Using scissors, cut one urethane tape to the measurements shown. Wrap the cut urethane tape around the engine starter harness 5-pin connector.

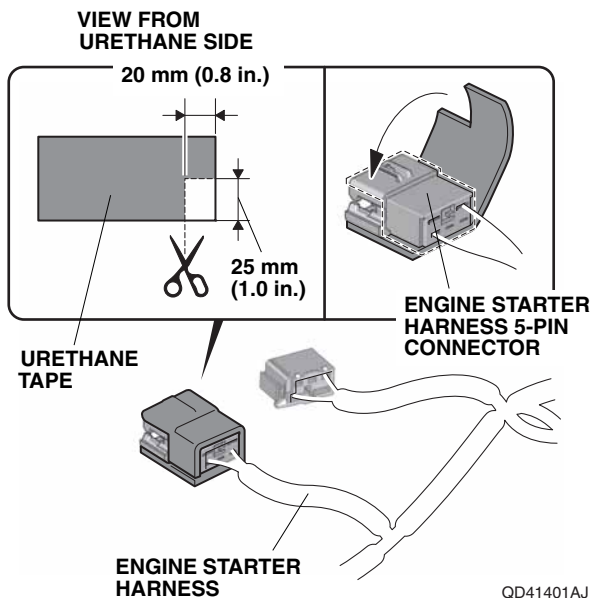

QD41401AJ

60. Unplug the vehicle 5-pin connector, and plug it into the engine starter harness 5-pin connector. Plug the remaining engine starter harness 5-pin connector into the vehicle 5-pin connector.

NOTICE: Make sure the engine starter harness 5-pin connector is securely connected to the vehicle 5-pin connector. A loose connection can cause the engine to stall during driving.

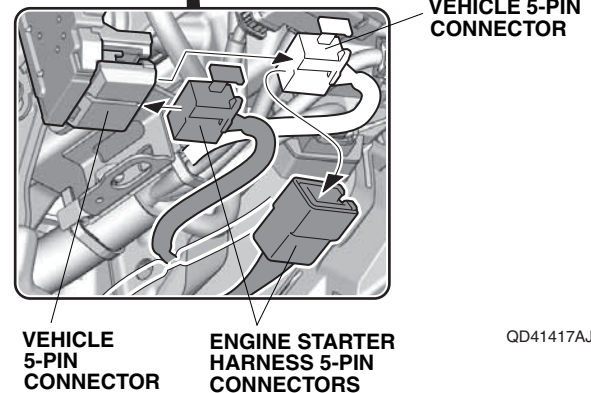
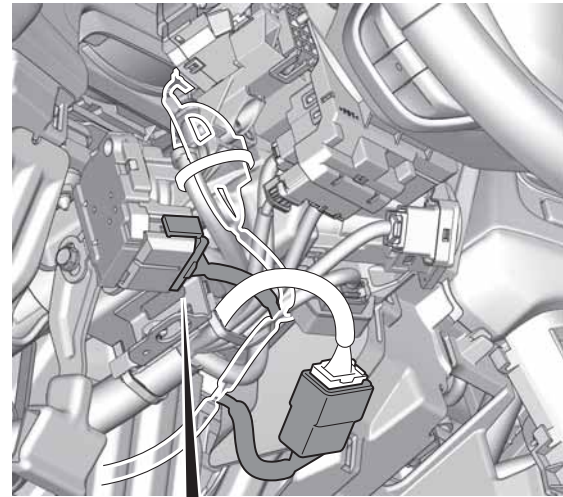
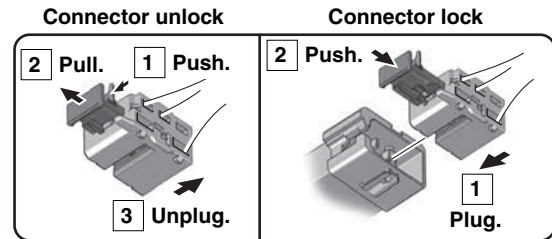

QD41417AJ

61. Align the branches of the engine starter harness and vehicle harness, and secure the engine starter harness and 5-pin connectors to the vehicle harness with one wire tie and one long wire tie.
 NOTE: Make sure that the connectors and harness are not pinched or interfered with the steering wheel when moved for adjustment.

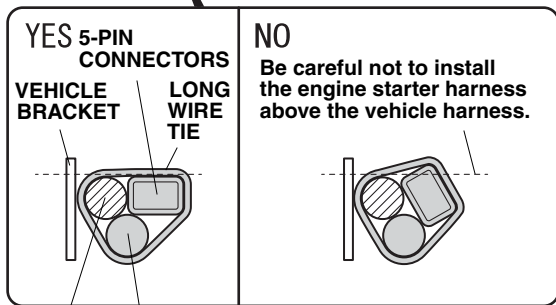
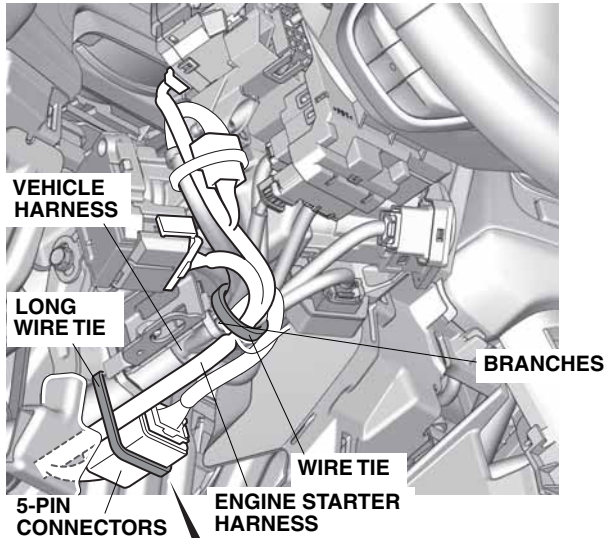

SECTION VIEW
 VEHICLE HARNESS
 ENGINE STARTER
 QD41418AJ

62. Secure the engine starter harness and antenna cable to the knee bolster with one long wire tie.

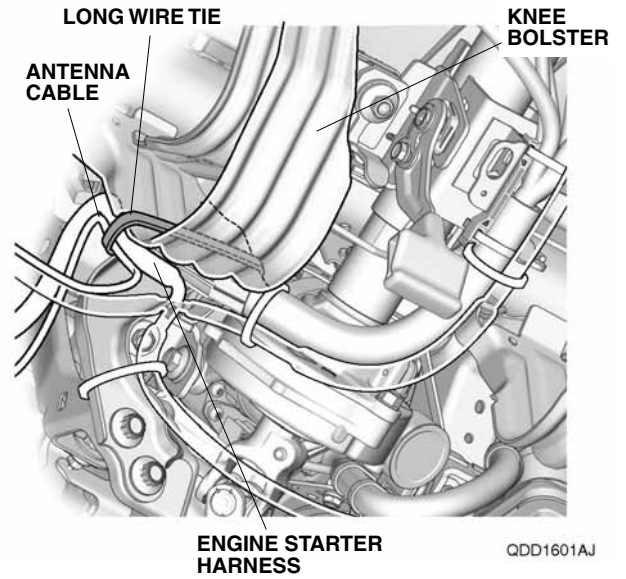

63. Align the white tape on the engine starter harness with the holes in the steering hanger beam, and secure the antenna cable and engine starter harness to the steering hanger beam with one wire tie.

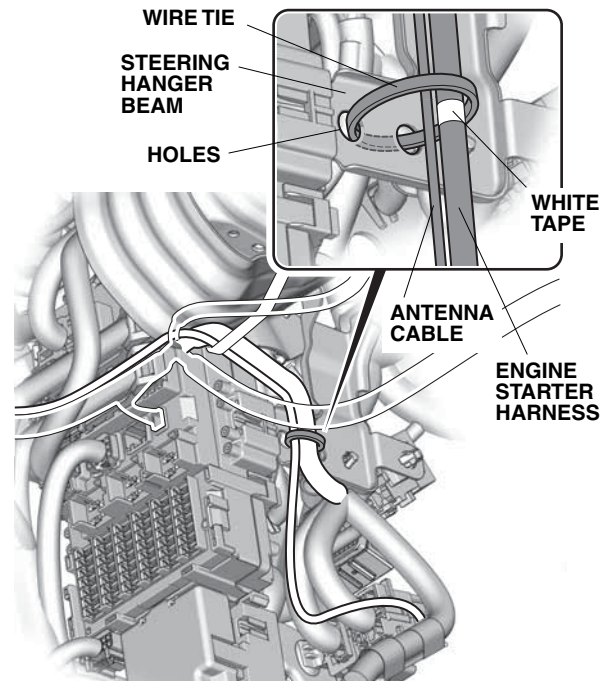

QD40362AJ

64. Bundle up the excess antenna cable as shown, and wrap one urethane tape around the antenna cable. Secure the antenna cable to the engine starter harness with one wire tie.
NOTE: Do not fold the antenna cable.

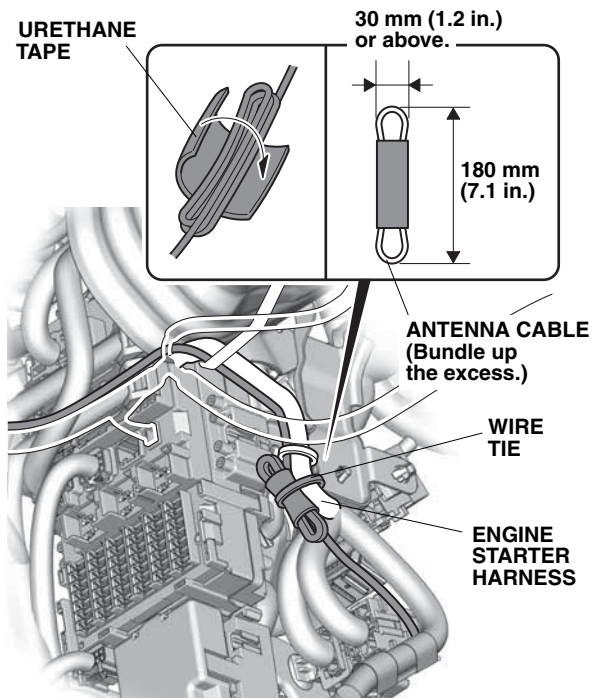

QD40363AJ

65. Using isopropyl alcohol on a shop towel, clean the lower column cover where the urethane tape will attach.

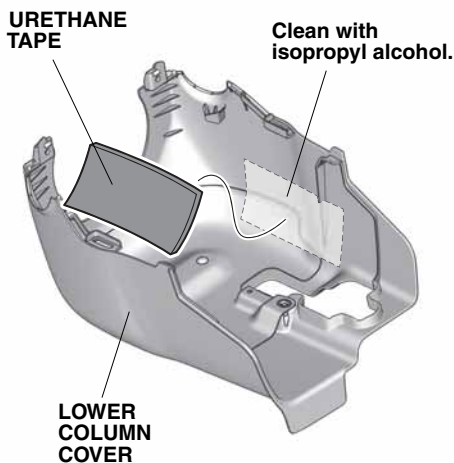

QC71808AJ

66. Attach the urethane tape to the lower column cover as shown.

67. Using isopropyl alcohol on a shop towel, clean the lower column cover where the urethane tape will attach.

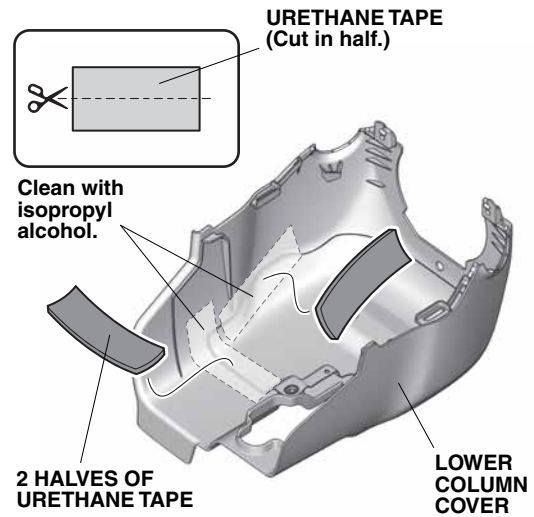

QC71809AJ

68. Using scissors, cut one urethane tape in half. Attach the two halves of urethane tape to the lower column cover as shown.

69. Using isopropyl alcohol on a shop towel, clean the hood where the caution label will attach.

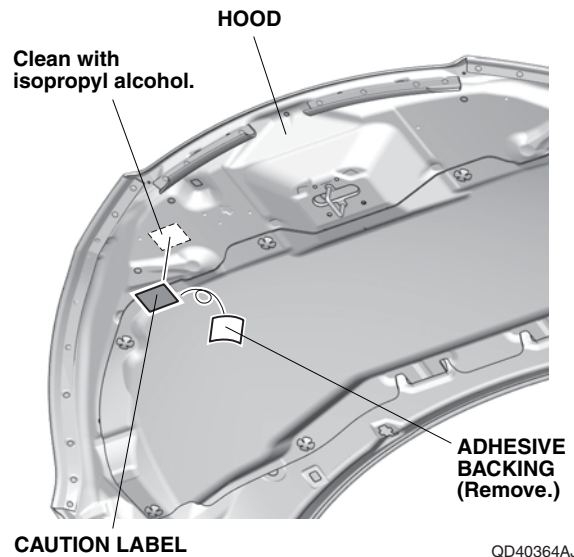

QD40364AJ

70. Remove the adhesive backing from the caution label, and attach the caution label to the hood as shown.

71. Check that all wire harnesses are routed properly and all connectors are plugged in.
72. Check the overlap between the headliner and the driver's A-pillar trim. Refer to the Service Manual. If necessary, adjust the overlap.
73. Reinstall all removed parts.
74. Connect the negative cable to the battery.
75. Press and hold the audio power button for two seconds to restore the audio and navi (if equipped) system functions.
76. Reset the clock.
77. Restore the systems back to normal operation as described in the Service Manual if necessary.
78. Perform the "REMOTE ENGINE STARTER REGISTRATION" and the "CHECK THE OPERATION OF THE REMOTE CONTROL ENGINE STARTER."

REMOTE ENGINE STARTER REGISTRATION

NOTE: Register after making sure the HDS has been upgraded to the latest version as described in the Service News.

1. Acquire the PCM Code from the Interactive Network.

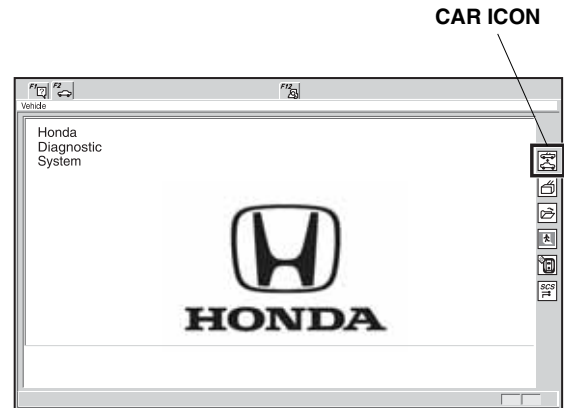

QC31909AC

2. Connect the HDS/MVCI tester to the OBD II data link connector, then turn the engine switch to ON.
3. Start the HDS, and click the car icon.
4. Input the VIN and other required information into the HDS, then click the check button.

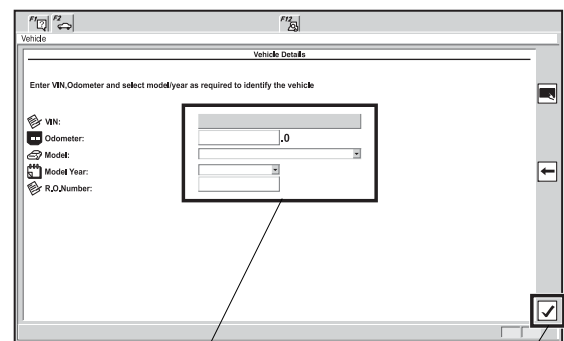

Input the VIN and other required information.

CHECK BUTTON

QB32102BH

5. Select **Honda Systems**, then click the check button.

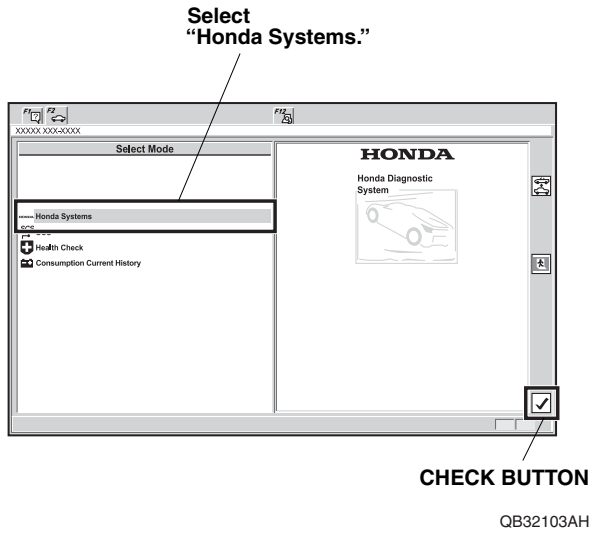

6. Select **R/C ENG STARTER** and click the check button.

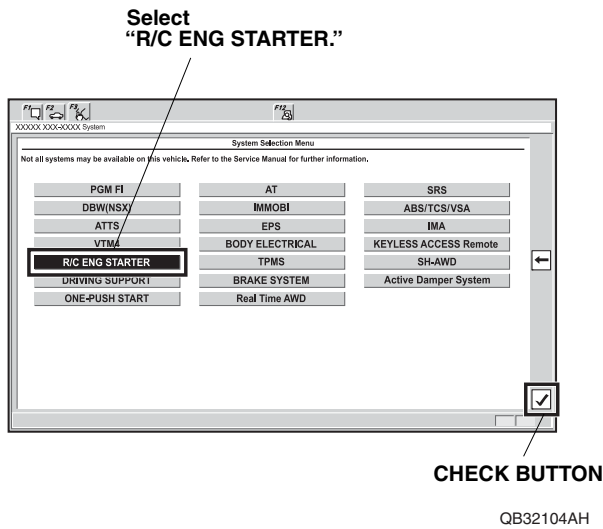

7. Select **REGISTER REMOTE CONTROL ENGINE STARTER UNIT**, then click the check button.

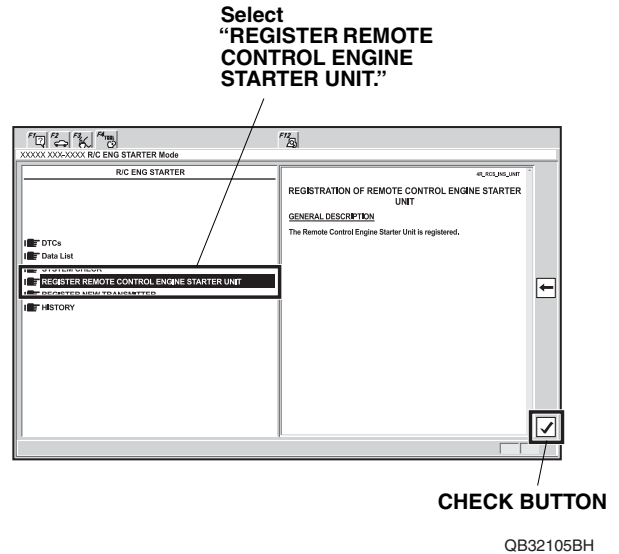

8. The following message will display: **Obtain PCM-code (IMMOBILIZER PCM CODE) from IN.** This vehicle's VIN will be required to obtain the password. (USA) Click the check button.

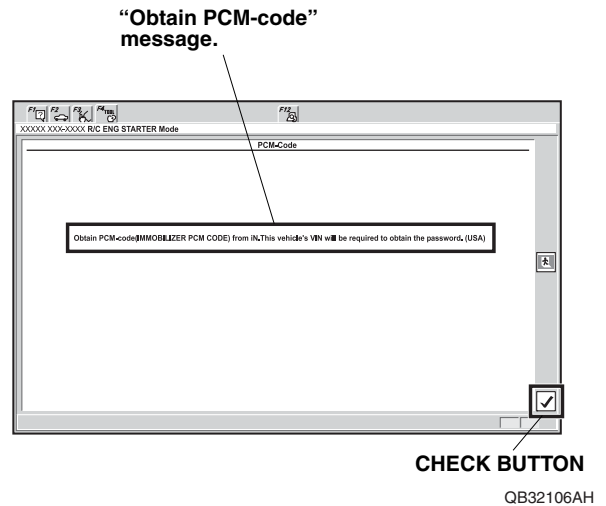

9. Input the PCM-code, then click the check button.
 NOTE: To ensure security, the PCM-code (password) is changed everyday, so it is impossible to register the remote control engine starter if the dates of the PCM-code acquisition and registration are different. The date of the HDS/MVCI tester should also be the same.

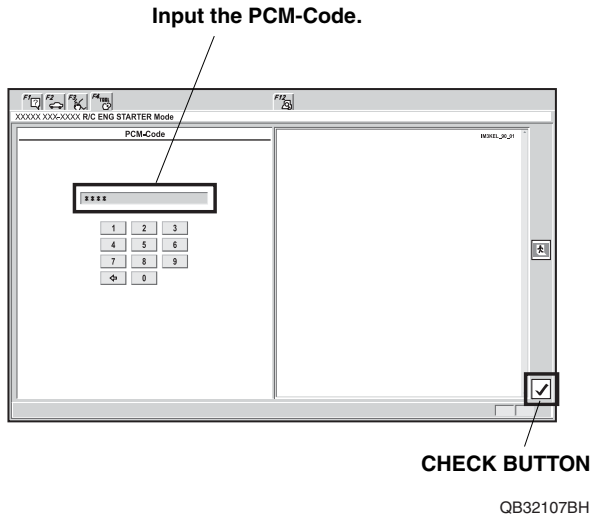

10. The following message will display: **The registration of the Remote Control Engine Starter Unit has been completed.** Turn the engine switch to OFF.

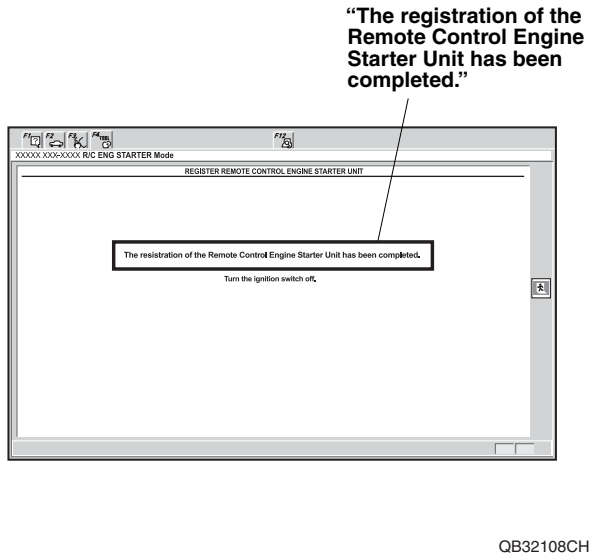

11. The following message will display: **Check that engine can be started by the Transmitter.** Click the check button.

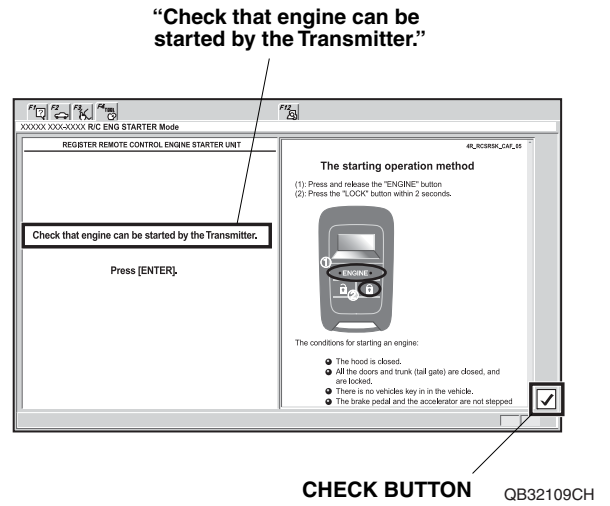

12. Perform the CHECK THE OPERATION OF THE REMOTE CONTROL ENGINE STARTER on page 26. Clear the DTCs, then disconnect the HDS/MVCI.

CHECK THE OPERATION OF THE REMOTE CONTROL ENGINE STARTER

Operating Conditions

- The hood is closed.
- The shift lever is in park.
- Turn the engine switch to OFF and the key is outside the vehicle.
- All doors and tailgate are closed and locked.

Inspection

1. Press the engine/command button on the transmitter and release, within 2 seconds, press the lock/start button on the transmitter.

The engine should start if all operating conditions are met.

Does the engine start?

Yes - Operation is normal.
No:
<ul style="list-style-type: none"> • Make sure all "Operating Conditions" are met. • Check the engine starter harness connections. • Connect the HDS/MVCI and check for an indicated failure. (Refer to the appropriate Service Manual for details.)

2. Press the engine/command button on the transmitter and release, within 2 seconds, press the unlock/stop button. The engine should stop.

Does the engine stop?

Yes - Operation is normal.
No - Check the engine starter harness connections.

3. After the engine has stopped, start the engine again, and check that the engine stops after each of the following conditions:

NOTE: After each test the ignition key must be cycled, or the driver's door must be opened and closed.

- Move the shift lever out of the P position.
- Unlock or open the doors or the tailgate.
- Open the hood.
- Insert the key in the engine switch.
- Press on the brake pedal.

Does the engine stop after each of these tests?

Yes - Operation is normal.
No - Check the engine starter harness connections.

4. Check that the power windows do not function, and the shift lever does not move to any position when the engine is started with the transmitter.
5. Start the engine again, press the engine/command button on the transmitter two times, and check the vehicle condition on the display.
6. Check the operation of the transmitter when the vehicle is 120 m (400 ft.) away and in direct sight.

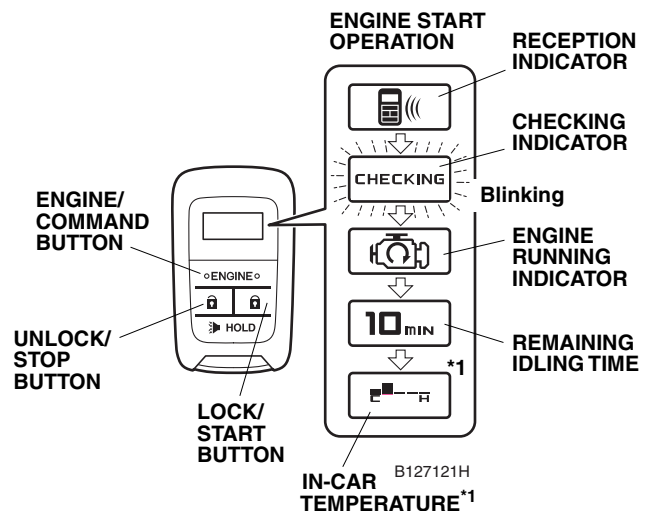

*1 Only on vehicles equipped with the automatic climate control. This indicator is displayed for some vehicles among them.

7. Press the unlock/stop button on the transmitter and verify that the doors unlock. Press the lock/start button, and verify that the doors lock.
8. Check that the engine can start by the vehicle key and that the wiper and the headlight can be operated normally.

