

PARTS LIST

Attachment Kit
P/N 08A44-9J1-810

Navi harness

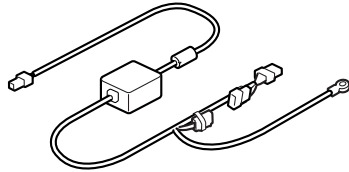

Base

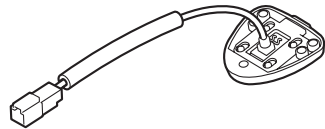

Template

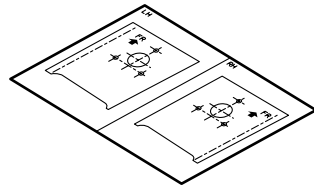

3 Washer screws, 3 x 20 mm

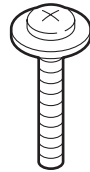

3 Nuts, 3 mm



3 Plain washers, 3 mm



3 Plain washers, 6 mm



Cap



8 Wire ties

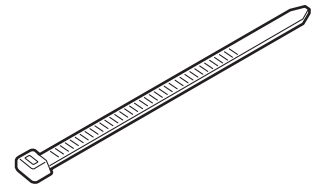

4 EPT sealers

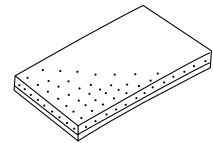

Rubber Seal

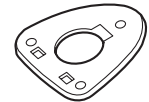

3 Collars



**Portable Navi Kit
P/N 08A44-9J1-000**

Navi unit

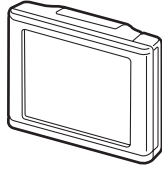

Cradle

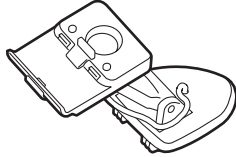

Carrying case

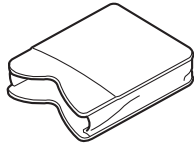

Wall charger

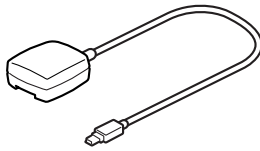

USB cable

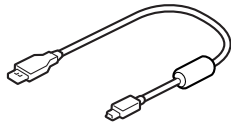

Quick Reference Guide

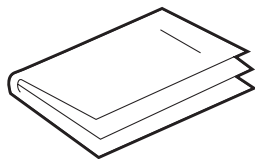

TOOLS AND SUPPLIES REQUIRED

Phillips screwdriver

Flat-tip screwdriver

10 mm socket

Scissors

Shop towel

Isopropyl alcohol

Drill

Drill bits (3 mm, 6 mm)

25 mm Hole saw

File

Eye protection

Scale

Pushpin

5.5 mm Open-end wrench

Utility Knife

Tape

Illustration of the Navigation System Installed on the Vehicle

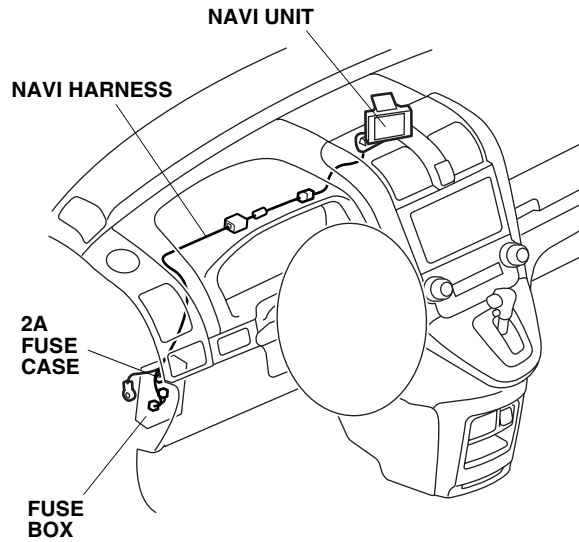

INSTALLATION

Customer Information: The information in this installation instruction is intended for use only by skilled technicians who have the proper tools, equipment, and training to correctly and safely add equipment to your vehicle. These procedures should not be attempted by “do-it-yourselfers.”

NOTE:

- Be careful not to damage the other finished surfaces of the body.
1. Make sure you have the anti-theft code for the radio, then write down the radio station presets.
 2. Disconnect the negative cable from the battery.
 3. Attach the tape to the center upper cover as shown.

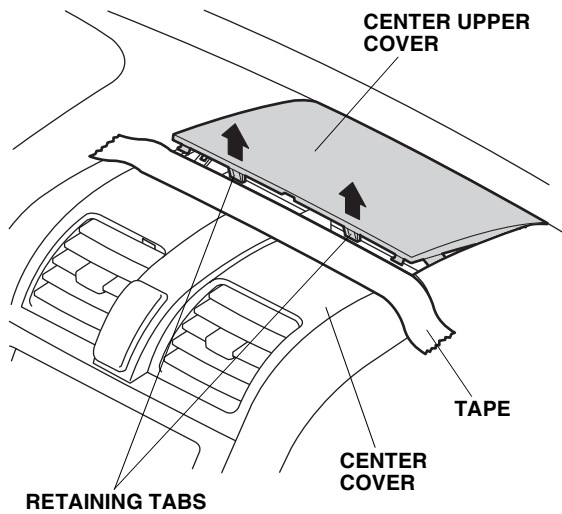

4. Using a flat-tip screwdriver, release the two retaining tabs from the center upper cover.

5. Remove the center upper cover (four clips).

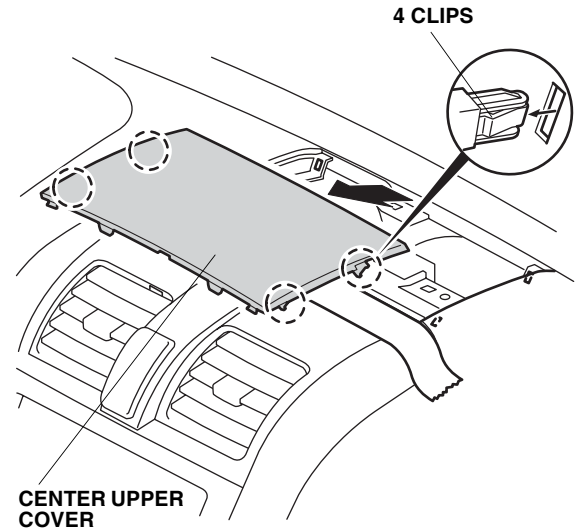

6. Remove the dashboard center vent (five clips and disconnect the vehicle connector).

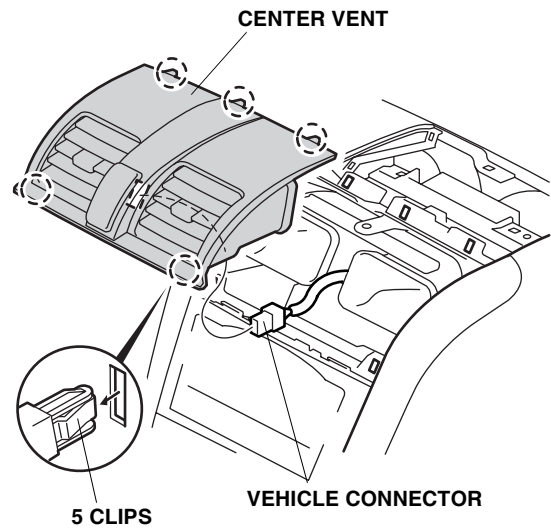

7. Remove the meter panel (eight clips).

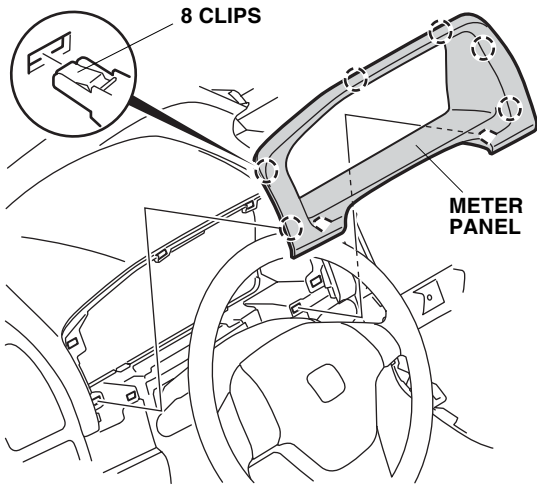

8. Remove the meter panel by removing the three self-tapping screws. Slide the meter to the left and disconnect the two vehicle connectors. Keep the meter in the upright position.

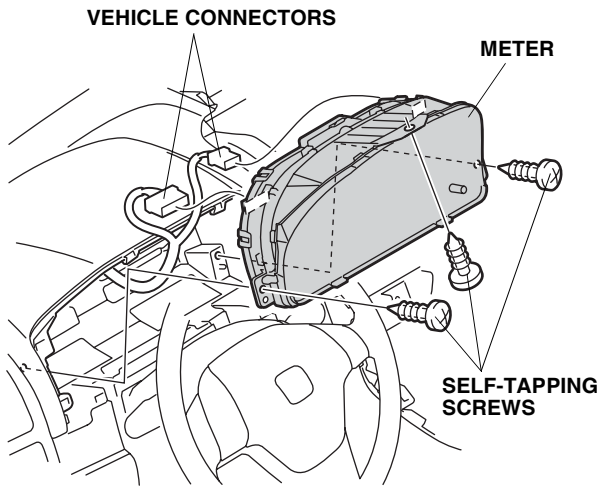

9. Turn the knob of the driver's dashboard under cover. Remove the driver's dashboard under cover (one clip and pin).

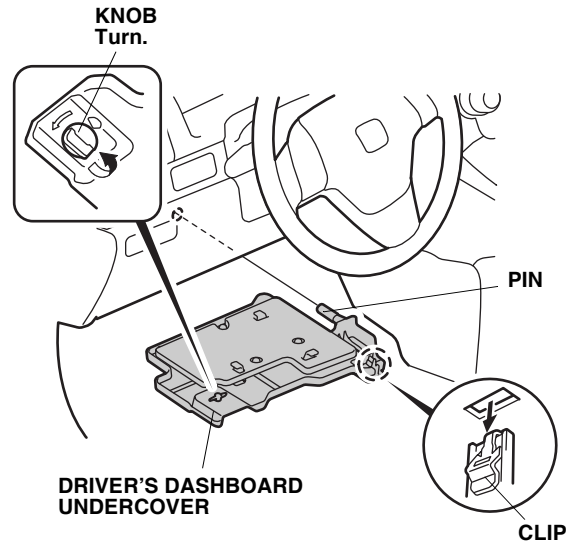

10. Remove the driver's dashboard lower cover (seven clips).

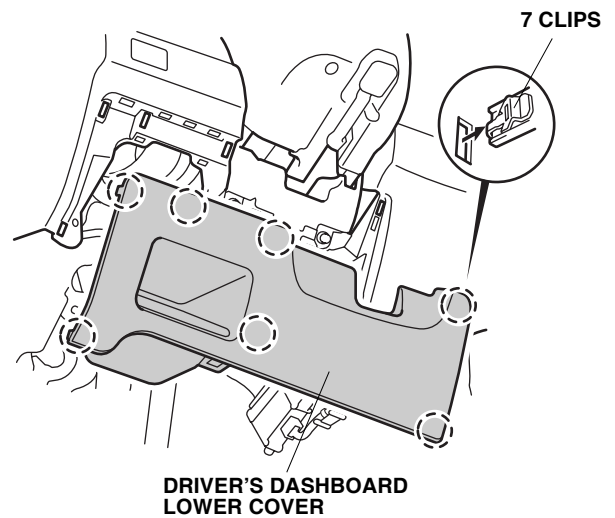

11. Remove the left front door sill trim (three clips).

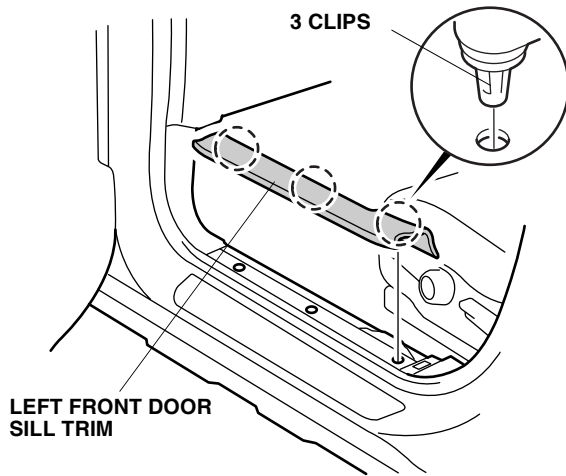

12. Pull away the weatherstrip around the driver's door kick panel.

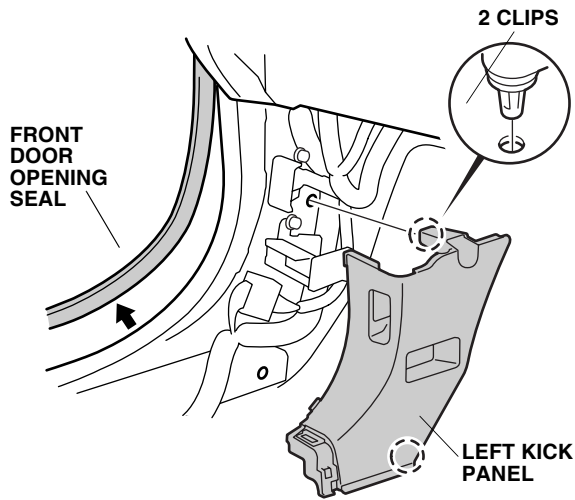

13. Remove the left kick panel (two clips).

14. Wrap one EPT sealer around the converter on the navi harness.

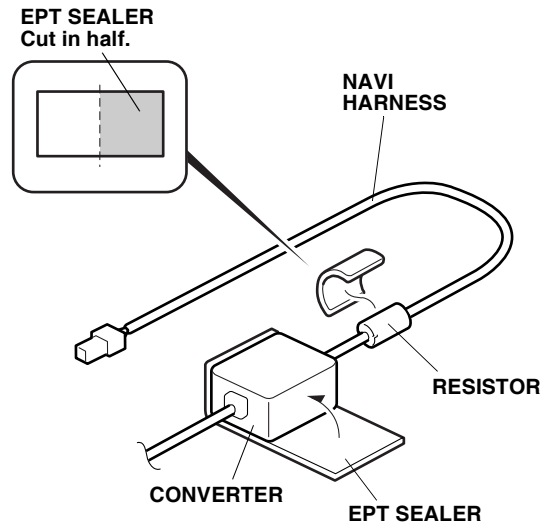

15. Using scissors, cut one EPT sealer in half. Wrap half of an EPT sealer to the resistor on the navi harness.
16. Route the ground wire end of the navi harness from the meter opening towards the fuse box.

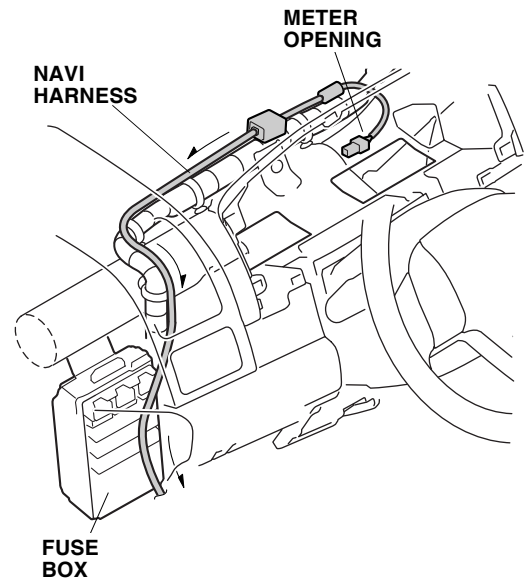

17. Plug the navi harness 6-pin connector into the fuse box.

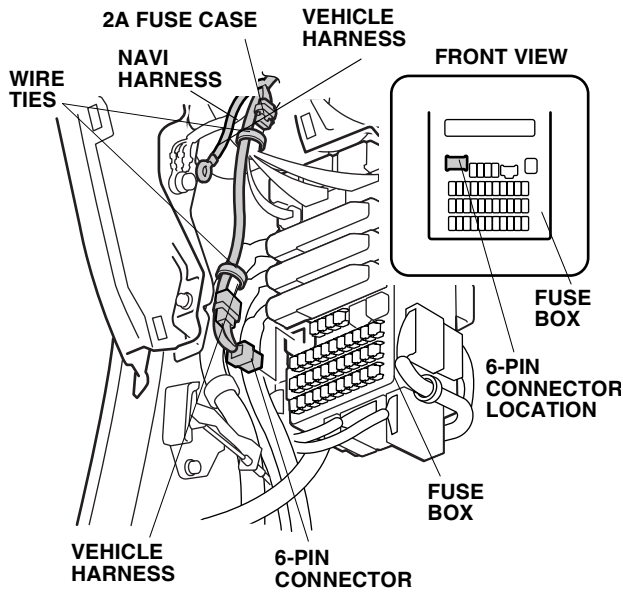

18. Secure the navi harness to the vehicle harness with two wire ties.

If another harness is already connected to the fuse box, disconnect it from the fuse box, and connect it to the navi harness 6-pin connector (remove the dummy connector from the navi harness 6-pin connector). Then, connect the navi harness 6-pin connector to the fuse box as shown

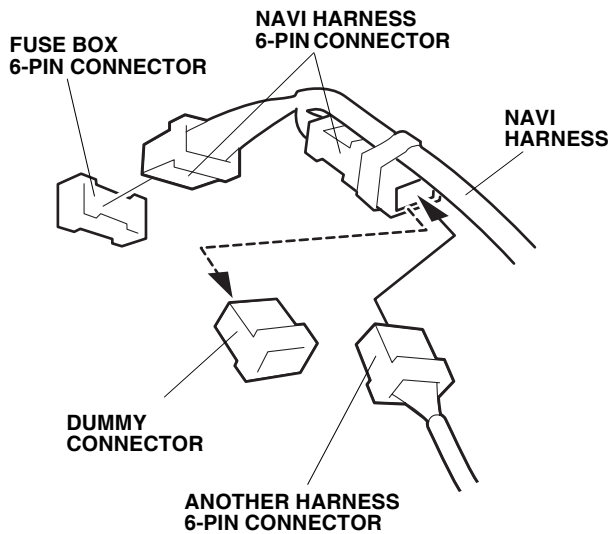

19. Remove the vehicle ground bolt, and install the navi harness ground terminal using this bolt.

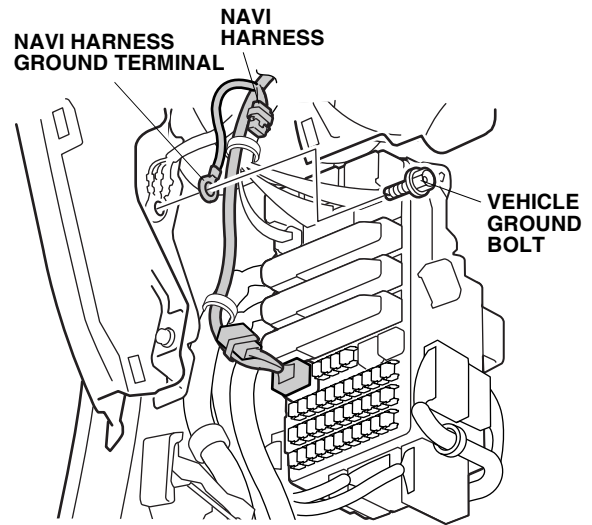

20. At the meter opening, secure the navi harness to the vehicle harness with two wire ties.

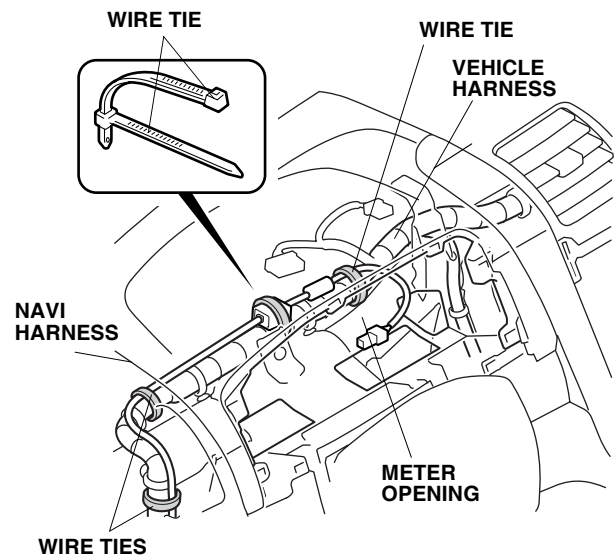

21. Secure the converter section of the navi harness to the vehicle harness with two wire ties connected together.
22. Secure the navi harness to the vehicle harness with one wire tie.

23. Using the utility knife, remove the vehicle sealer from the center vent as shown.

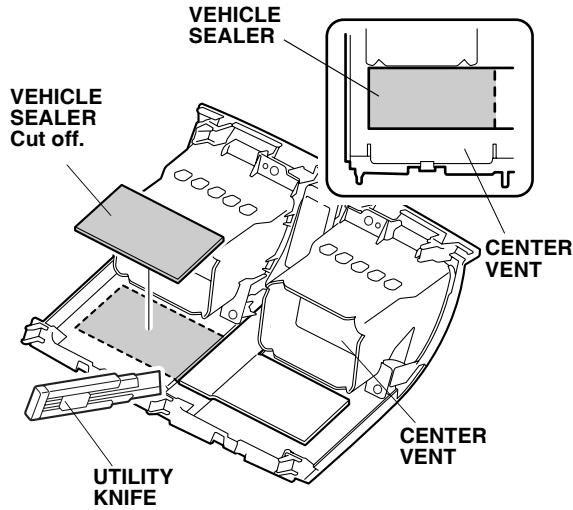

24. Using scissors, cut out the template (LH) as shown.

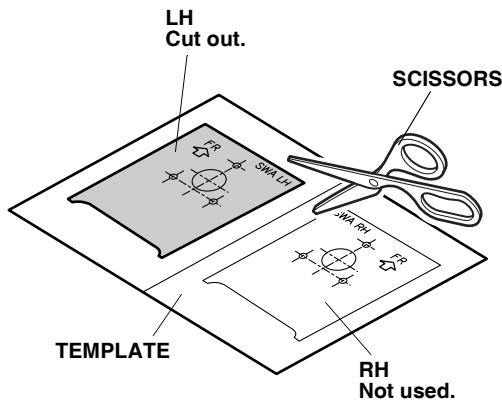

25. Tape the template to the center vent as shown.

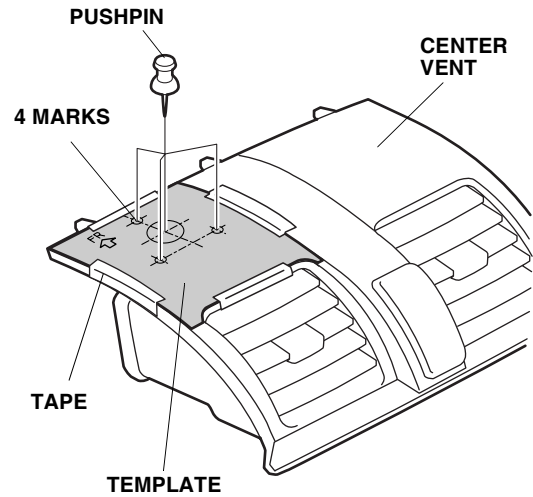

26. Using a pushpin, pierce the template at the four marks on the template. Remove the template.
 27. While wearing eye protection, drill the three outer holes to 6 mm. First drill with a 3 mm drill bit, and then finish with a 6 mm drill bit. Remove any burrs.

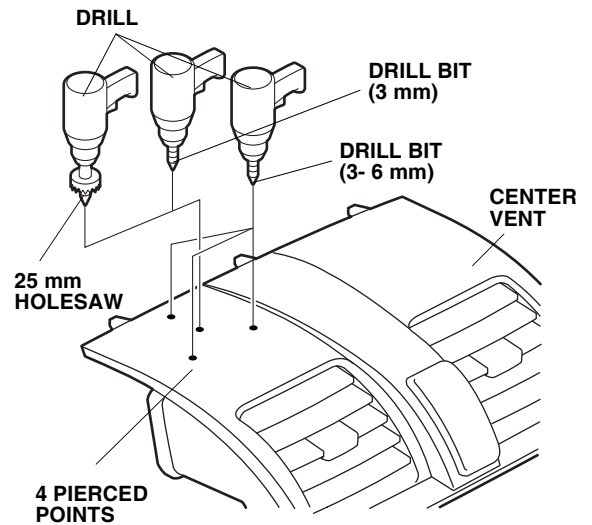

28. While wearing eye protection, drill the center hole to 25 mm. First drill with a 3 mm drill bit, and then finish with a 25 mm holesaw. Remove any burrs. Only enlarge the center hole to 25 mm.

29. Using scissors, cut one EPT sealer in half. Attach half of an EPT sealer to the 2-pin connector of the base.

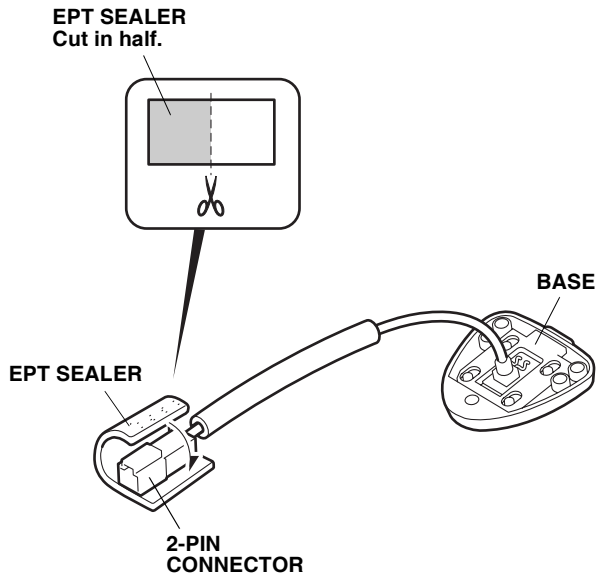

30. Route the 2-pin connector from the base through the rubber seal and into the 25 mm hole in the center vent. Note the direction of the rubber.

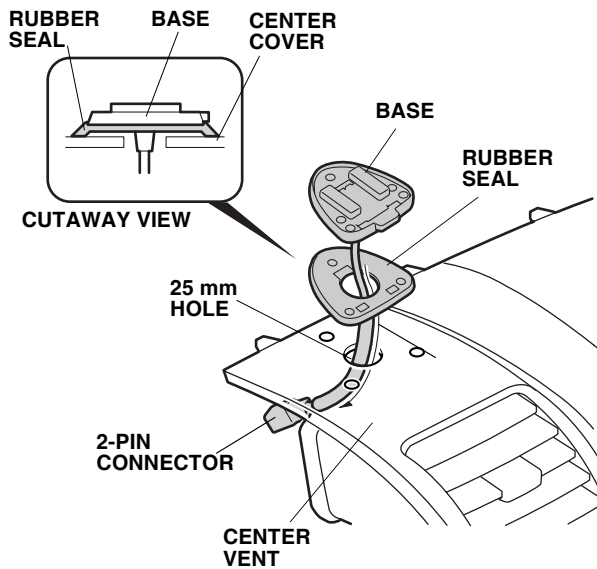

31. Secure the base with rubber seal to the center cover with three 3 x 20 mm washer screws, collars, 6 mm plain washers, 3 mm plain washers, 3 mm nuts, and 3 mm nuts.

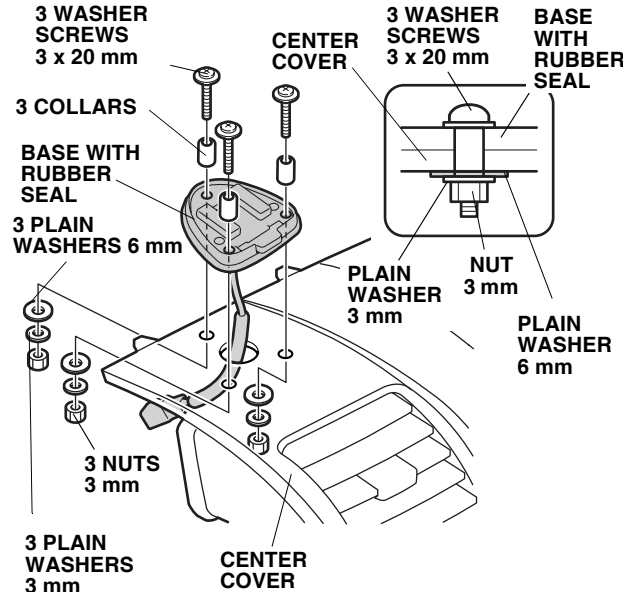

32. Using isopropyl alcohol on a shop towel, clean the inside of the center vent where the EPT sealer will attach.

33. Get one EPT sealer, and cut a slit on one side at 50 mm. Attach the EPT sealer to the back of the center vent with the harness through the slit in the EPT sealer.

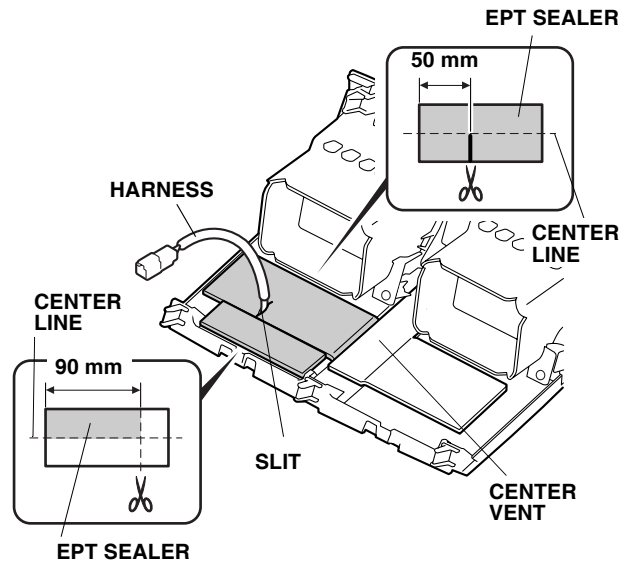

34. Using scissors, cut one EPT sealer in half, then cut a 90 mm piece from one of the halves. Attach the 90 mm piece of EPT sealer to the center vent in the area shown.

35. Route the base harness between the left side duct and the instrument panel, and towards the meter panel area. Plug in the vehicle connector, and reinstall the center vent.

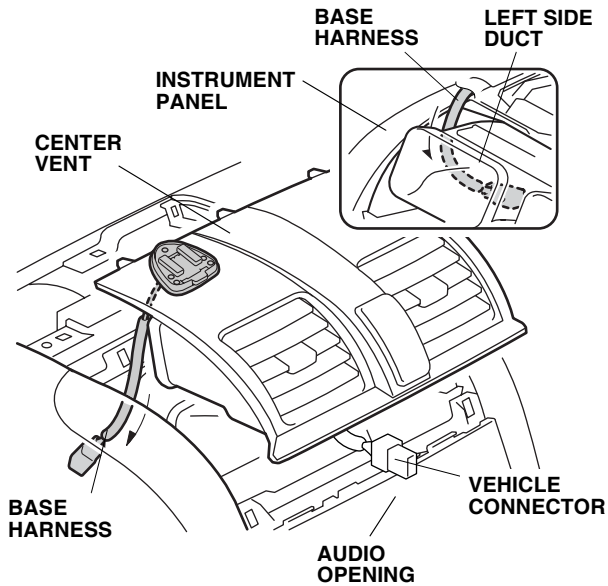

36. At the meter opening, plug the navi harness 2-pin connector into the base harness 2-pin connector. Secure the 2-pin connectors to the vehicle harness with one wire tie.

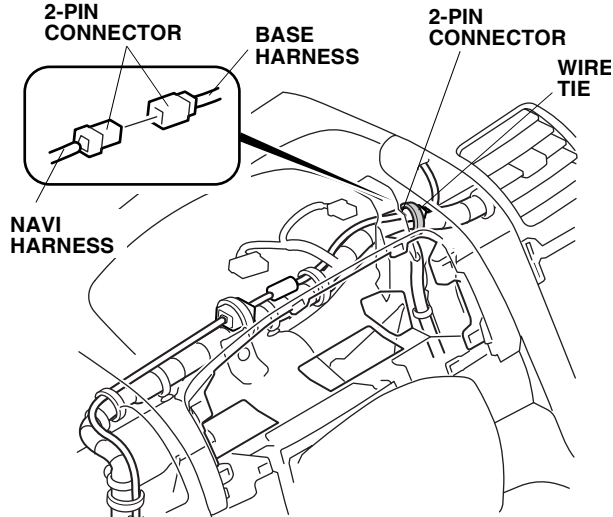

37. Place the cradle on the base (three retaining tabs).

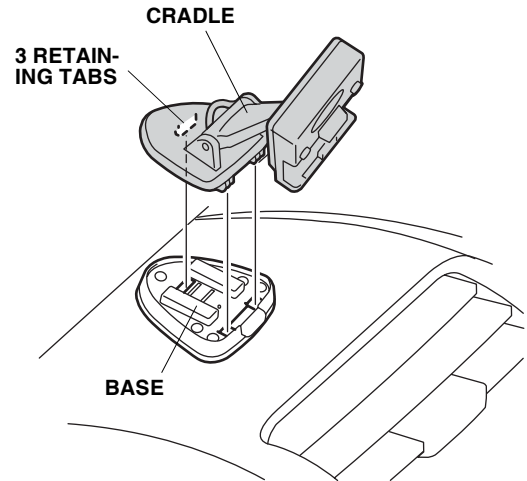

38. Open the antenna of the navi unit, and fit the bottom of the navigation unit into the cradle (terminal and one retaining tab). Tilt back and snap into place.

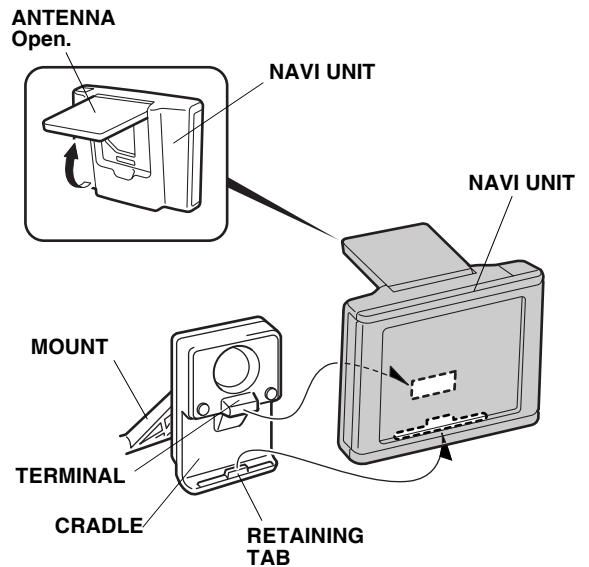

39. Check that all wire harnesses are routed properly and all connectors are plugged in.
40. Connect the negative cable to the battery and check operation of all lights and other electrical accessories.
41. Check the operation of the Honda Portable Navigation System according to the Quick Reference Guide.
42. Enter the anti-theft radio code and reset the clock and radio station presets.
43. Put the Honda Portable Navigation System Quick Reference Guide in the glove box.
44. Reinstall all removed parts.