



# INSTALLATION INSTRUCTIONS

Accessory

SECURITY SYSTEM  
HOOD SWITCH  
P/N 08E49-SDA-100

Application

2003 ACCORD  
2- AND 4-DOOR

Publications No.

All 24394

Issue Date

AUG 2002

## PARTS LIST

Hood switch harness

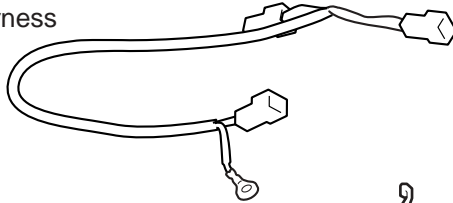

Hood switch

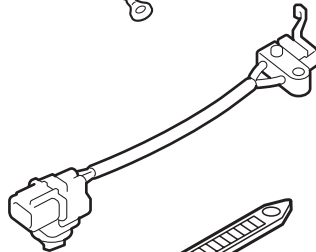

14 Wire ties

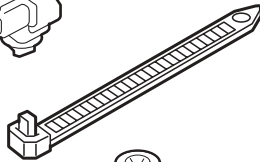

Ground bolt

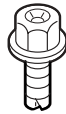

Washer-screw



Big washer



Small washer



Nut



## TOOL AND SUPPLIES REQUIRED

#2 Phillips screwdriver

Small flat-tip screwdriver

Felt-tip pen

6 mm, 10 mm Combination wrench

6 mm, 10 mm Socket

Ratchet

Torx wrench

Long nose pliers

Diagonal cutters

## Illustration of the Hood Switch Installed on the Car

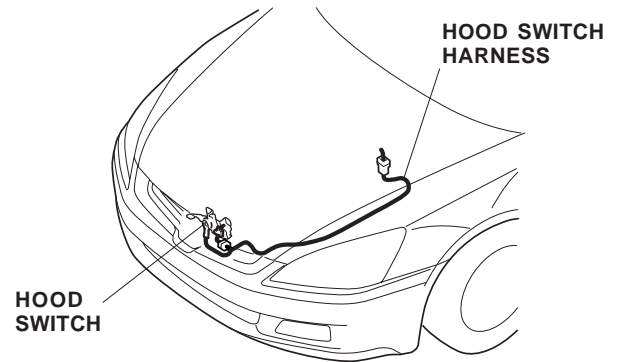

## INSTALLATION

**Customer Information:** The information in this installation instruction is intended for use only by skilled technicians who have the proper tools, equipment, and training to correctly and safely add equipment to your car. These procedures should not be attempted by "do-it-yourselfers."

1. Make sure you have the anti-theft code for the radio, then write down the frequencies for the preset buttons.
2. Disconnect the negative cable from the battery.

### Installing the Hood Switch

3. Open the hood. Remove the radiator cover (ten clips and four retaining tabs).

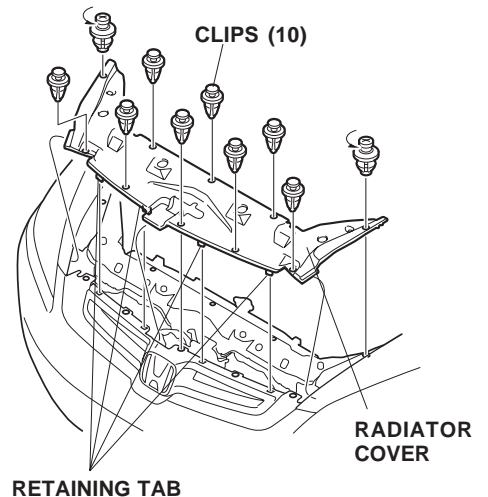

- Remove the hood latch cover (one clip).

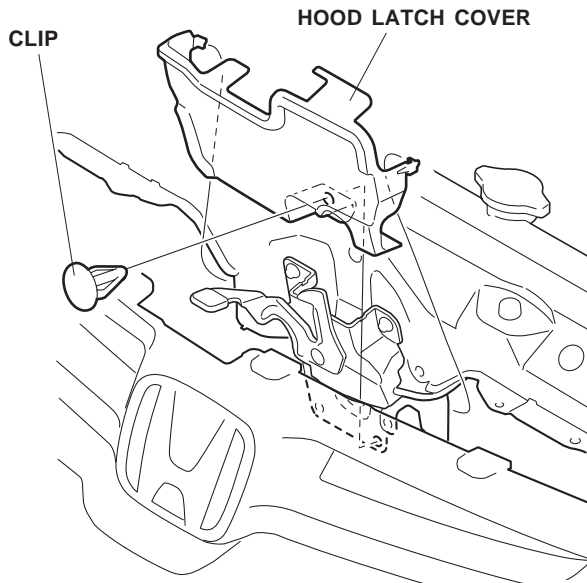

- Using a felt-tip pen, mark the location of the existing hood lock bracket at each corner.

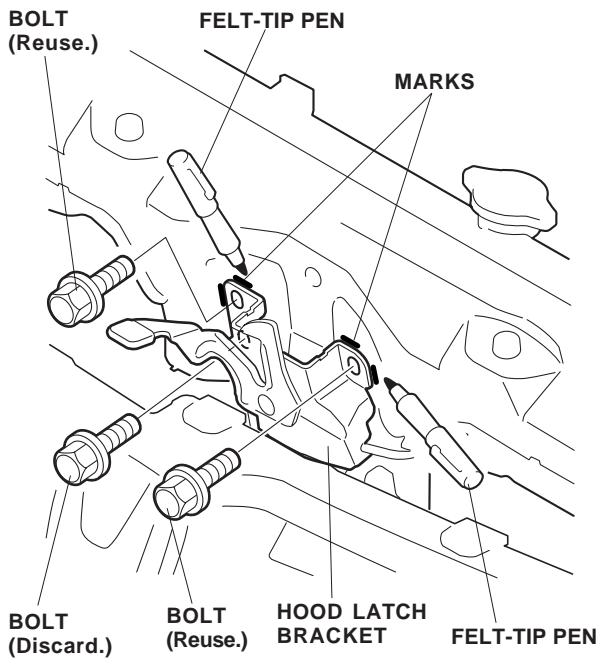

- Remove the hood latch bracket (three bolts). Discard the one lower bolt shown.

- Remove the spring, and disconnect the hood opener cable from the hood latch bracket.

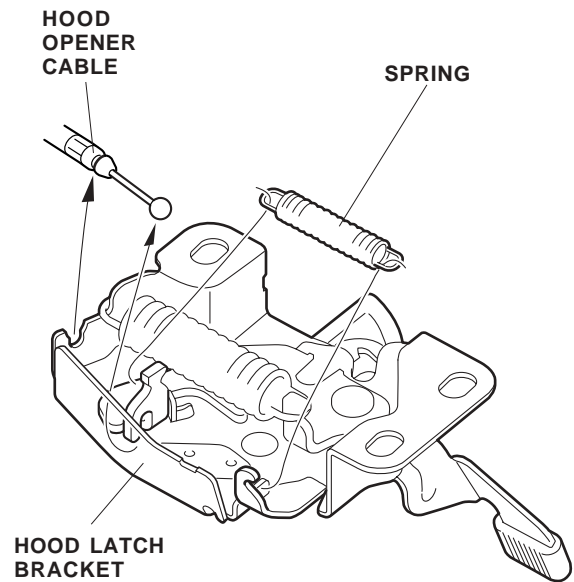

- Install the hood switch to the hood latch bracket with the washer-screw, small washer and nut supplied.

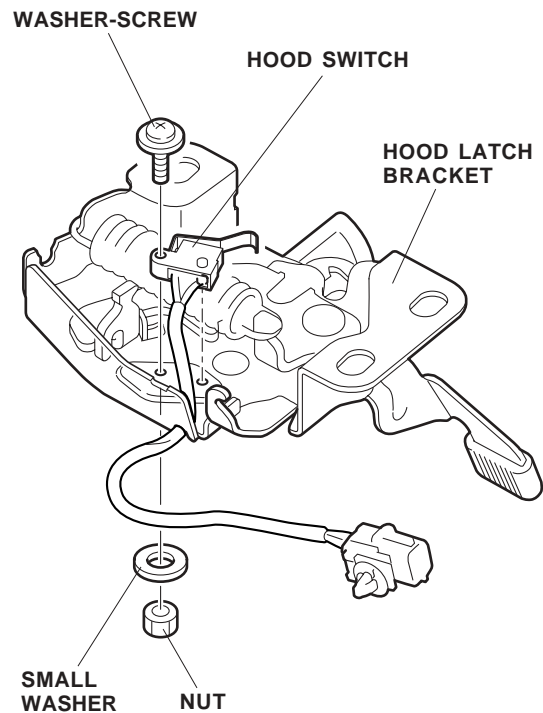

## Routing the Hood Switch Harness

9. Remove the air duct cover (two clips), and remove the air duct.

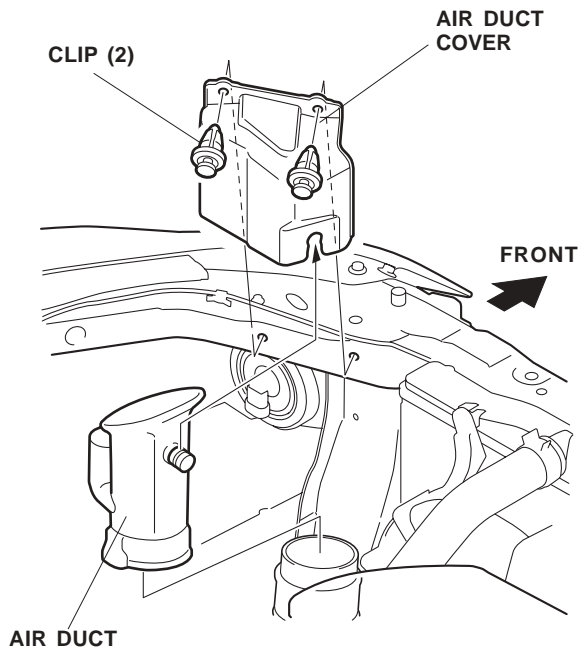

10. Remove the relay box (two bolts), and remove the one bolt that fastens the air cleaner housing cover.

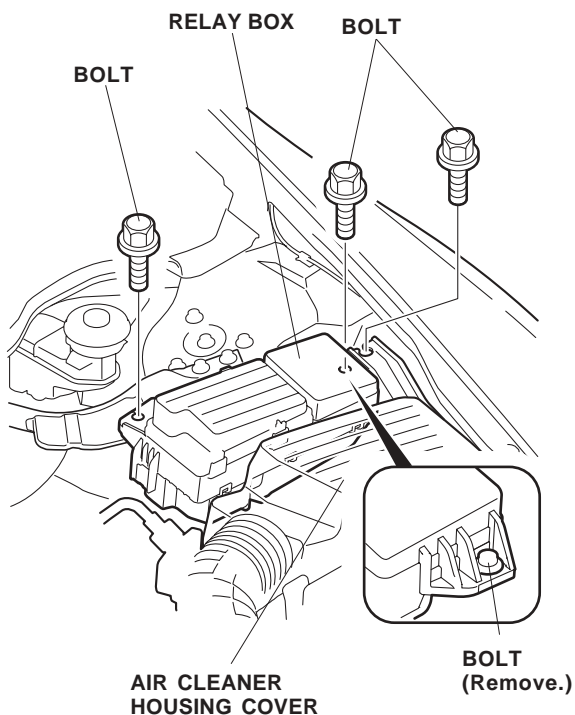

11. Route the hood switch harness 2-pin connector and ground terminal through the front bulkhead support to the left of the radiator and outside of the engine compartment along the vehicle harness as shown.

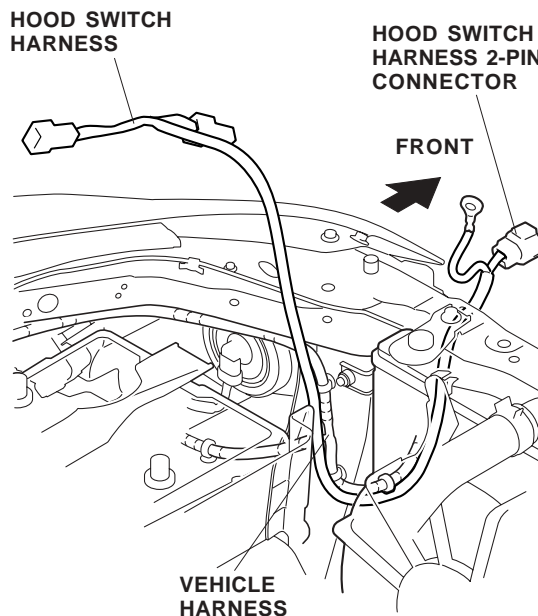

12. Lift the air cleaner housing cover up, and route the hood switch harness to the rear of the air cleaner housing cover along the vehicle harness.

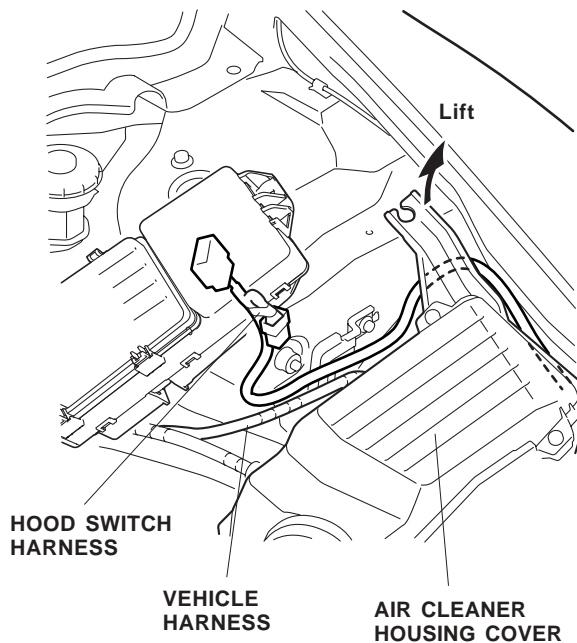

- Under the relay box, locate the vehicle 3-pin connector blue-taped to the vehicle harness, and remove the blue-tape to free the connector. Connect the hood switch harness 3-pin connector to the 3-pin connector you just freed. Secure the hood switch harness to the vehicle harness with the wire ties.

**A/T Model**

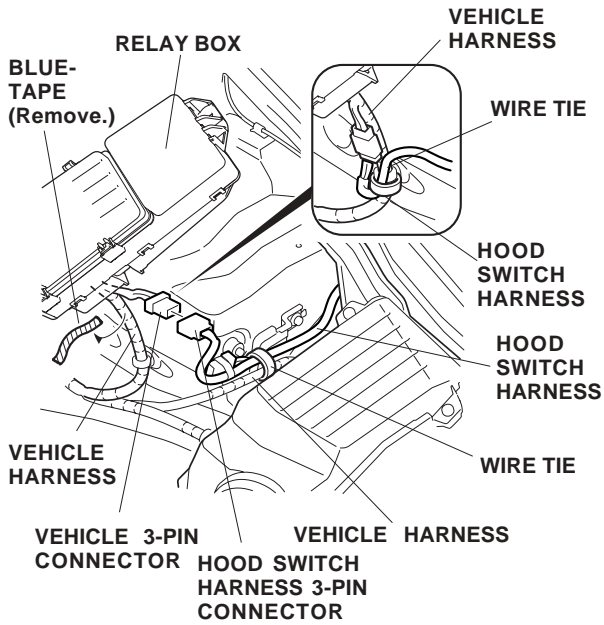

**M/T Model**

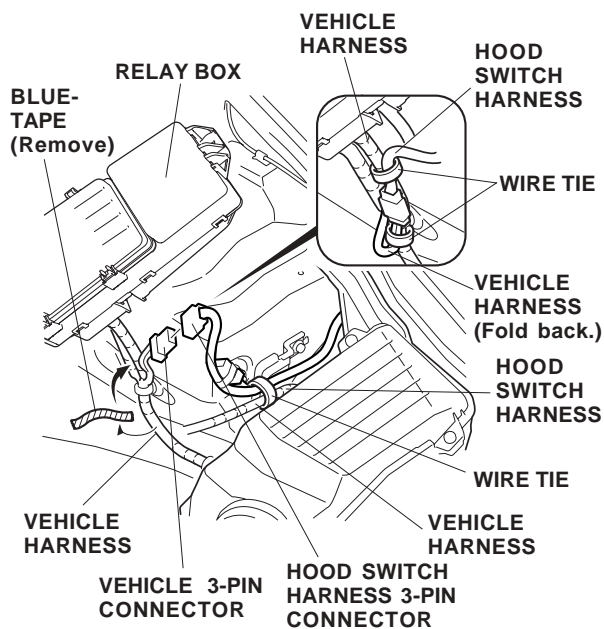

NOTE: If the 3-pin connector is already being used by another accessory, unplug the 3-pin connector. Locate the 3-pin connector taped to the harness. Remove the dummy connector from that harness. Plug the other accessory's harness 3-pin connector into the hood switch harness 3-pin connector. Secure the harness with one wire tie in the area shown.

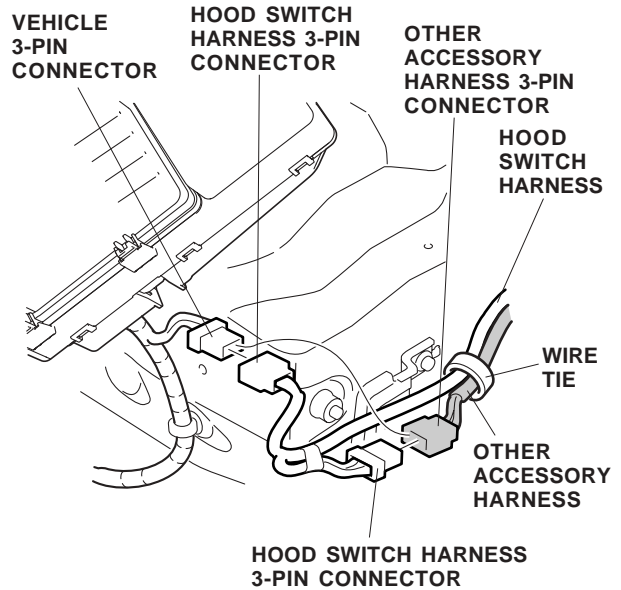

- Route the hood switch harness along the vehicle harness, and secure it to the vehicle harness with five wire ties in the areas shown.

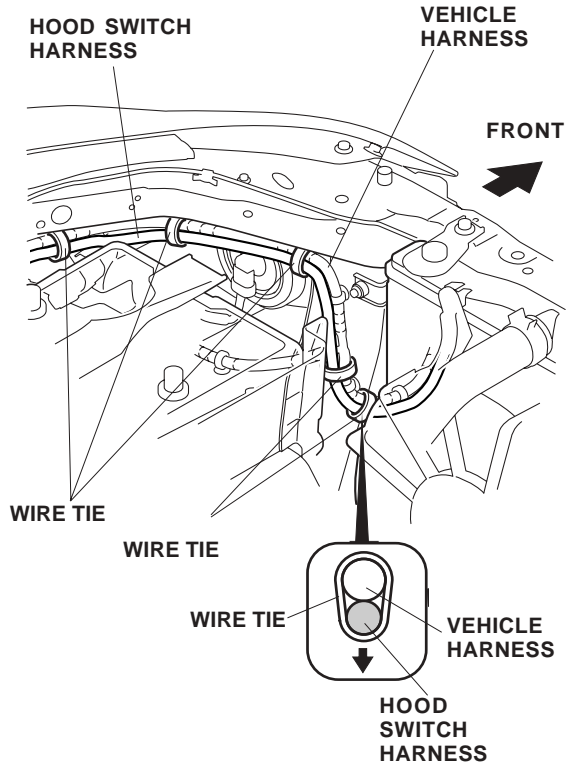

16. Reinstall the hood opener cable and the spring on the hood latch bracket.

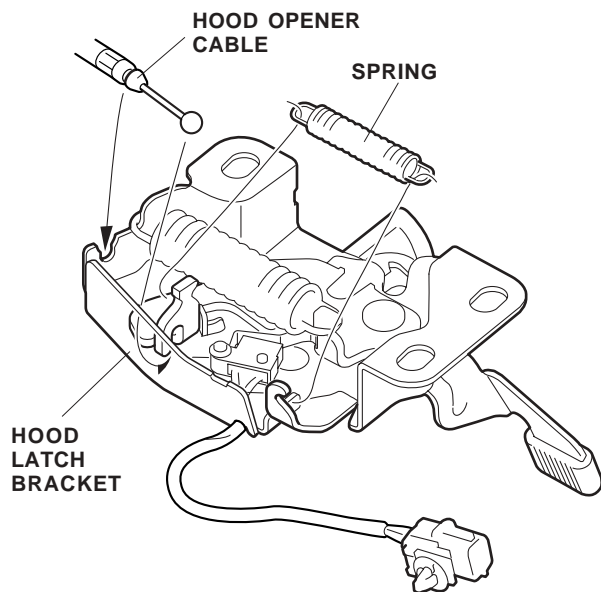

17. Position the hood lock on the center support at the position you marked in step 5. Loosely install the two bolts, and install the hood switch harness ground terminal with the big washer and ground bolt from kit.

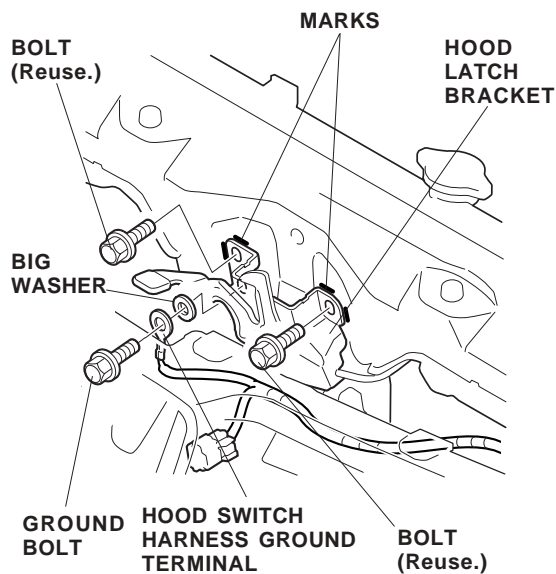

18. Shut the hood, and check that the alignment of the hood lock and the hood latch is correct, and check that the hood is latched securely. When you're satisfied with the results, open the hood, and tighten the hood latch bolts securely.

19. Route the hood switch harness 2-pin connector along the vehicle harness. Plug the hood switch harness 2-pin connector into the hood switch 2-pin connector.

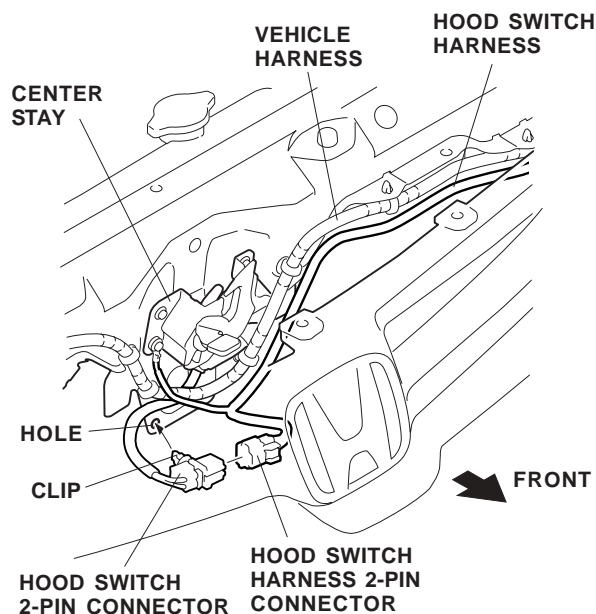

20. Push the hood switch clip into the hole in the center stay.

21. Secure the hood switch harness to the vehicle harness with six wire ties in the areas shown.

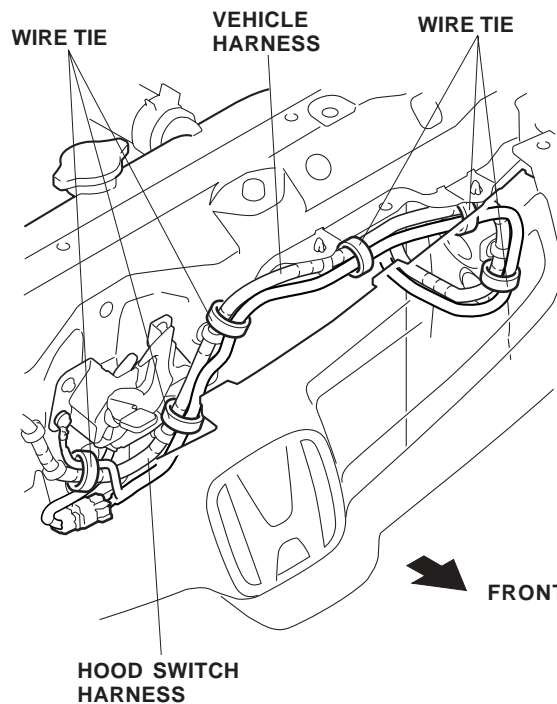

22. Check that all wire harnesses are routed properly and all connectors are plugged in.
23. Reinstall all removed parts.
24. Reconnect the negative cable to the battery.
25. Enter the customer's radio anti-theft code, and reset the radio station presets.
26. Reset the clock.

NOTE: Whenever the battery is disconnected, the driver's window AUTO function is disabled.

27. Start the engine. Push down on the driver's window switch until the window is fully open.
28. Pull up on the driver's window switch to close the window completely, then hold the switch for a second or two more.
29. Test the driver's window AUTO function.